

COUNTY OF LEICESTER
PARISH OF SYSTON



C O U N T Y O F L E I C E S T E R

P A R I S H O F S Y S T O N

P A R I S H O F Q U E N B O R O U G H

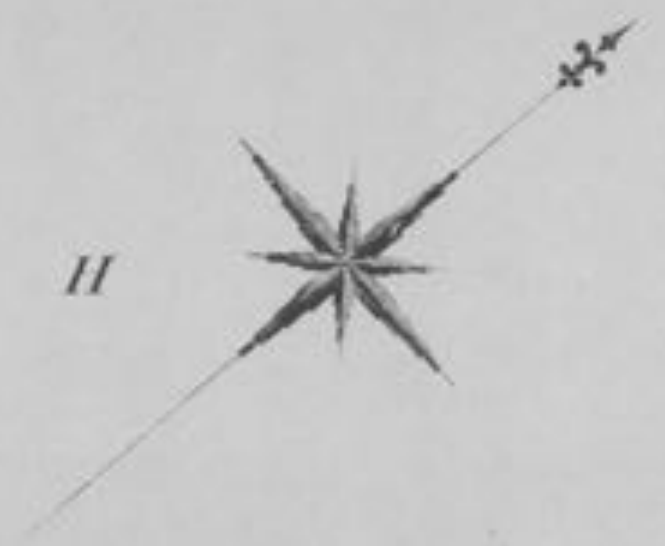

P A R I S H
O F E A S T
G O S C O T E

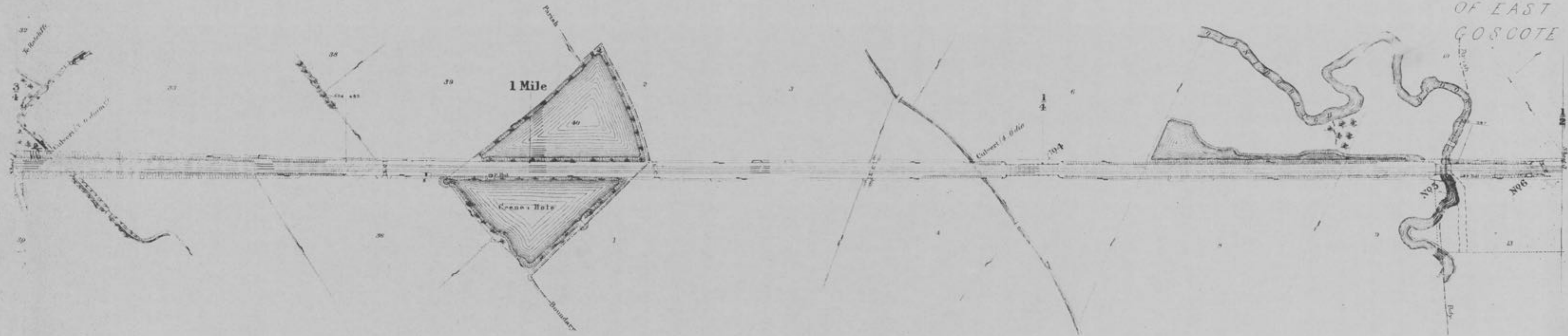

Scale. 2 Chains to an Inch.

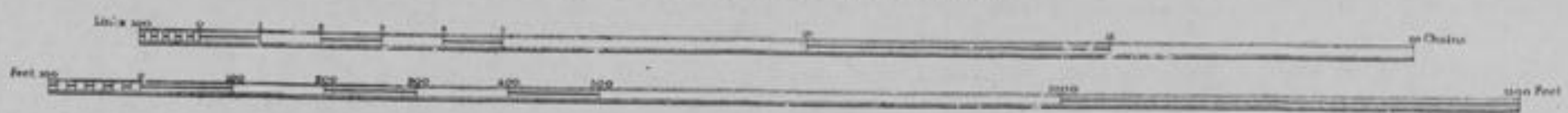

Dot 4

COUNTY OF LEICESTER

PARISH OF QUENIBOROUGH

PARISH OF

EAST GOSCOTE

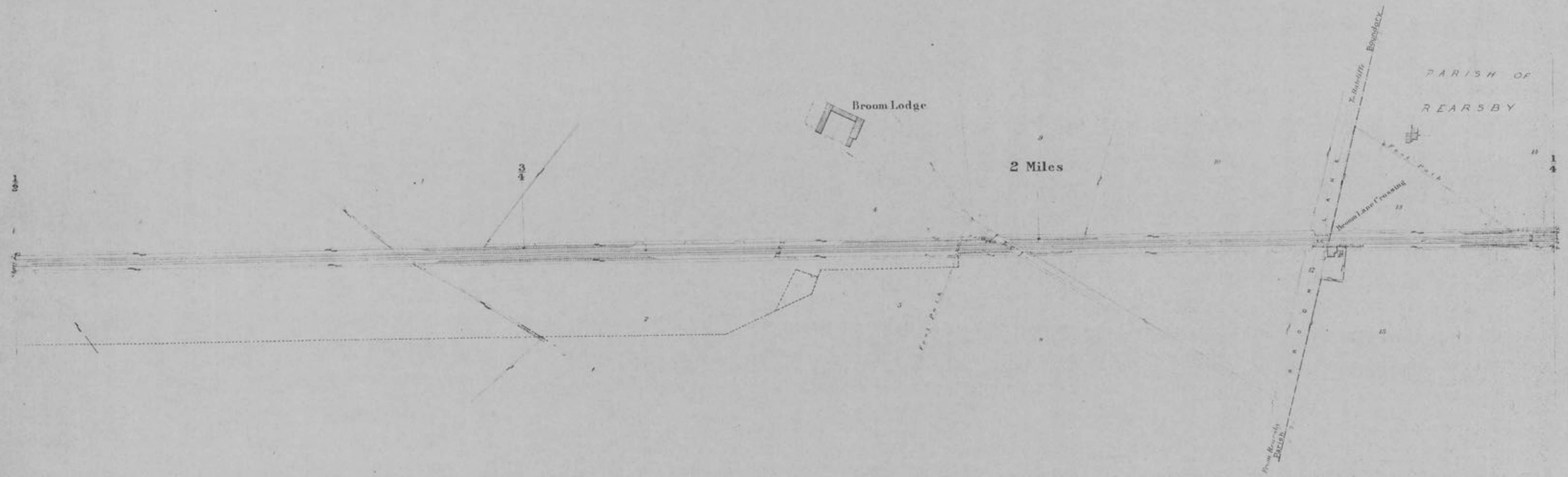
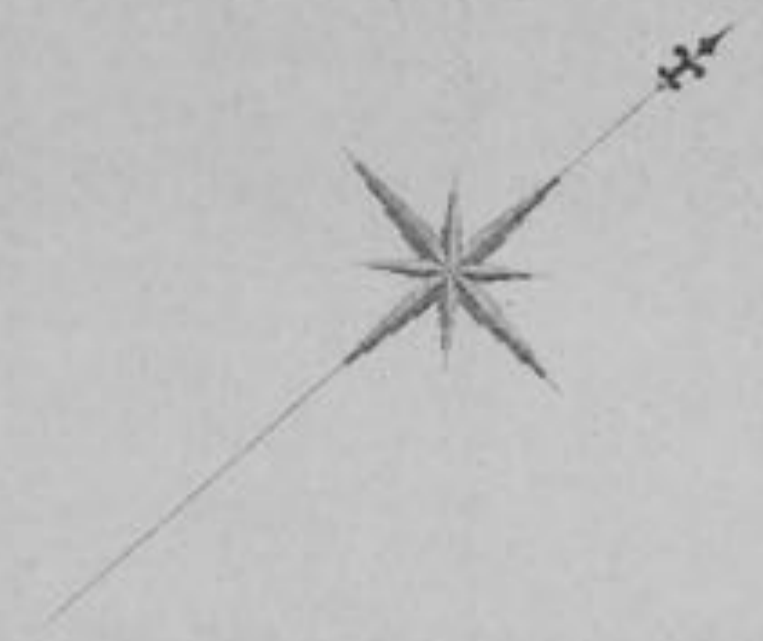

Scale. 2 Chains to an Inch.

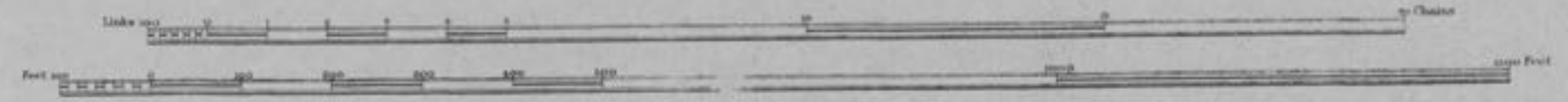

PARISH OF REARBY

C O U N T Y O F L E I C E S T E R

P A R I S H O F R E A R S B Y



AGNES WILLIAMSON AND MARY KILBY

J. W. SIMPSON



Scale. 2 Chains to an Inch.



C O U N T Y O F L E I C E S T E R

P A R I S H O F R E A R S B Y

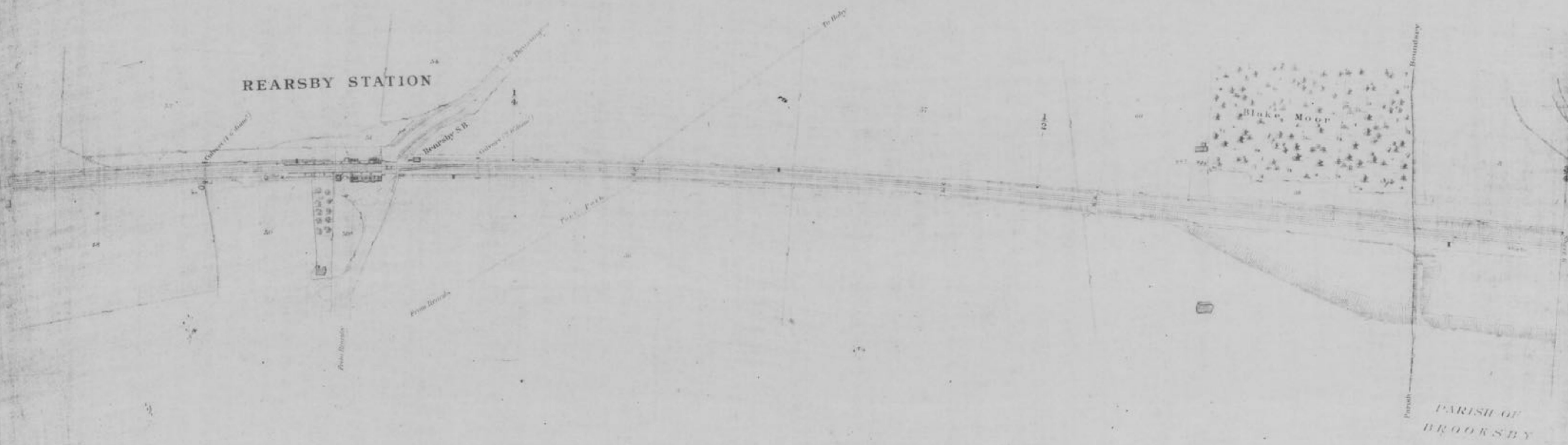

Scale. 2 Chains to an Inch.

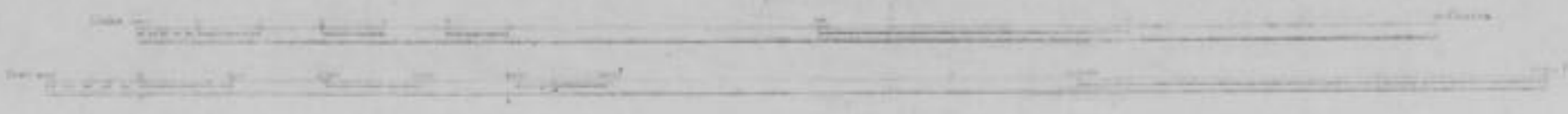

Edwin Smith Esq.
Mellish & Co.
Surveyors

C O U N T Y O F L E I C E S T E R

SHEET 674

P A R I S H O F T H R U S S I N G T O N



TREES OF LADY MACDONALD & LADY CECILIA PAGET

W. CHARLTON & OTHERS

MRS ARNALL & OTHERS

TREES OF LADY MACDONALD AND LADY CECILIA PAGET

4 Miles

R I T K H W R E A R

J. E. BANNISTER & ANOTHER

P A R I S H O F B R O O K S B Y

Scale. 2' Chains to an Inch.

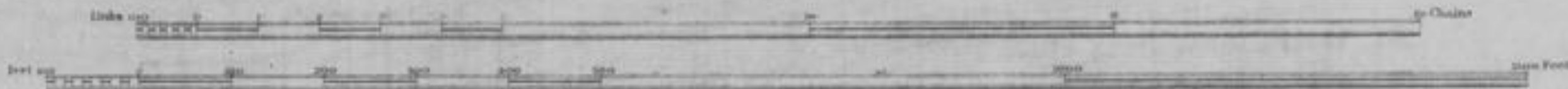

Estate Agents Office
Midland Railway
Derby

C O U N T Y O F L E I C E S T E R

P A R I S H O F H O B Y



REVP G. BERESFORD (1884)

R. LANGFORD & OTHERS (1887)

LORD SCARSDALE & OTHERS (1894)

C. NEEDHAM & M^{RS} E. (1881)

As to drains from A to B See Agt with E. A. Beresford dated 15th October 1862

TRUNK OF LANGFORD WILSON (1882)

5 Miles

BROOKSBY STATION

R I V E R W E R K

TRUSS OF LADY MACDONALD & LADY CECILIA PAGET (1871)

B. C. PIERCE SEAMAN

P A R I S H O F B R O O K S B Y

P A R I S H O F R O T H E R B Y

Scale, 2 Chains to an Inch.

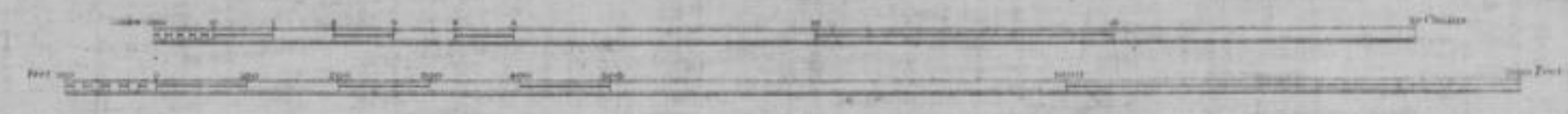

COUNTY OF LEICESTER

PARISH OF ROTHERBY

PARISH OF HOBBY

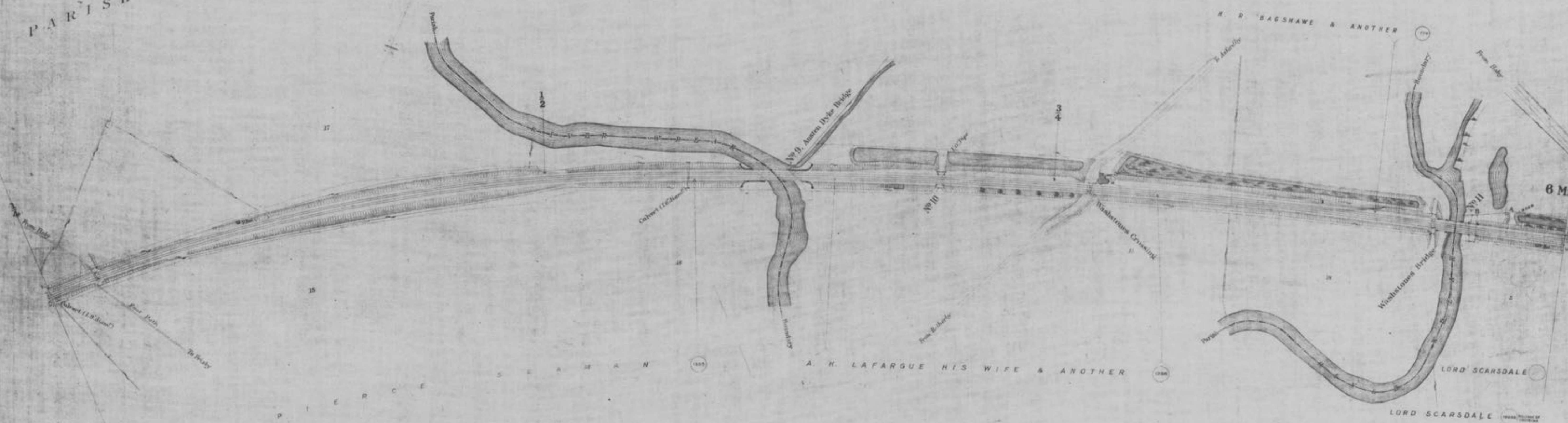

6 Miles

PARISH OF FRISBY ON THE WREAK

Scale, 2 Chains to an Inch.

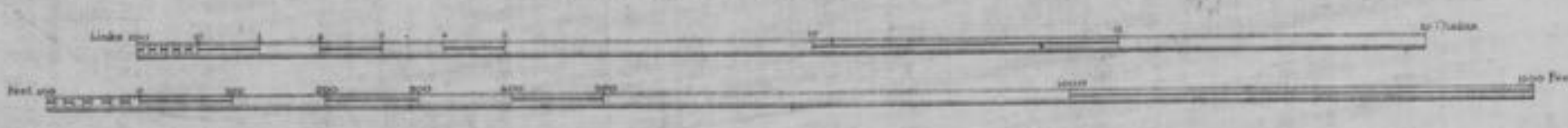

C O U N T Y O F L E I C E S T E R

P A R I S H O F A S F O R D B Y

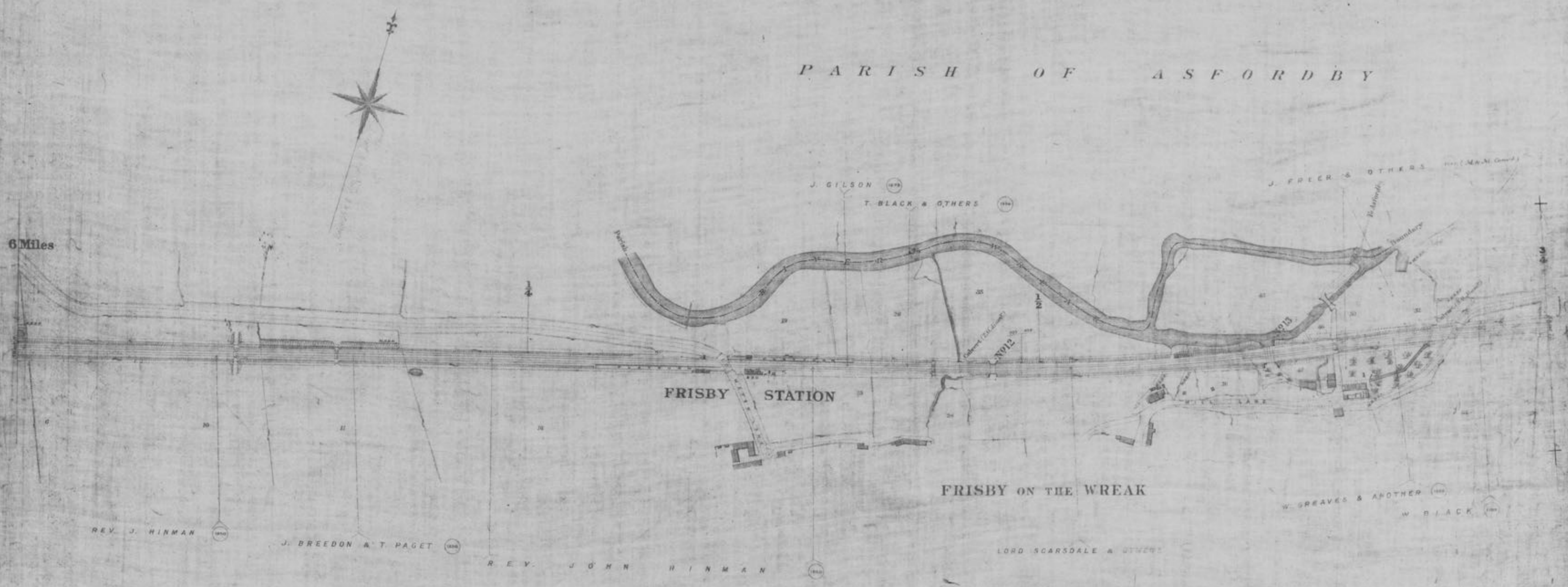

6 Miles



FRISBY STATION

FRISBY ON THE WREAK

P A R I S H O F F R I S B Y O N T H E W R E A K

Scale. 2 Chains to an Inch



Estate Agents Office,
Notland, Lincoln
Derby

COUNTY OF LEICESTER

PARISH OF FRISBY ON THE WREAK

PARISH OF KIRBY BELLARS

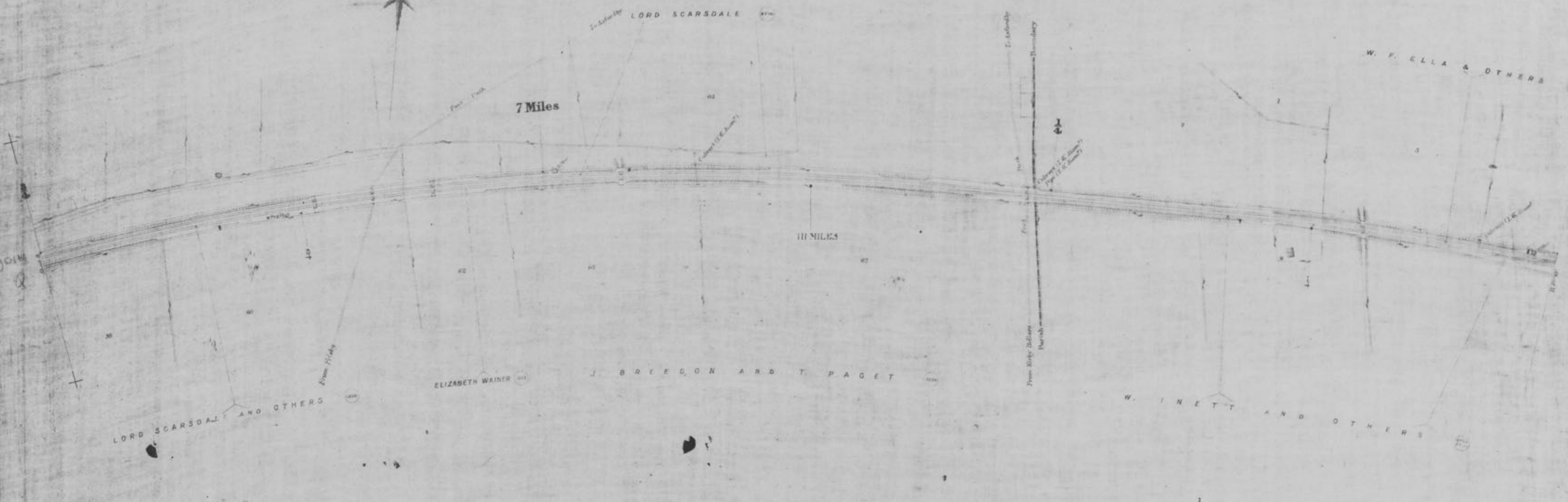

7 Miles

11 Miles

Scale, 2 Chains to an Inch.

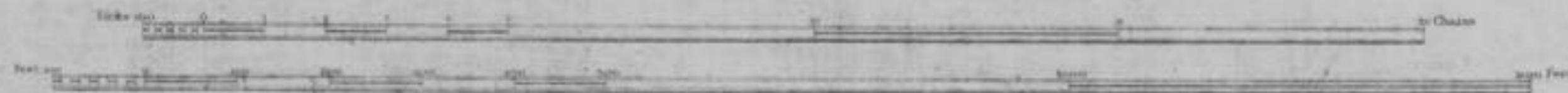

C O U N T Y O F L E I C E S T E R

P A R I S H O F K I R B Y B E L L A R S



For continuation of Title Rent Charge in the Parish of Kirby Bellars see D-rod. 1285.

W. F. ELLA AND OTHERS. (1847)

WARTNABY
See also D-rod. Comments on 4th Edition of B.

SIR F. BURDETTS TREES

8 Miles

ASFORDBY STATION

Asfordby S. B.

W. INETT AND MOSES

KIRBY BELLARS

Scale, 2 Chains to an Inch.

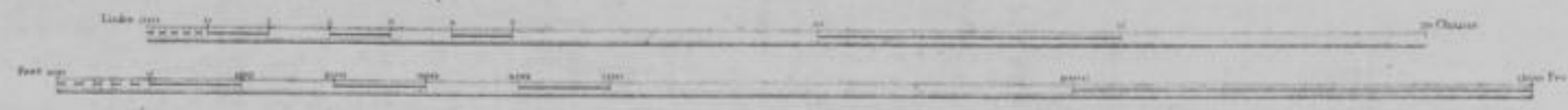

*Estate Agents Office,
Midland Railway
Derby*

COUNTY OF LEICESTER

PARISH OF KIRBY BELLARS

PARISH OF MELTON MOWBRAY



Calculations of Tithe Rent Charge in the Parish of Kirby Bellars

SIR F. BURDETT'S TREES

S. J. CHARLESWORTH

TREES OF W. BLAKE AND MARY HIS WIFE

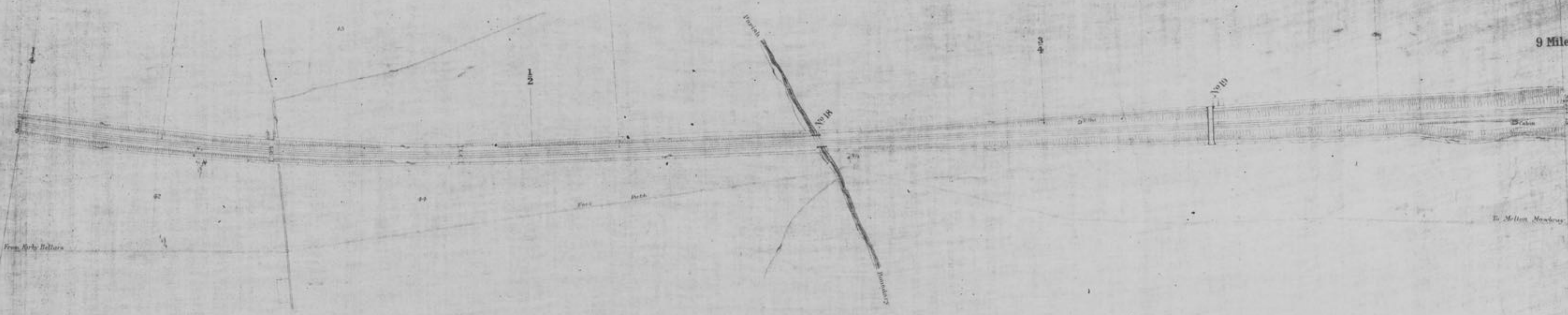

9 Miles

Scale, 2 Chains to an Inch.

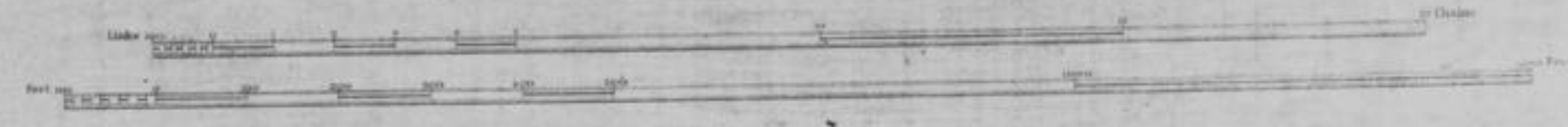

Estate Agents Office
Midland Railway
Derby

COUNTY OF LEICESTER

PARISH OF SYSONBY
FORMERLY PARISH OF MELTON MOWBRAY

PARISH OF MELTON MOWBRAY

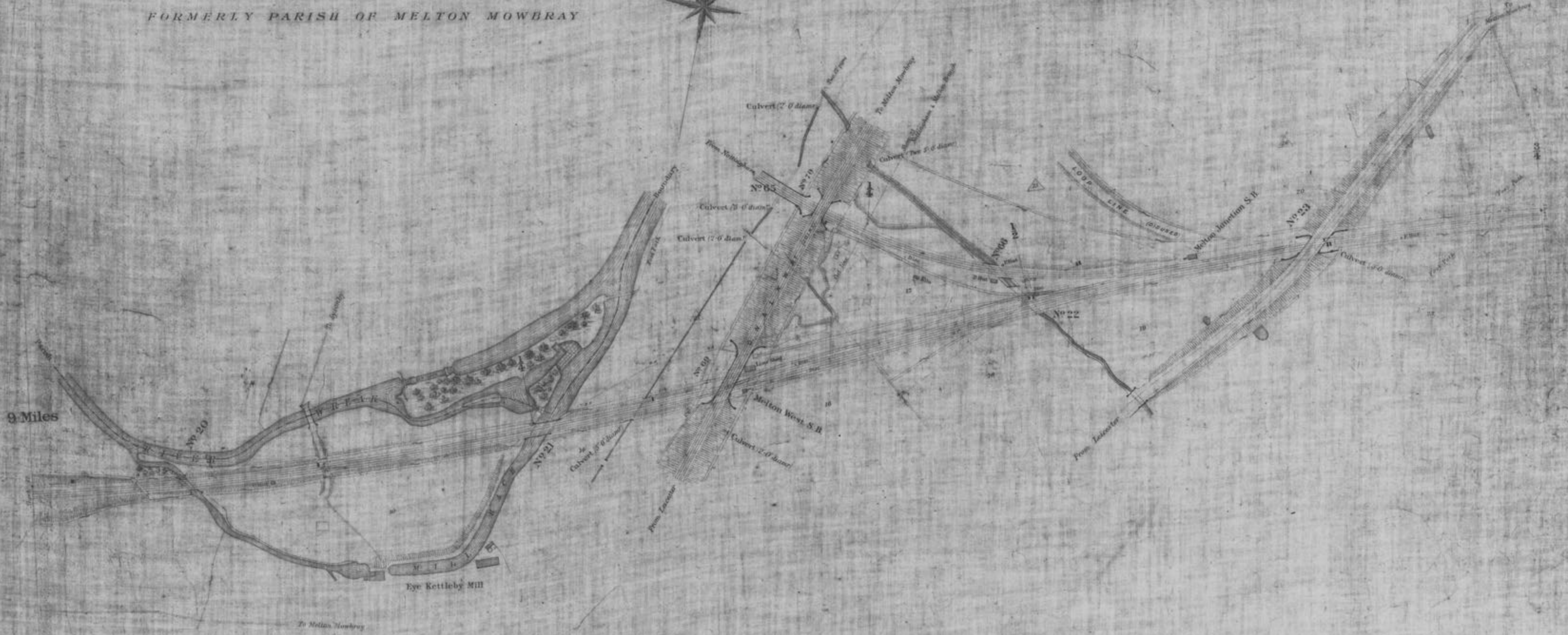

9 Miles

Scale. 2 Chains to an Inch.

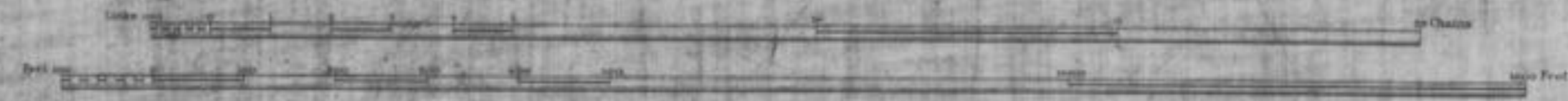

Engine Agents Office
Midland Railway
Derby

C O U N T Y O F L E I C E S T E R

U R B A N D I S T R I C T O F M E L T O N M O W B R A Y

F O R M E R L Y

P A R I S H O F M E L T O N M O W B R A Y

C O U N T Y O F L E I C E S T E R
D . C . O F M E L T O N

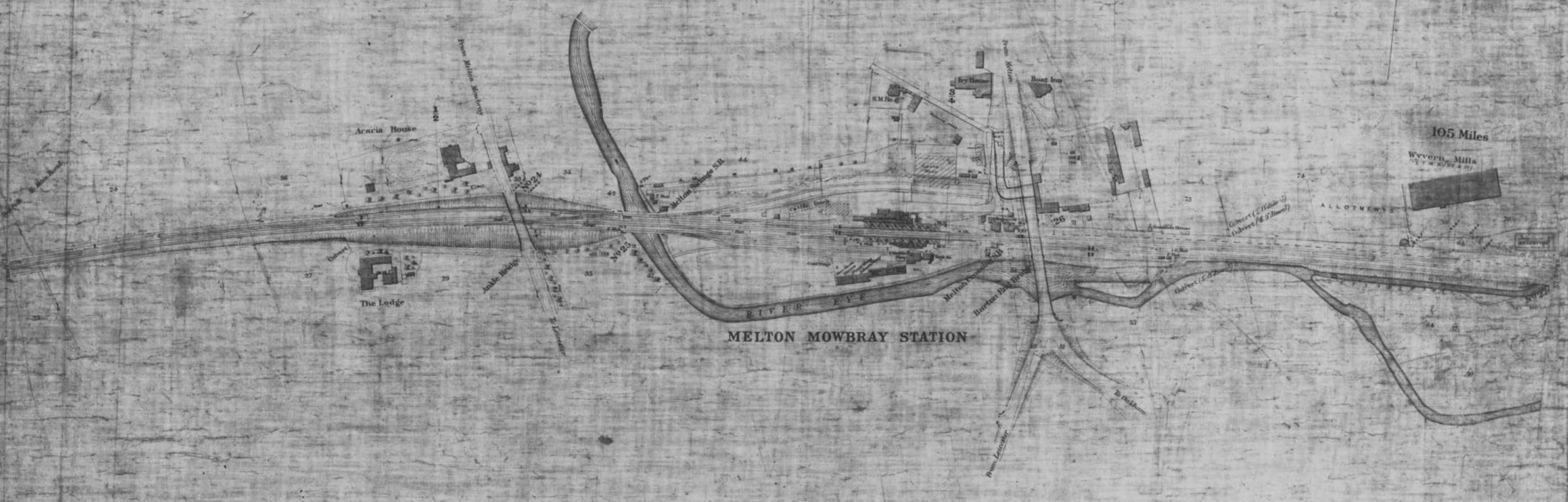

105 Miles

WYVERN MILLS
(T. W. RUSSELL)

ALLOTMENTS

MELTON MOWBRAY STATION

Scale. 2 Chains to an Inch

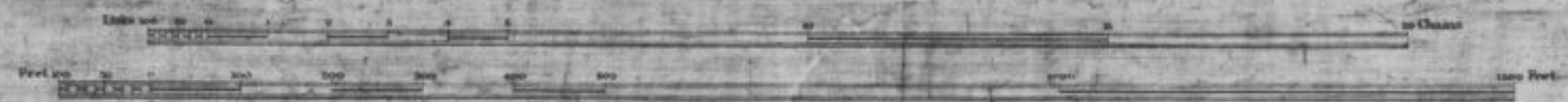

REVISED January, 1920.
Estate Agents Office,
Midland Railway,
Derby.

C O U N T Y O F L E I C E S T E R

P A R I S H O F T H O R P E A R N O L D

URBAN DISTRICT OF MELTON MOWBRAY
FORMERLY
PARISH OF MELTON MOWBRAY

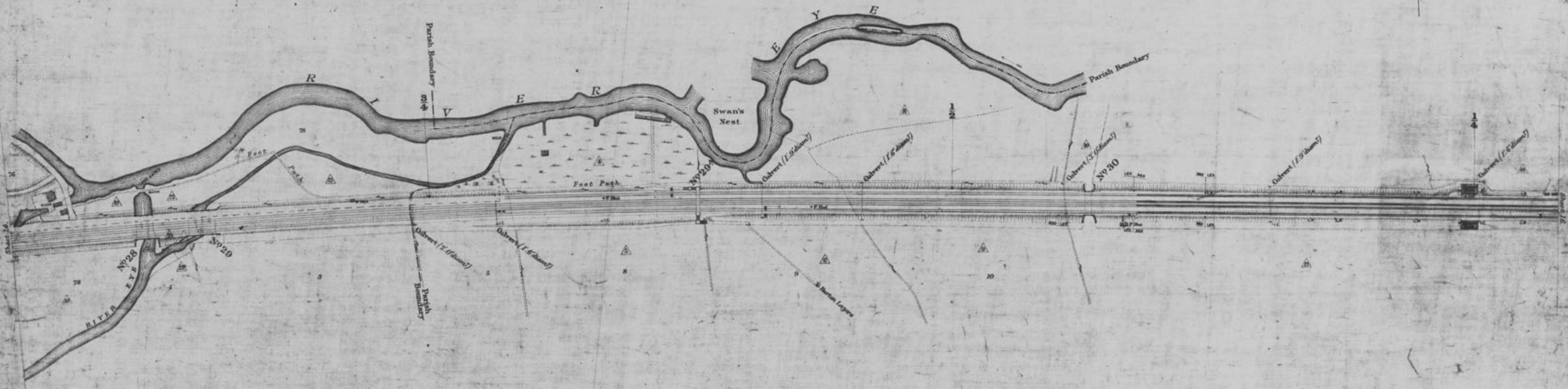

P A R I S H O F B U R T O N L A Z A R S

Scale, 2 Chains to an Inch



REVISED January, 1920.
Estate Agents Office,
Midland Railway
Derby

C O U N T Y O F L E I C E S T E R

PARISH OF
BURTON LAZARS

PARISH OF
THORPE ARNOLD

PARISH OF
WYFORDBY WITH BRENTINGBY
(FORMERLY PARISH OF THORPE ARNOLD, WYFORDBY,
& MELTON MOWBRAY INTERMIXED)

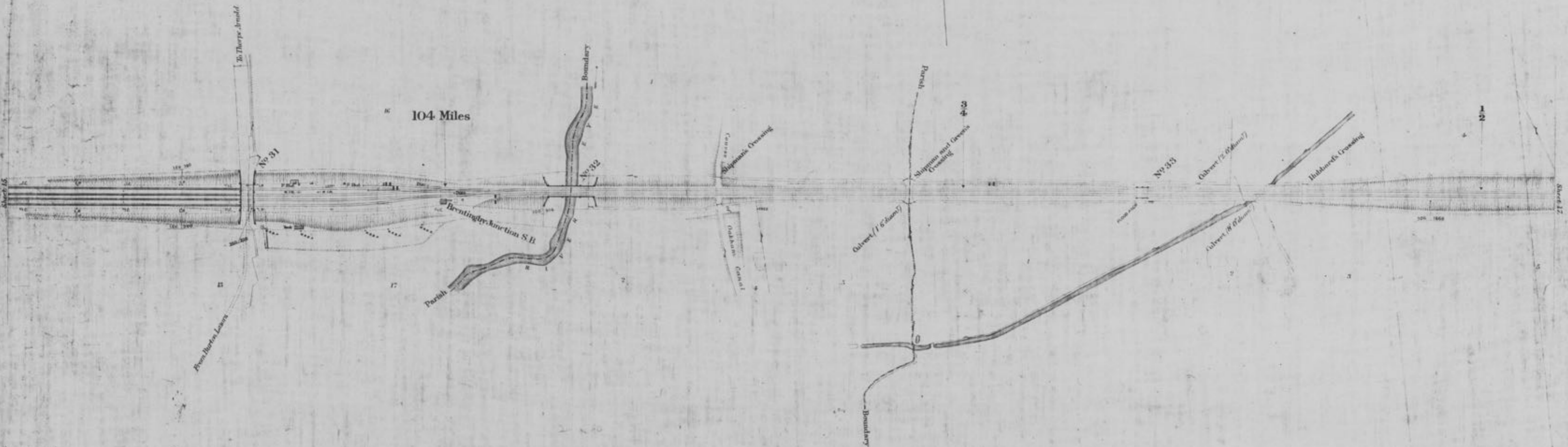

Scale. 2 Chains to an Inch.

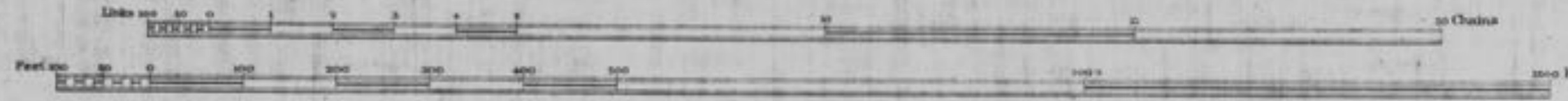

REVISED January 1920.
Estate Agents Office,
Midland Railway
Derby

C O U N T Y O F L E I C E S T E R

P A R I S H O F W Y F O R D B Y W I T H B R E N T I N G B Y

(F O R M E R L Y P A R I S H O F T H O R P E A R N O L D , W Y F O R D B Y & M E L T O N M O W B R A Y I N T E R M I X E D)



12 Miles

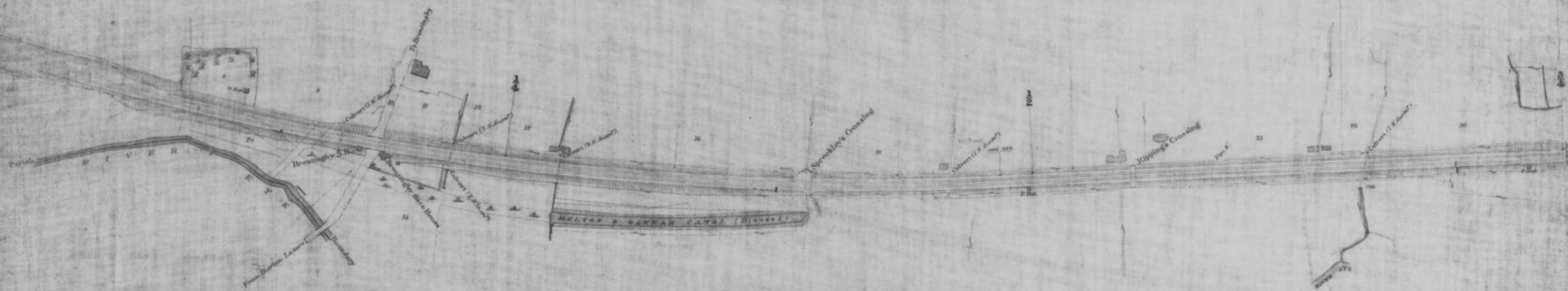

P A R I S H O F
B E R T O N L A Z A R S

Scale. 2 Chains to an Inch.

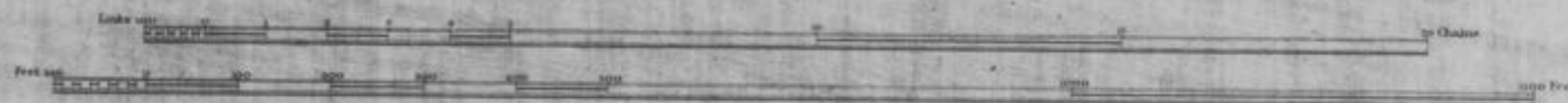

C O U N T Y O F L E I C E S T E R

PARISH OF WYFORDBY WITH BRENTINGBY
(FORMERLY PARISH OF THORPE ARNOLD, WYFORDBY,
& MELTON MOWBRAY INTERMIXED)

PARISH OF FREEBY
(FORMERLY PARISH OF MELTON MOWBRAY)

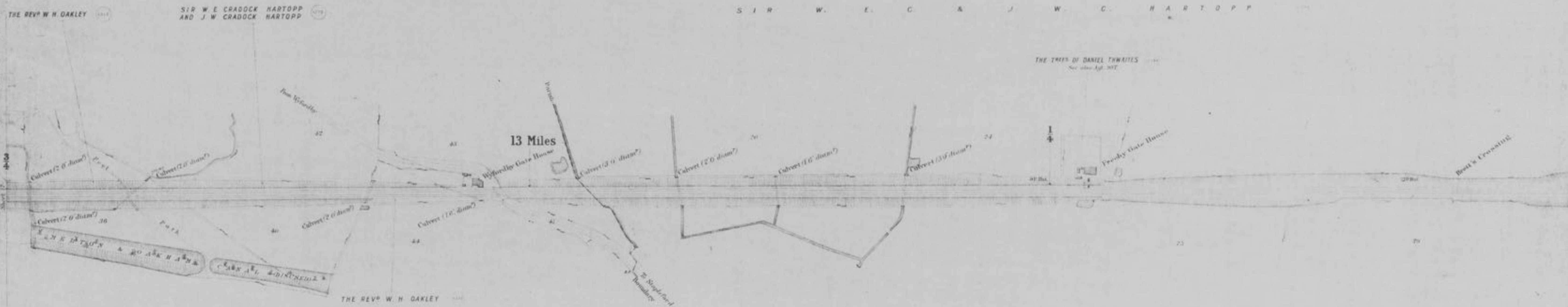

The Melton and Oakham Canal
created in the Midland Railway Company
under Act 1847. See Books 228

Scale. 2 Chains to an Inch.

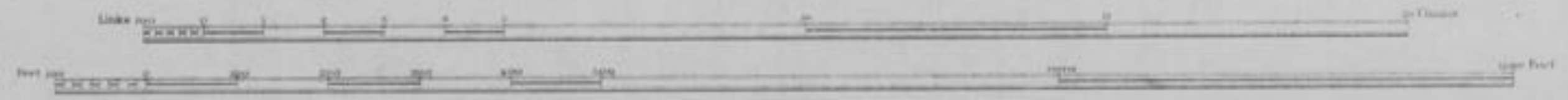

Estate Agents Office
Midland Railway
Derby

C O U N T Y O F L E I C E S T E R



P A R I S H O F F R E E B Y
(FORMERLY PARISH OF MELTON MOWBRAY)

P A R I S H O F S A X B Y

CARL OF HARBOROUGH & HIS MORTGAGEE

As by title see P. 1102
A.P. 1102



Scale, 2 Chains to an Inch

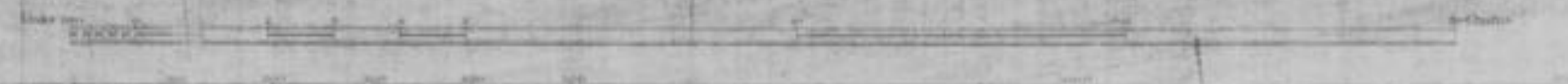

THE RIVER SURN & THE CANALS AND DRAINS OF THE PARISH OF SAXBY

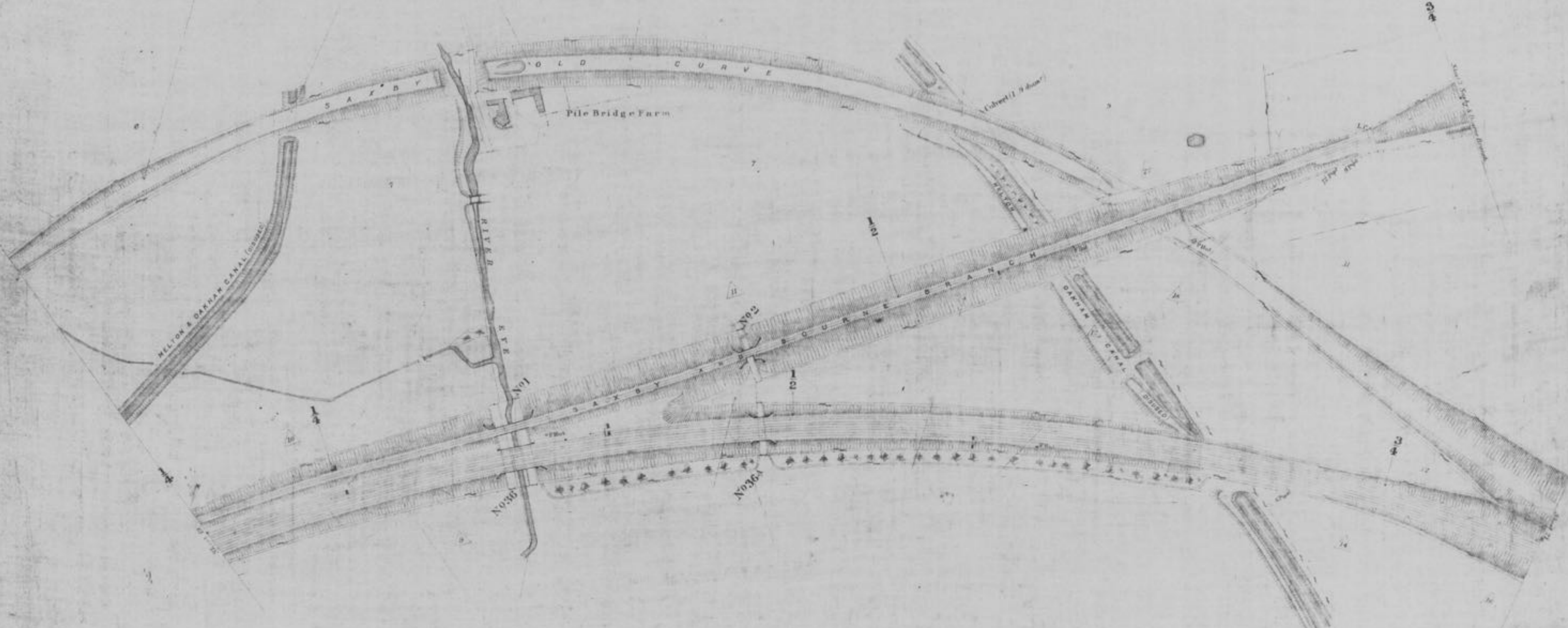

Scale. 2 Chains to an Inch.



041 3
Estate Agents Office
Mallard Park
Derby

System - Ceteris

C O U N T Y O F L E I C E S T E R

P A R I S H O F W Y M O N D H A M



PARISH OF SAXBY

T H E E A R L O F H A R B O R O U G H H I S M A G E E S

For Details see T.H. 5792 & G.P. Minute No 5504

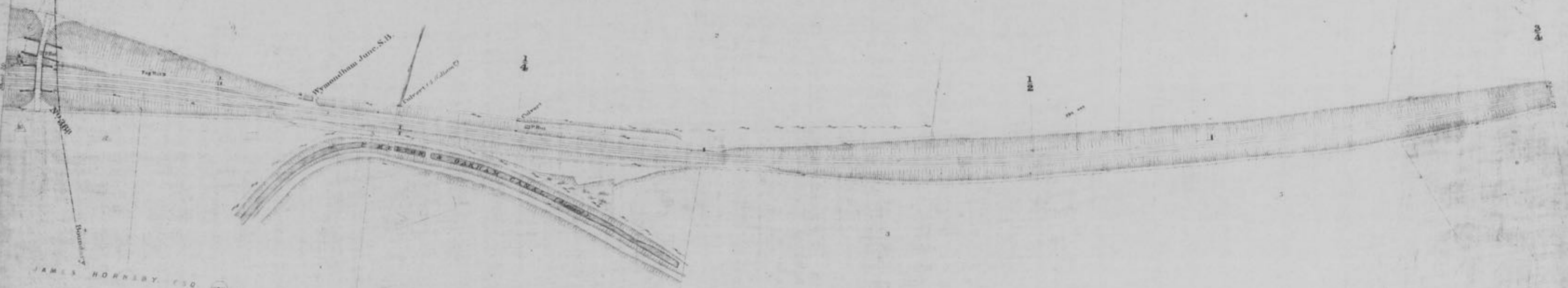

JAMES HORNBY, C.S.O.

THE MELTON & OAKHAM CANAL Taken by the MIDLAND RAILWAY CO under Act 1847.

S T A P L E F O R D P A R K

Scale, 2 Chains to an Inch.

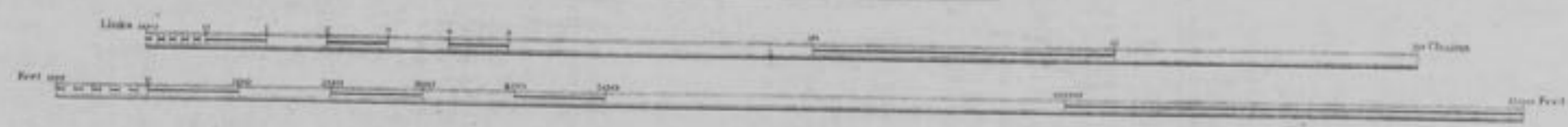

Estate Agents Office
Midland Railway
Derby

C O U N T Y O F L E I C E S T E R

P A R I S H O F W Y M O N D H A M

P A R I S H O F E D M O N D T H O R P E

T H E E A R L O F H A R B O R O U G H & H I S M O R T G A G E E S

W I L L I A M A . P O C H I N E S Q . & O T H E R S

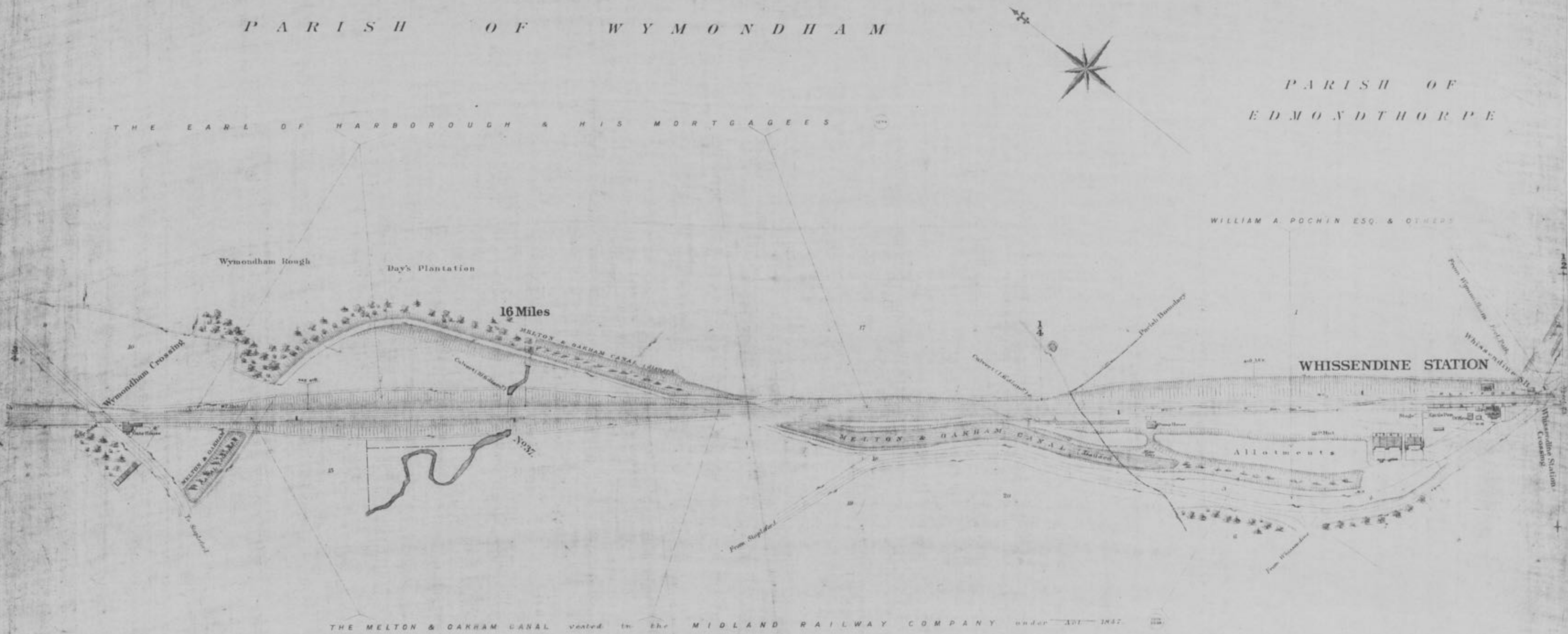

T H E M E L T O N & O A K H A M C A N A L vested in the M I D L A N D R A I L W A Y C O M P A N Y under ACT 1847.

Scale, 2 Chains to an Inch.

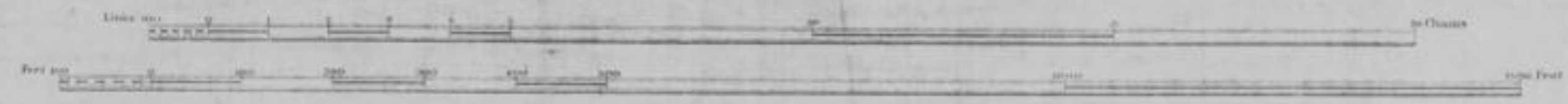

Estate Agents Office
Midland Railway
Derby

C O U N T Y O F R U T L A N D



COUNTY OF LEICESTER

PARISH OF EDMONDTHORPE

PARISH OF T E I G H

T H E E A R L O F H A R B O R O U S H A N D H I S M O R T G A G E

W. A. POCHIN ESQ. & OTHERS

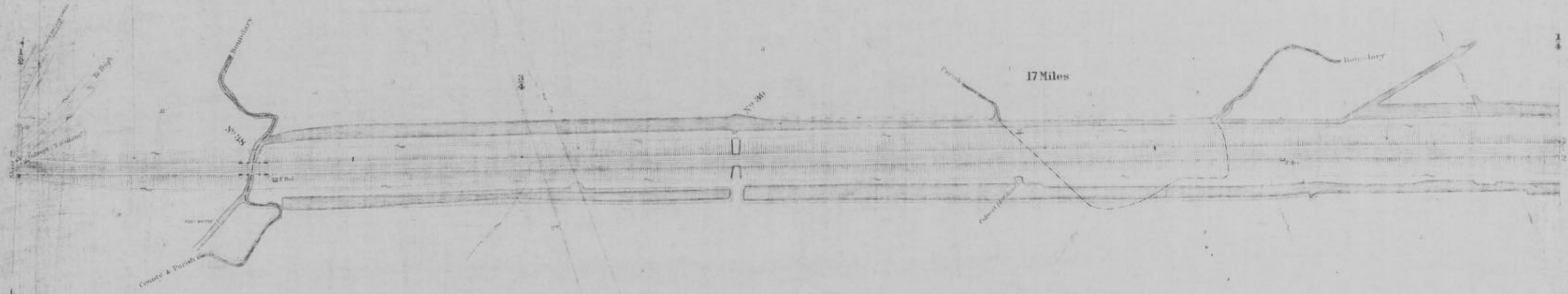

P A R I S H O F W H I S S E N D I N E

Scale, 2 Chains to an Inch.

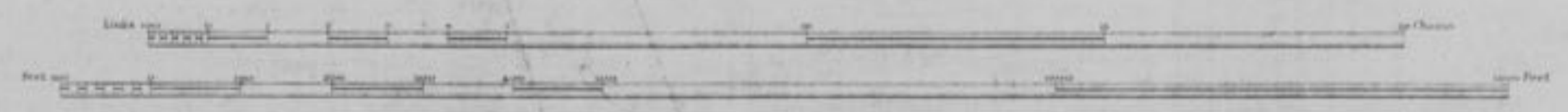

Estate Agents Office
Midland Railway
Derby