

C O U N T Y O F R U T L A N D

PARISH OF NORTH LUFFENHAM

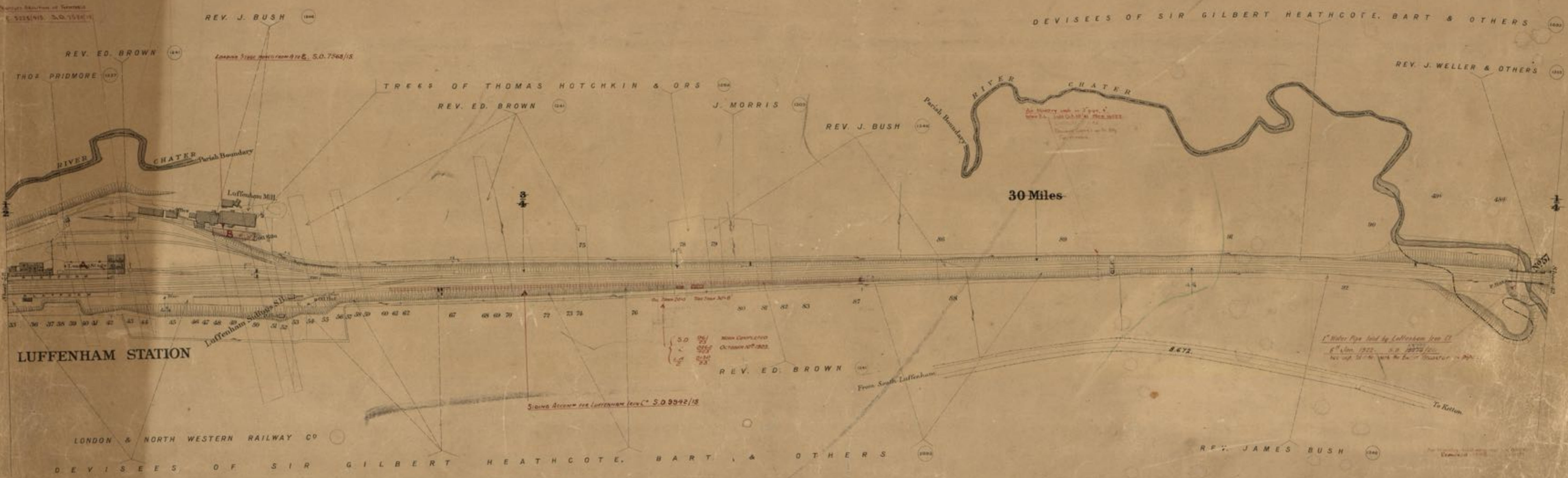

Small text in top left corner, possibly a title or reference note.



30 Miles

LUFFENHAM STATION

LONDON & NORTH WESTERN RAILWAY CO

DEVISEES OF SIR GILBERT HEATHCOTE, BART, & OTHERS

PARISH OF SOUTH LUFFENHAM

DEVISEES OF SIR G. HEATHCOTE, BART, & OTHS.

Scale, 2 Chains to an Inch.



Estate Agents Office, Midland Railway Derby

C O U N T Y O F R U T L A N D

PARISH OF NORTH LUFFENHAM

PARISH OF KETTON



KETTON, SOUTH WESTON, RETHERING, CHILCOT, LUFFENHAM QUARRIES, S.O. 9815/17.
Scale Reduced 4 1/2 in. to 1 in. 1894
and enlarged to 2 1/2 in. with English title to standard right 1250/1927.



BRIDGE No 58 AT 5M 9 1/4 CH. TWO 240 VOLT
OVERHEAD CONDUCTORS FIXED TO WESTERN
ABUTMENT ON 12-8-53. CORRES REF. 1.37330

PARISH OF SOUTH LUFFENHAM

Scale, 2 Chains to an Inch.

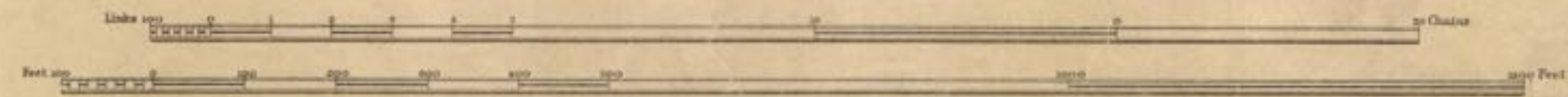

C O U N T Y O F R U T L A N D

P A R I S H O F K E T T O N



Siding Accommodation for M^r Rowe. Completed 27.10.04.
See Minute Plan 20560 (New Eastern Lines Co.)

L. 322/23 20 1924
See also E. Edwards' plan of Oct 8 in relation to the transferred to Northern
See Agreement dated December 6 1875/3

3 INCH DIAM WATER MAIN LHO UNDER LINE
SEE AGREEMENT DATED 21 & 22 WITH
KETTON RAIL DISTRICT COUNCIL

REV. J. H. NOYES
(Release of Overbridge at A)
Act. Sum of £ 40 15-10 00
as at 1882 to the 1880s.

THE VERY REV. R. STEVENS & HIS LESSEE

FRANCIS THOMPSON

J. W. GOODLIFFE
(See Act. 1828)

SUSANNAH OSBURN

GEORGE EDMONDS
(M. & M. Conv^{rs})

AMELIA DE RIPPE

32 Miles



KETTON STATION
See Agent with Duxton Lime Firms. Co Ltd.
dated 1-1-1871 and memorandum with Mr. T. C.
Molesworth dated 12-11-41. C/5976.

Allotments

REV. BALDWIN WAKE

LORD NORTHWICK & AN^o

THOMAS GREEN & WIFE

LORD NORTHWICK & ANOTHER

Scale. 2 Chains to an Inch.

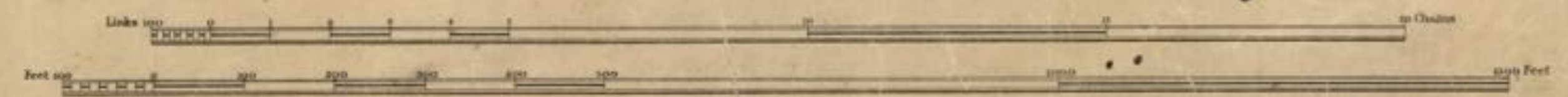

Ketton
Estate Agent's Office,
Milland Railway

C O U N T Y O F R U T L A N D

P A R I S H O F K E T T O N

L O R D N O R T H W I C K A D A N O T H E R



Ketton Portland Cement Co Ltd's Sidings

33 Miles

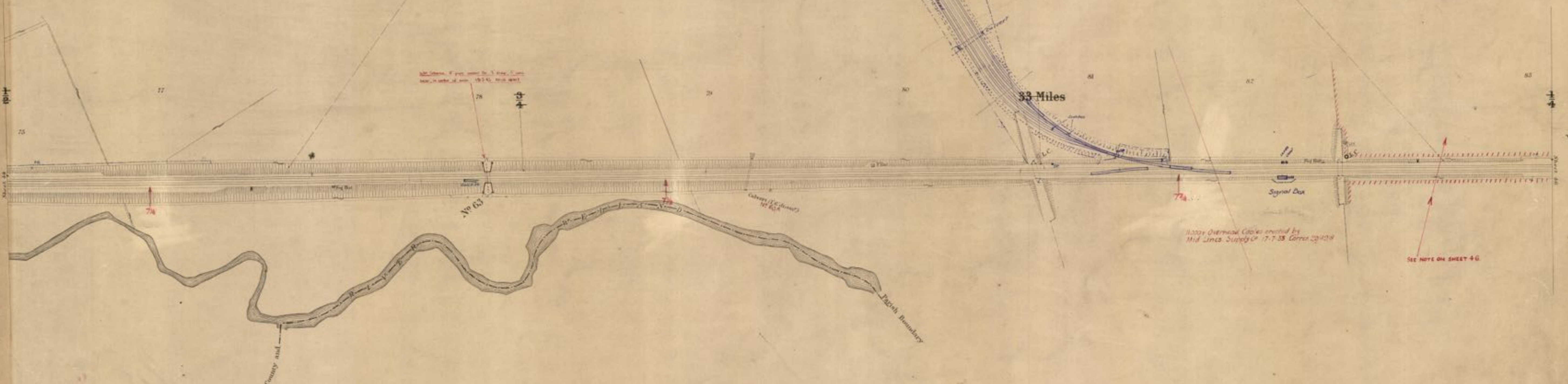

C O U N T Y O F N O R T H A M P T O N

P A R I S H O F E A S T O N O N T H E H I L L

Scale, 2 Chains to an Inch.

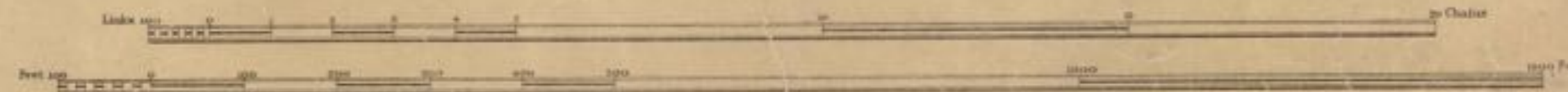

Ketton
Estate Agent's Office
Midland Railway
Derby

COUNTY OF RUTLAND

COUNTY OF NORTHAMPTON

PARISH OF KETTON

PARISH OF EASTON ON THE HILL

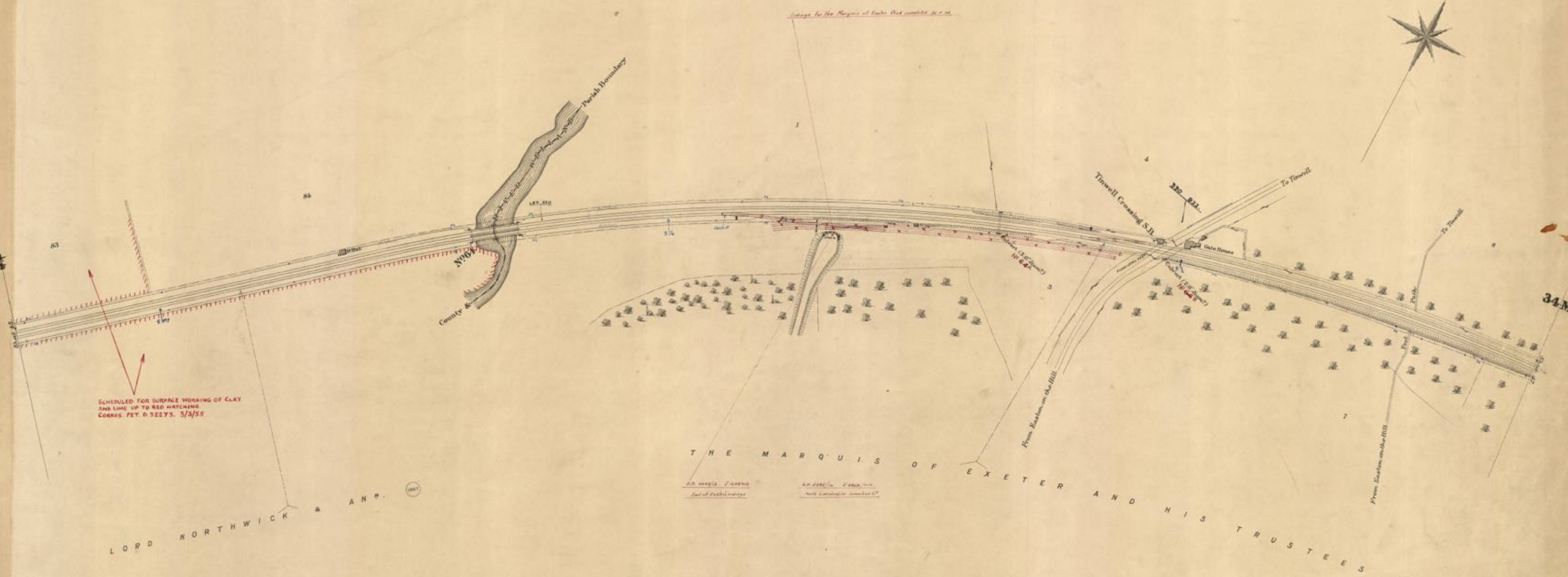

34 Miles

THE MARQUIS OF EXETER AND HIS TRUSTEES

LORD NORTHWICK & ANR.

Scale. 2 Chains to an Inch.

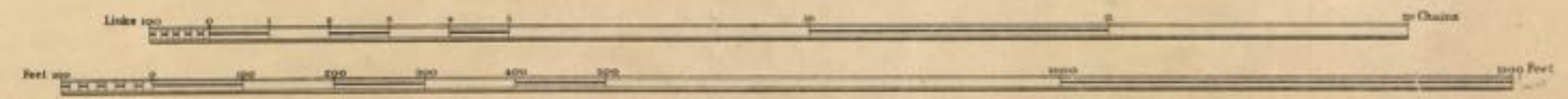

Estate Agents Office,
Midland Railway,
Derby

COUNTY OF LINCOLN

PARISH OF ALL SAINTS

BOROUGH OF STAMFORD

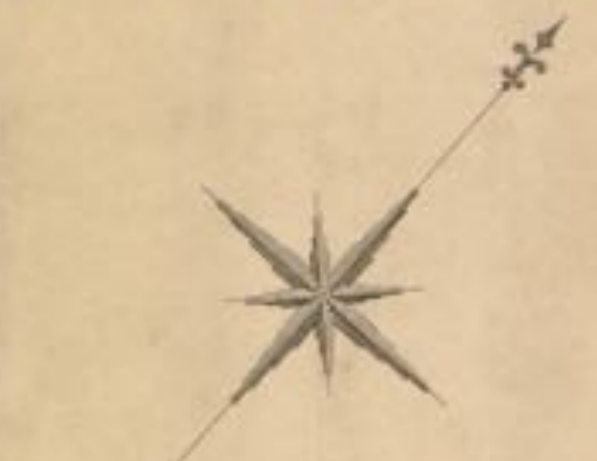

See Appendix dated 1906 July 1904 N° 83 Book 04
N° 1000
Dated 20-10-1913

THE MARQUIS OF EXETER AND HIS TRUSTEES

TRACES OF BROWN'S HOSPITAL

STAMFORD CORPORATION & OTHERS

THE MARQUIS OF EXETER & ANR

See Appendix dated 1903 concerning a cable
belonging to the Great Eastern Railway Co. Ltd.

As to Land taken by Stamford Corporation
See PH 5887

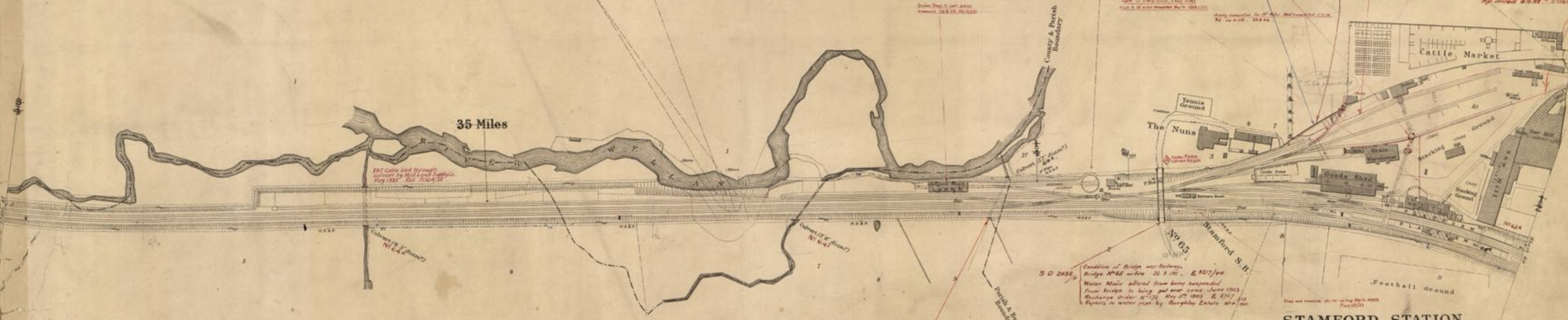

35 Miles

STAMFORD STATION

L. & N. W. RY
(As to Easements and Working Arrangements)

THE MARQUIS OF EXETER AND HIS TRUSTEES

COUNTY OF NORTHAMPTON

PARISH OF WOTHORPE

PARISH OF ST MARTIN STAMFORD BARON

Scale. 2 Chains to an Inch.

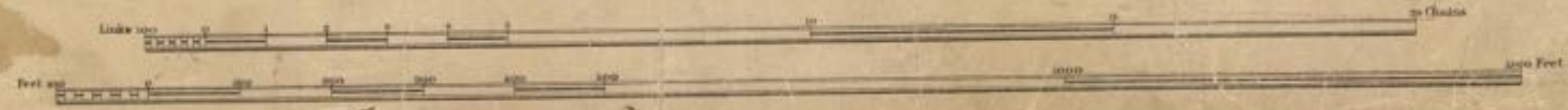

BOROUGH OF STAMFORD

COUNTY OF LINCOLN

PARISH OF ST GEORGE



THE MARQUIS OF EXETER AND HIS TRUSTEES
WARDENS of BURGHLEY'S HOSPITAL

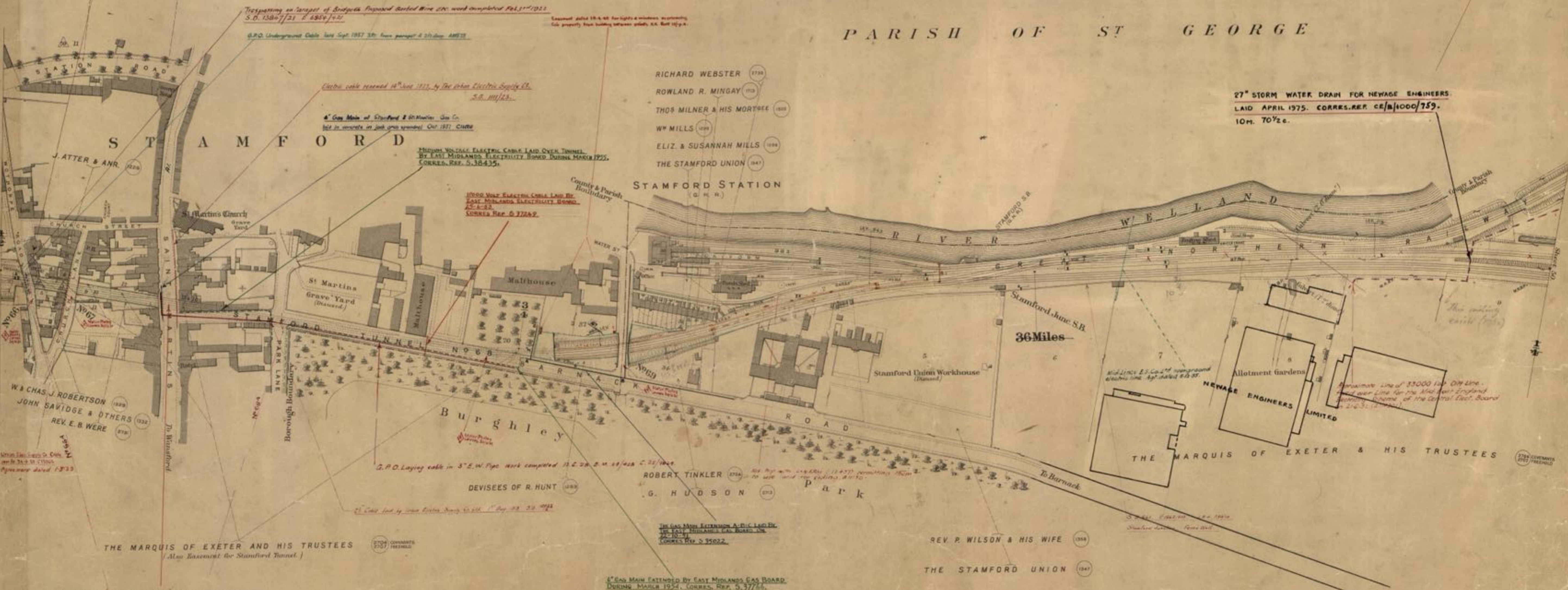

27" STORM WATER DRAIN FOR NEWAGE ENGINEERS
LAID APRIL 1975. CORRES. REF CE/B/1000/759.
10M. 70 1/2c.

W & CHAS. J. ROBERTSON
JOHN SAVIDGE & OTHERS
REV. E. B. WERE

THE MARQUIS OF EXETER AND HIS TRUSTEES
(Also Easement for Stamford Tunnel.)

BRIDGE No 6B (Stamford Tunnel), SUPERSTROUDS
LAKENHE BRIDGE NORTH ROAD, RECONSTRUCTED IN 1953.
FOR DETAILS AND SERVICE PIPES, CABLES, ETC SEE
DRAWING No 91, L.C. 198A. CORRES. REF. S 34982.

PARISH OF ST MARTIN STAMFORD BARON

COUNTY OF NORTHAMPTON

Scale, 2 Chains to an Inch.



Estate Agents Office,
Midland Railway
Derby

C O U N T Y O F N O R T H A M P T O N

PARISH OF ST MARTIN STAMFORD BARON

PARISH OF BARNACK

(FORMERLY PARISH OF PILSGATE)

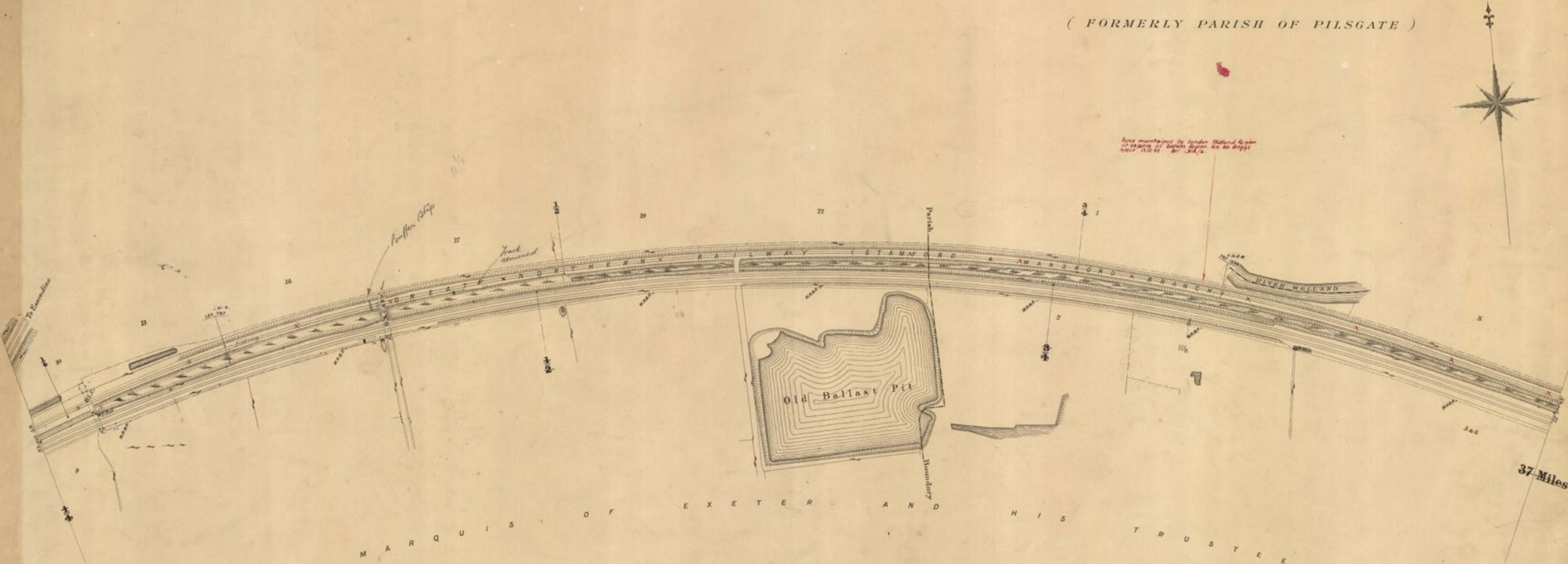

T H E M A R Q U I S O F E X E T E R A N D H I S T R U S T E E S

37 Miles

Scale, 2 Chains to an Inch.

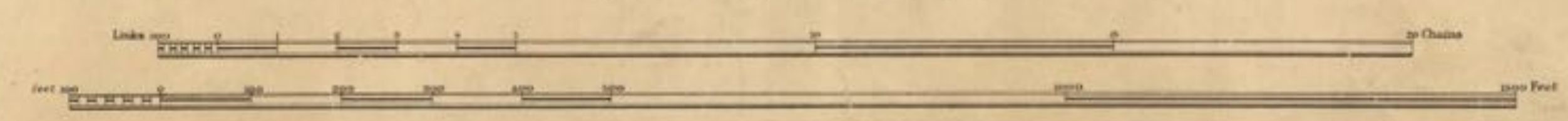

6785 CONTRACTORS' RECORDS

C O U N T Y O F N O R T H A M P T O N

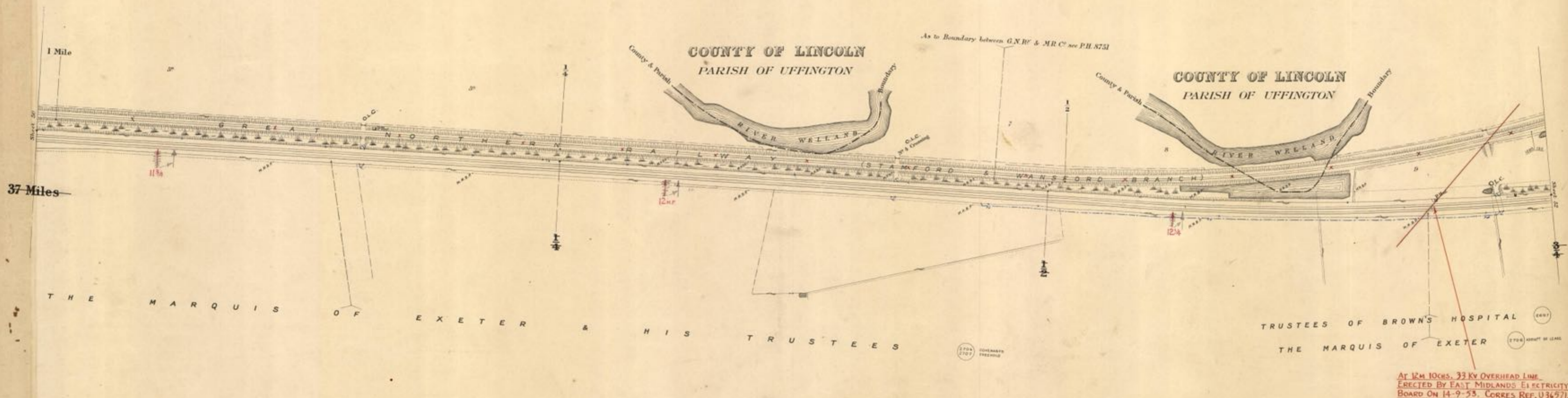

P A R I S H O F B A R N A C K
(FORMERLY PARISH OF PILSGATE)

Scale, 2 Chains to an Inch.

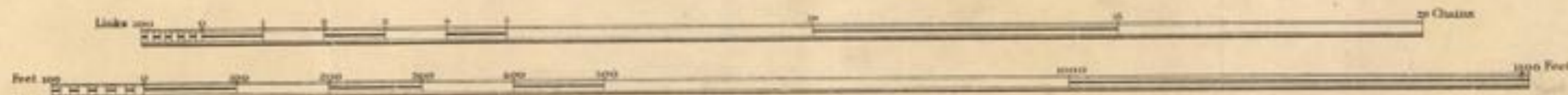

C O U N T Y O F N O R T H A M P T O N

P A R I S H O F B A R N A C K



T H E M A R Q U I S O F E X E T E R A N D H I S T R U S T E E S

(1207) COVENANTS FREEHOLD

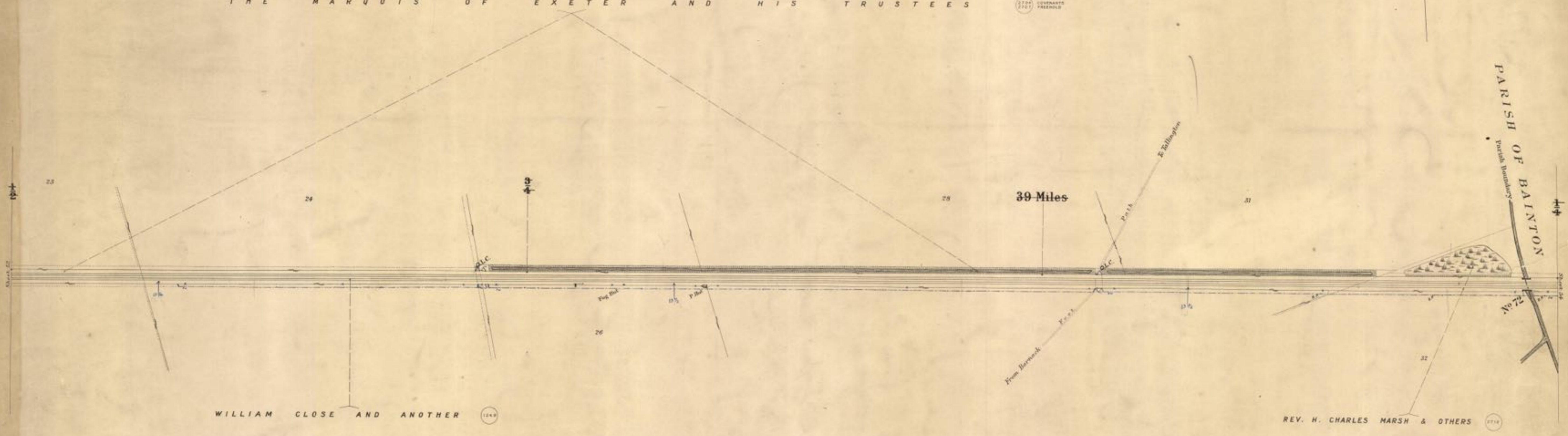

WILLIAM CLOSE AND ANOTHER (1249)

REV. H. CHARLES MARSH & OTHERS (1214)

Scale. 2 Chains to an Inch.

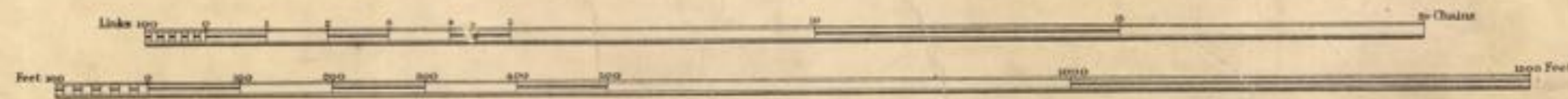

C O U N T Y O F N O R T H A M P T O N

P A R I S H O F B A I N T O N



REV. ROBINSON ELSDALE AND HIS TRUSTEES

SIR JOHN TROLLOPE

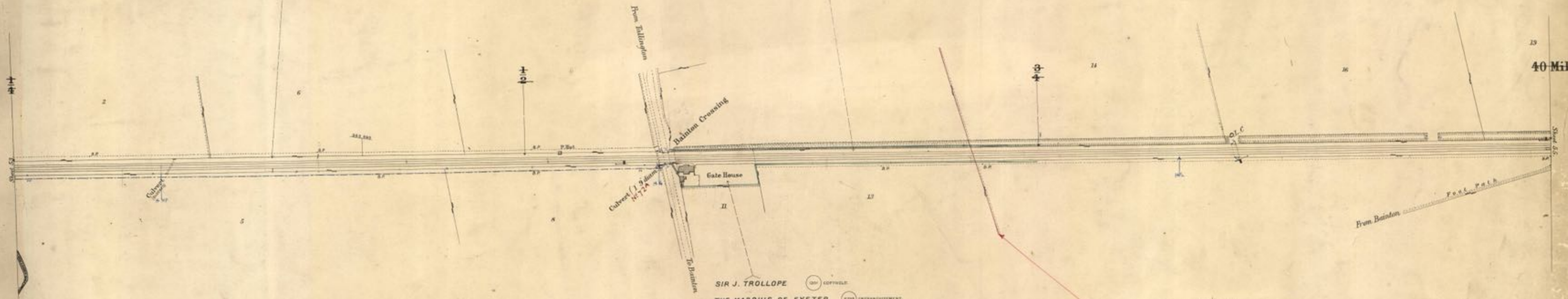

40 Miles

SIR J. TROLLOPE
THE MARQUIS OF EXETER

5" DIAM. RISING MAIN, BARNACK
R.D.C. SEWERAGE SCHEME.
CORRES. REF. B. 40087

Scale, 2 Chains to an Inch.

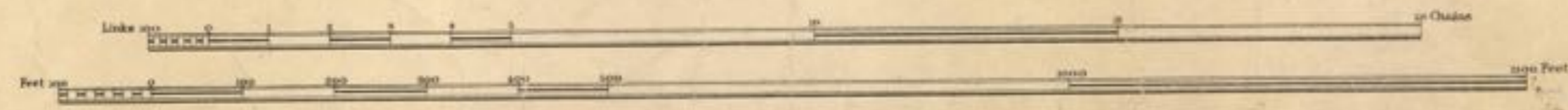

Estate Agents Office,
Midland Railway
Derby.

S.D. 622/14. C 2824/14. L 24. 2142/14
 Survey of Canal Ditch between Canal D
 Flex. No. 1018. Surveyed out by Lord Kesteven about July 1818
 This road to be widened out between A & B by the Midland Rly Co
 See Mr. Clays letter of 8.1.18 and Lord Kesteven's letter (Mr. Edward Smith)
 of January 8th 1818. S.D. 622/14. C 2824/14. L 24. 2142/14

THE RIGHT HON^{ble} JOHN HENRY BARON KESTEVEN & HIS TRUSTEES (M. & M. Contd.)

THE RIGHT HON^{ble} J. H. BARON KESTEVEN (M. & M. Contd.)

TRUSTEES OF WILLIAM E. HUTCHINSON ESQ. (M. & M. Contd.)

See agreement dated 22nd 87 with Mr. Trollope-Bellin concerning the way - 26550.

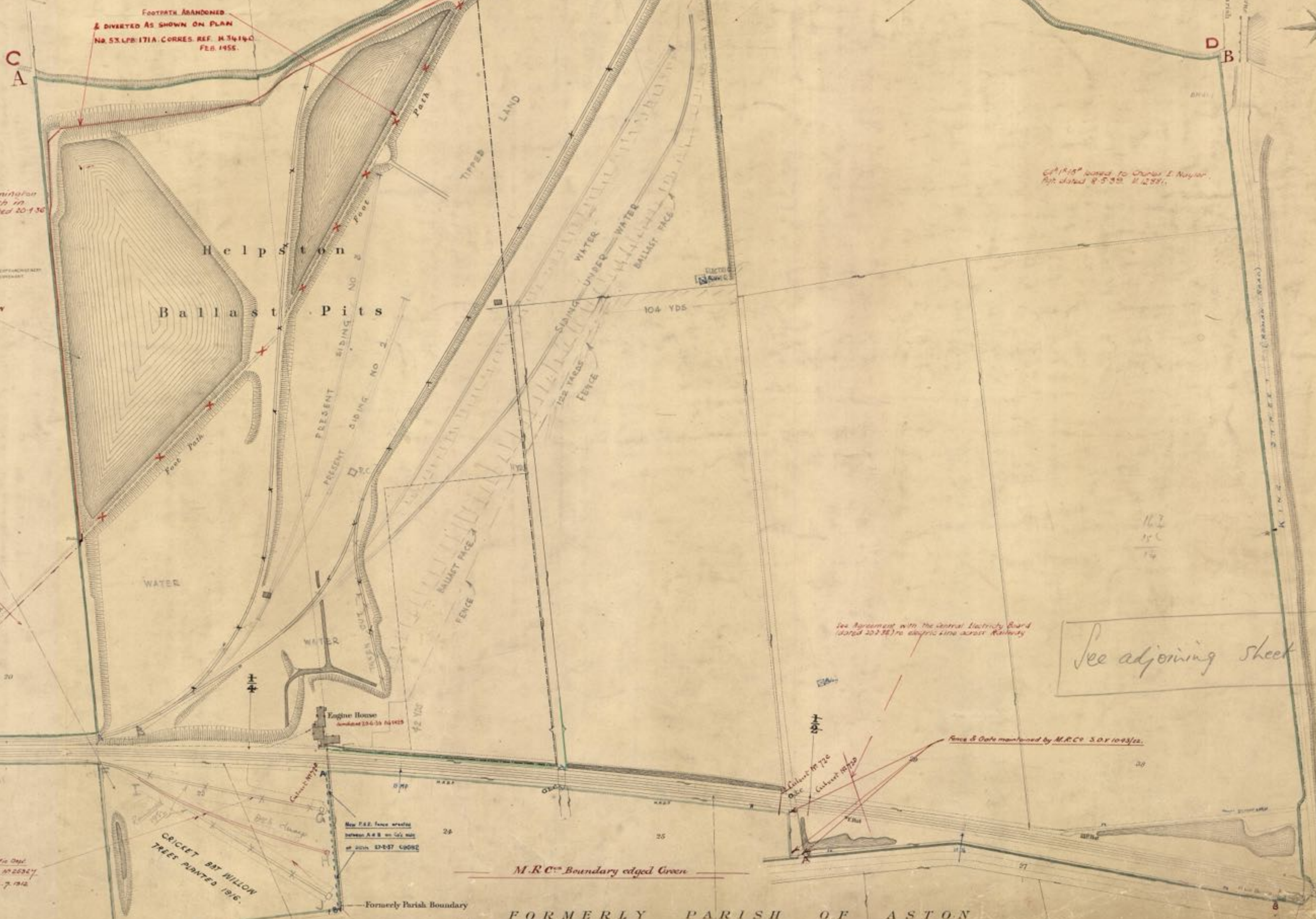

See adjoining sheet

FORMERLY PARISH OF ASTON

SIR JOHN TROLLOPE BART.

Scale, 2 Chains to an Inch.

JOHN NOTTINGHAM, THE MARQUIS OF EXETER.

Estate Agents Off. Midland Railway Derby

Miles

Sidings transferred to Traffic Dept. See Memo Plan No 26547 of 7. 1912

Copyright 1910. Enlargement

Survey of the Canal Ditch between Canal D and the Midland Rly Co. S.D. 622/14. C 2824/14. L 24. 2142/14

C O U N T Y O F N O R T H A M P T O N

P A R I S H O F H E L P S T O N

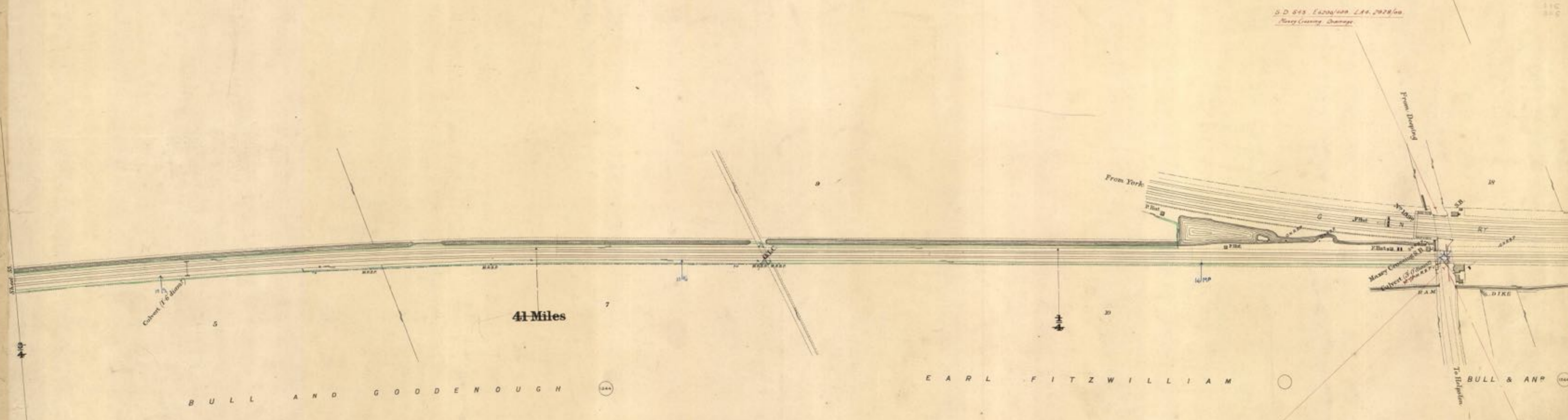

S.D. 515. E. 1200/100. L.A. 2028/100.
Masey Crossing Drainage

Coburn (F.S. Stone)

41 Miles

BULL AND GODDENOUGH

EARL FITZWILLIAM

BULL & ANP

Proposed 1000 ft. main
L.W.S. 1867/100.

S.D. 1867/2 E. 1020/100
Parish Council complaint re forming Masey Crossing

Scale, 2 Chains to an Inch.

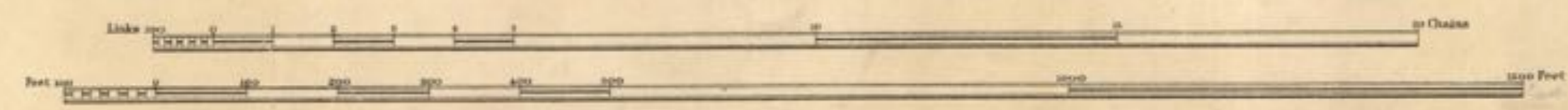

C O U N T Y O F N O R T H A M P T O N

P A R I S H O F H E L P S T O N

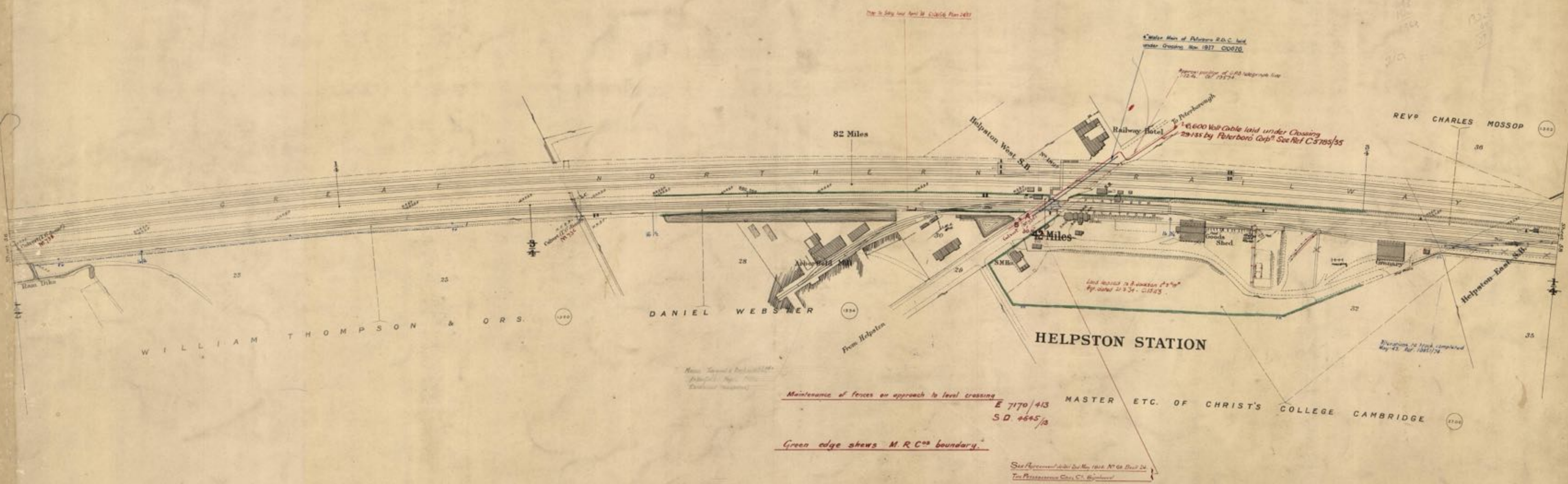

Scale, 2 Chains to an Inch.

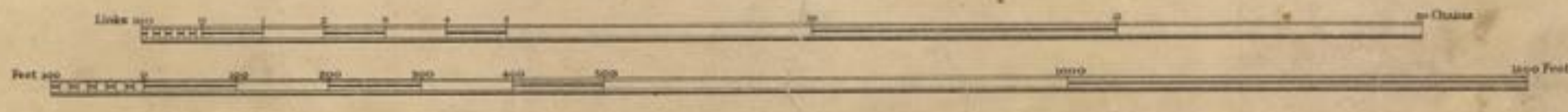

Helpston Station

C O U N T Y O F N O R T H A M P T O N

P A R I S H O F E T T O N

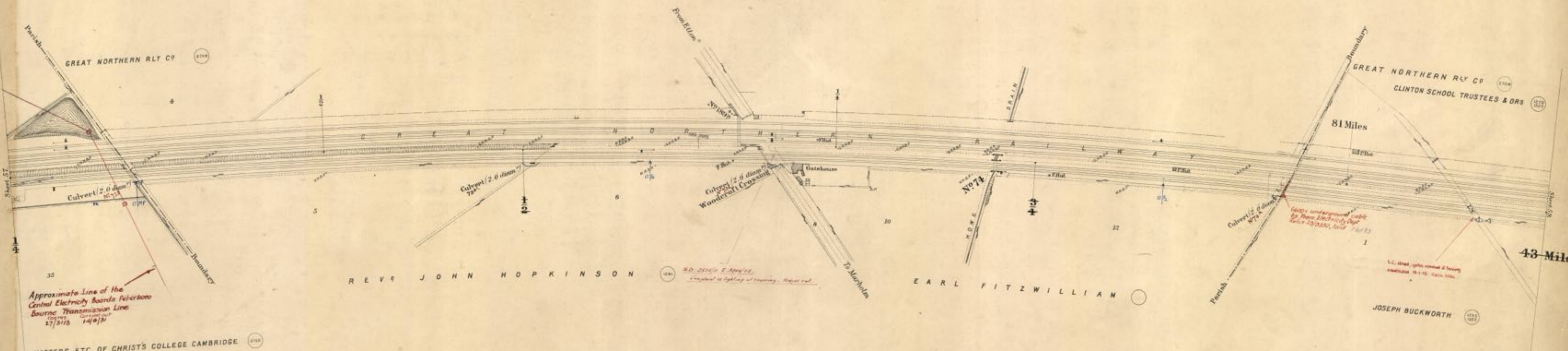
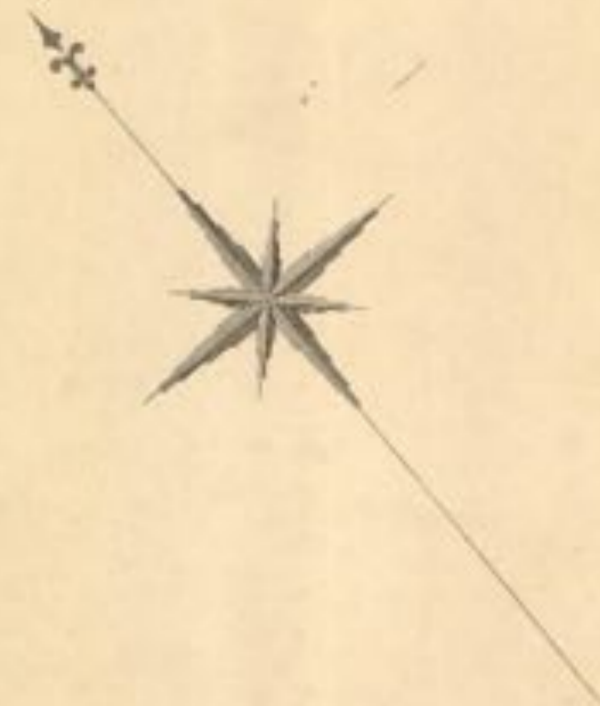

PARISH OF HELPSTON

PARISH OF GLINTON

Scale, 2 Chains to an Inch.

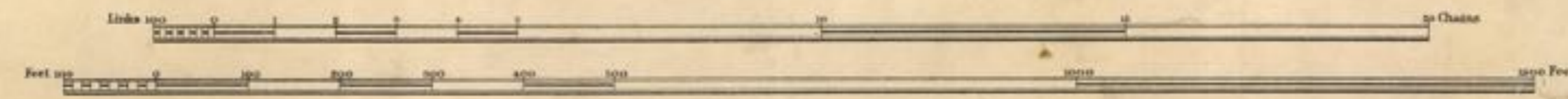

Estate Agents Office, Midland Railway, Derby

C O U N T Y O F N O R T H A M P T O N

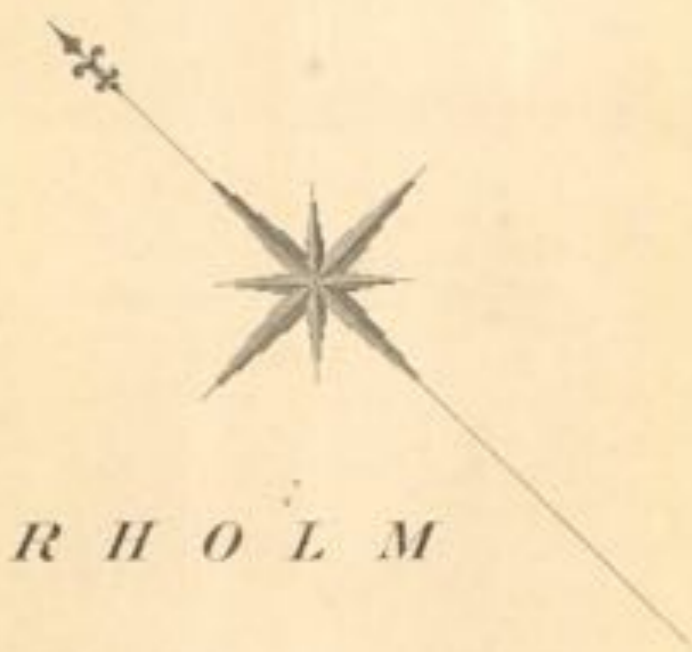

PARISH OF GLINTON

PARISH OF MARHOLM

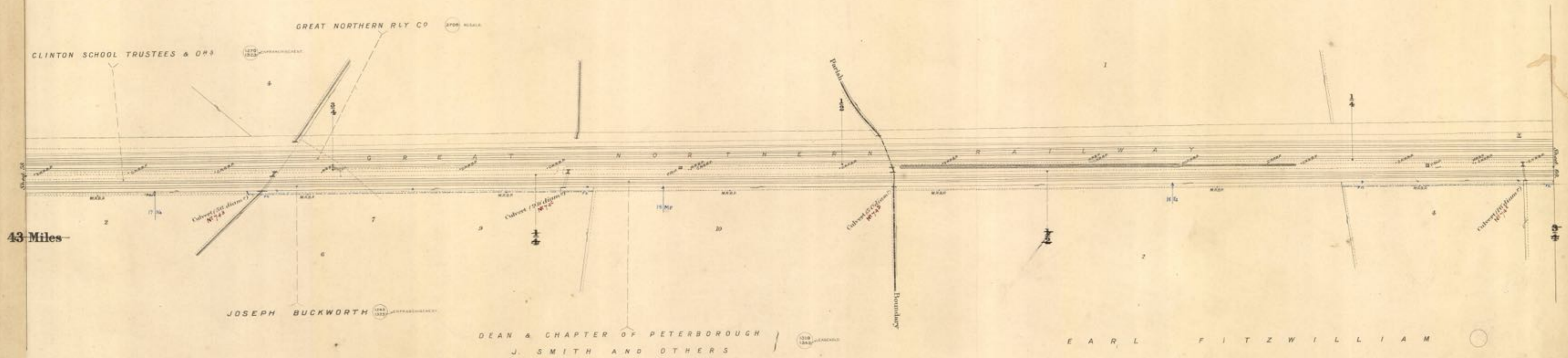

43 Miles

Scale. 2 Chains to an Inch.

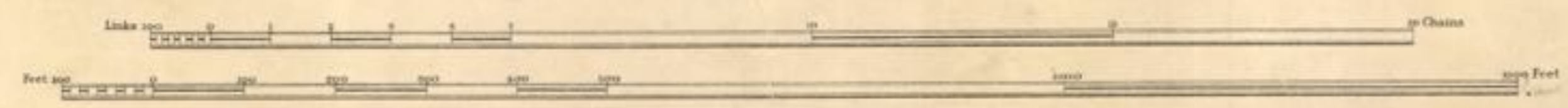

C O U N T Y O F N O R T H A M P T O N

P A R I S H O F W E R R I N G T O N
(FORMERLY PARISH OF PASTON)

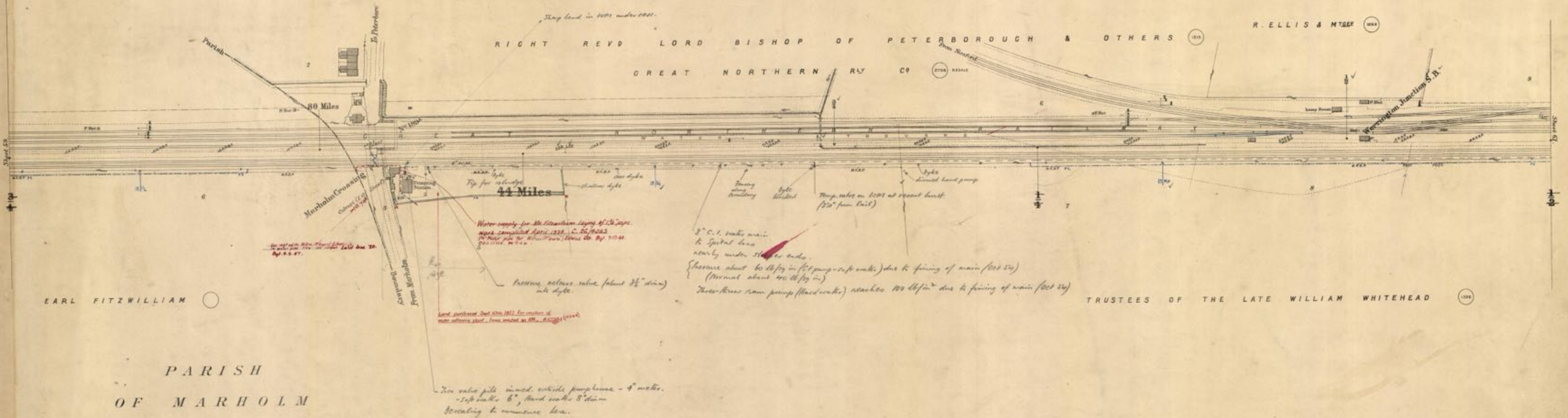

Werrington Junction

C O U N T Y O F N O R T H A M P T O N

PARISH OF WERRINGTON
(FORMERLY PARISH OF PASTON)

PARISH OF WALTON
(FORMERLY PARISH OF PASTON)

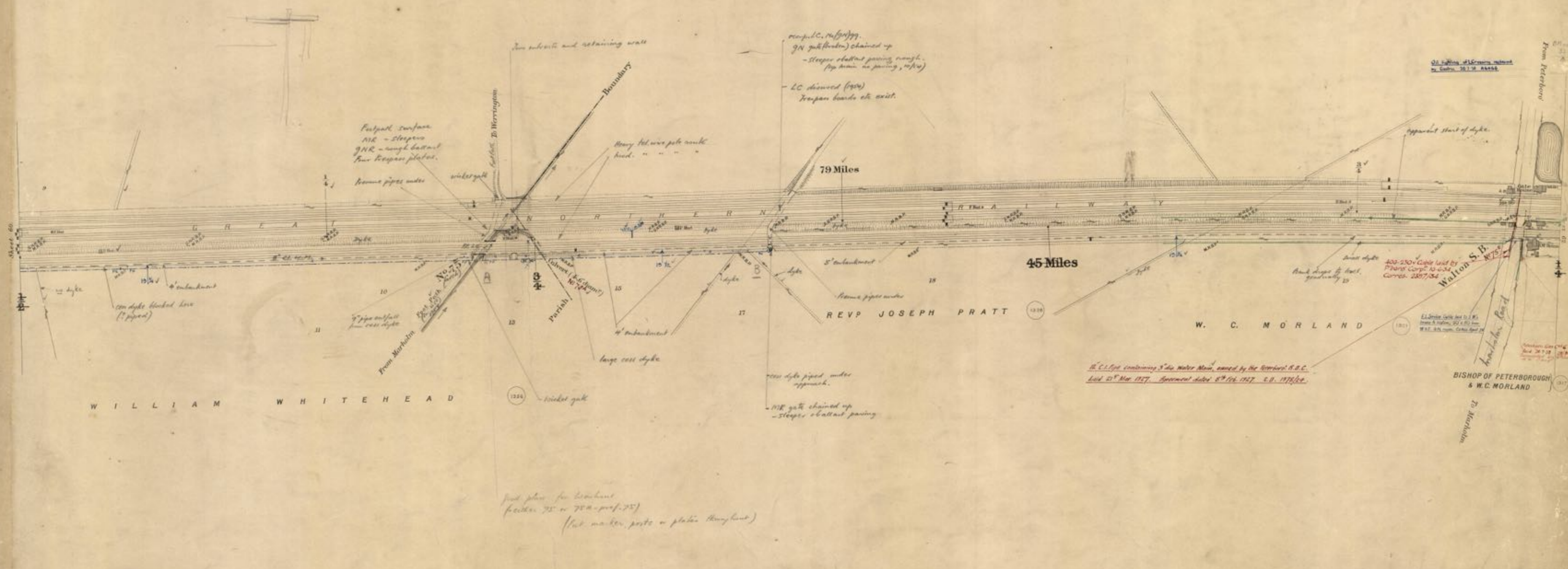
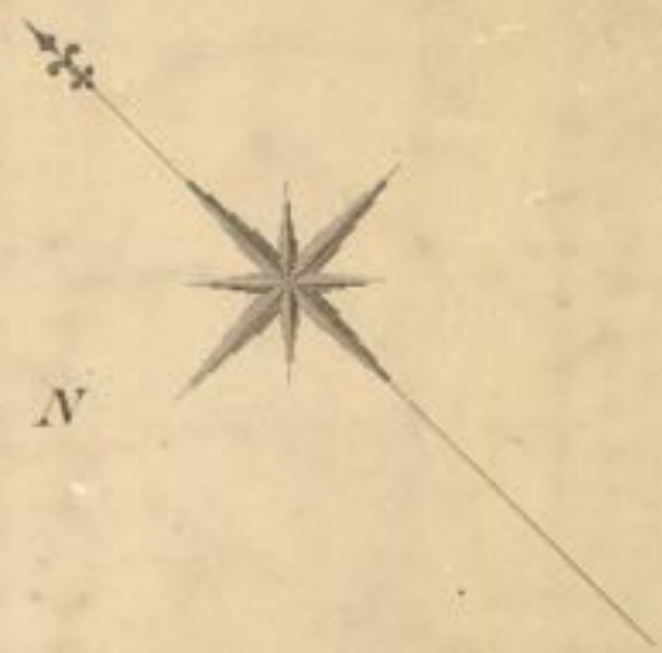

Scale, 2 Chains to an Inch.

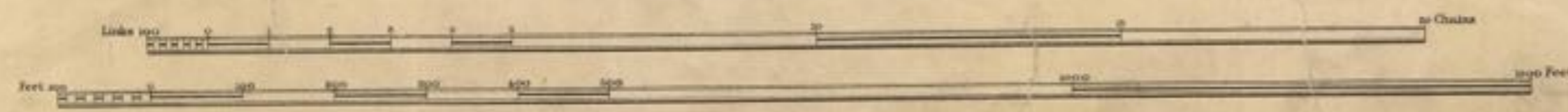

C O U N T Y O F N O R T H A M P T O N

P A R I S H O F W A L T O N
(FORMERLY PARISH OF PASTON)

P A R I S H O F S T J O H N B A P T I S T
P E T E R B O R O U G H



WALTON

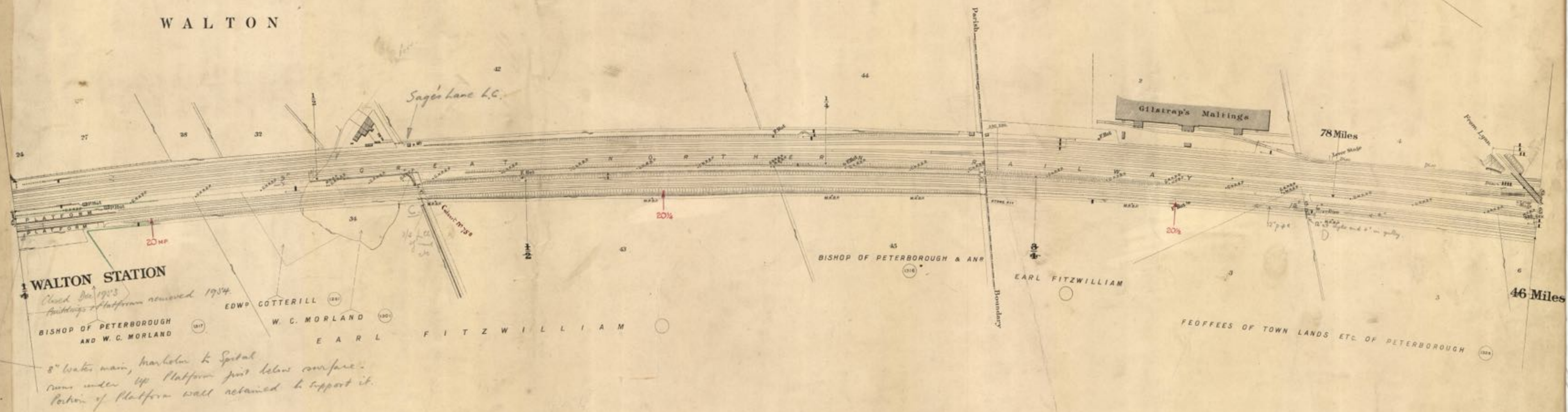

WALTON STATION
Closed Dec 1923
Buildings & Platform removed 1954
BISHOP OF PETERBOROUGH
AND W. C. MORLAND

8" water main, Marlborough L. Spital
runs under 4th Platform just below surface.
Portion of Platform wall retained to support it.

Scale. 2 Chains to an Inch.

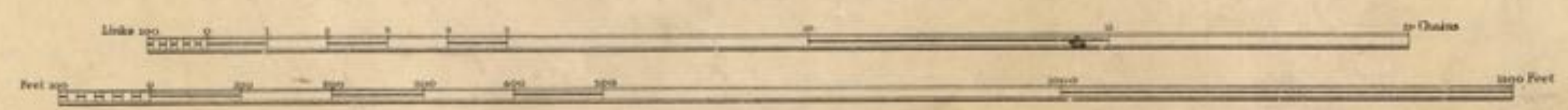

Walton Stn

CITY AND BOROUGH OF PETERBOROUGH
PARISH OF PETERBOROUGH WITHIN
FORMERLY
COUNTY OF NORTHAMPTON
FORMERLY
PARISH OF ST JOHN THE BAPTIST

Continuation from 17. Water Main
to Peter. Gen. 473-51. Aug 1877.

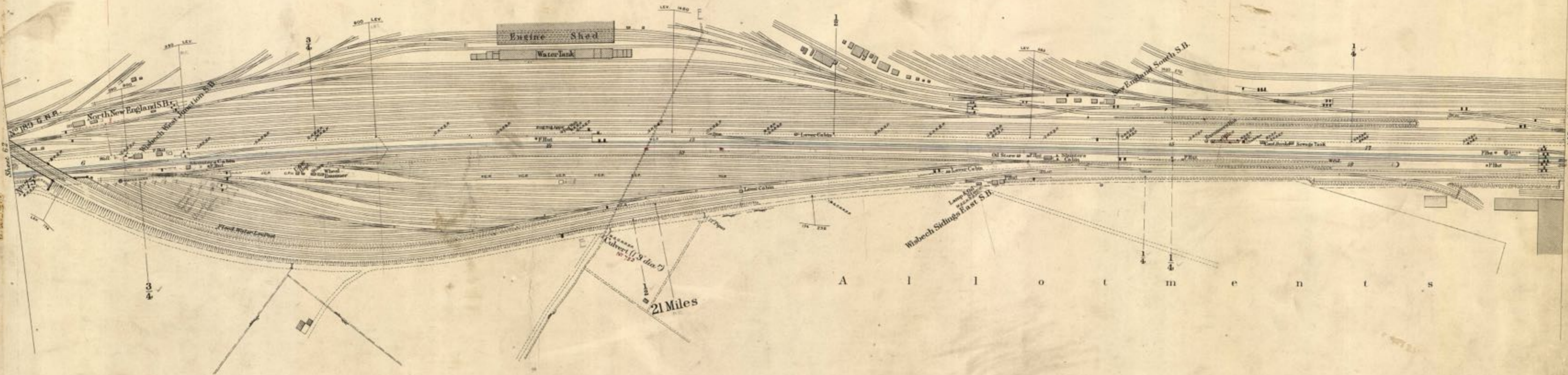

A l l o t m e n t s

New England

Scale, 2 Chains to an Inch.

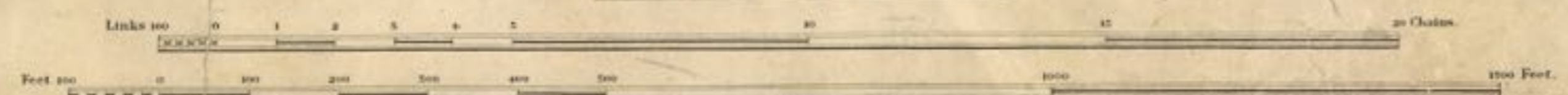

S O K E O F P E T E R B O R O U G H

SYSTON & PETERBOROUGH.
SHEET 64.

C I T Y A N D B O R O U G H O F P E T E R B O R O U G H

P A R I S H O F P E T E R B O R O U G H W I T H I N

F O R M E R L Y

C O U N T Y O F N O R T H A M P T O N

F O R M E R L Y

P A R I S H O F S T J O H N T H E B A P T I S T

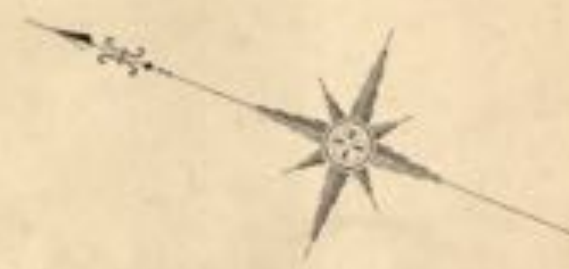

PETERBOROUGH STATION
(G. N. R.)

3 1/2 dia. Steel pipe containing electric cable
laid by the Post Office, February 1928.
5'-0" from North square, 12" deep.
S.D. 4426/28. E.M. 24/27.

6" Gas Main laid by Peterborough Gas Co. about 1899.
No Agreement found.
6" Water Main laid by Peterborough Corporation
in Sept 1885 under Agreement dated 16th 1884.

8" Water Main, Peterborough Corporation.
Date laid not known, no Agreement found.

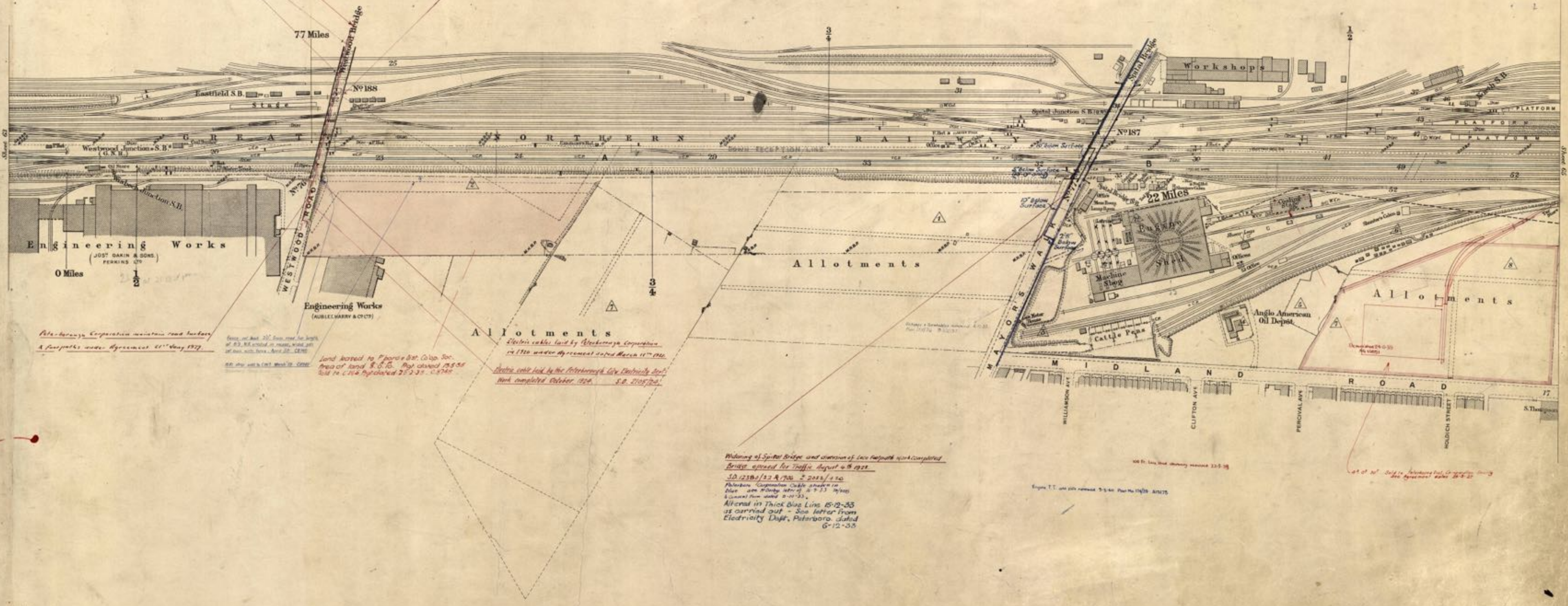

Peterborough Corporation maintain road between
4 feet path under Agreement 21st Aug 1877.

From act No. 27, from road for length
of 22.58 erected in 1884, with 20 ft
off from north side, April 20, 1885.

Land leased to Florio & Co. 100 sq
area of land 8.6.10. Not cleared 1933
sold to C. H. A. Hyatt 27.2.33. C. 8746

Allotments
Electric cables laid by Peterborough Corporation
in 1910 under Agreement dated March 11th 1910.

Electric cable laid by Peterborough City Electricity Dept.
Work completed October 1926. S.D. 2105/26.

Widening of Spirit Bridge and diversion of face pathwork completed
Bridge opened for traffic August 6th 1921.
S.D. 12386/22 R. 1700. 2. 2022/170
Peterborough Corporation Cable shown in
blue on Map of 1875 & 753 2/1000
& covered from 1875 to 1921.
Altered in Thick Blue Line 15-12-33
as carried out - See letter from
Electricity Dept. Peterboro. dated
6-12-33.

Scale, 2 Chains to an Inch.

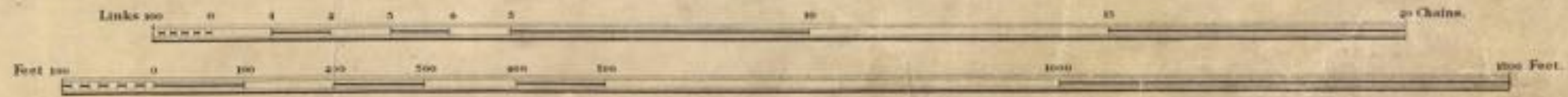

SURVEYED Nov. 1920.
Estate Agent's Office
Midland Railway,
Derby.

S O K E O F P E T E R B O R O U G H
C I T Y A N D B O R O U G H O F P E T E R B O R O U G H
P A R I S H O F P E T E R B O R O U G H W I T H I N
F O R M E R L Y
C O U N T Y O F N O R T H A M P T O N
F O R M E R L Y
P A R I S H O F S T J O H N T H E B A P T I S T

SYSTON & PETERBOROUGH.
 SHEET 65.

*Peterborough Station. Signal Works
 complete. March 14th 1923. E. J. H. 413.
 S.D. 866/43.*
PETERBOROUGH STATION
 (G. E. R.)

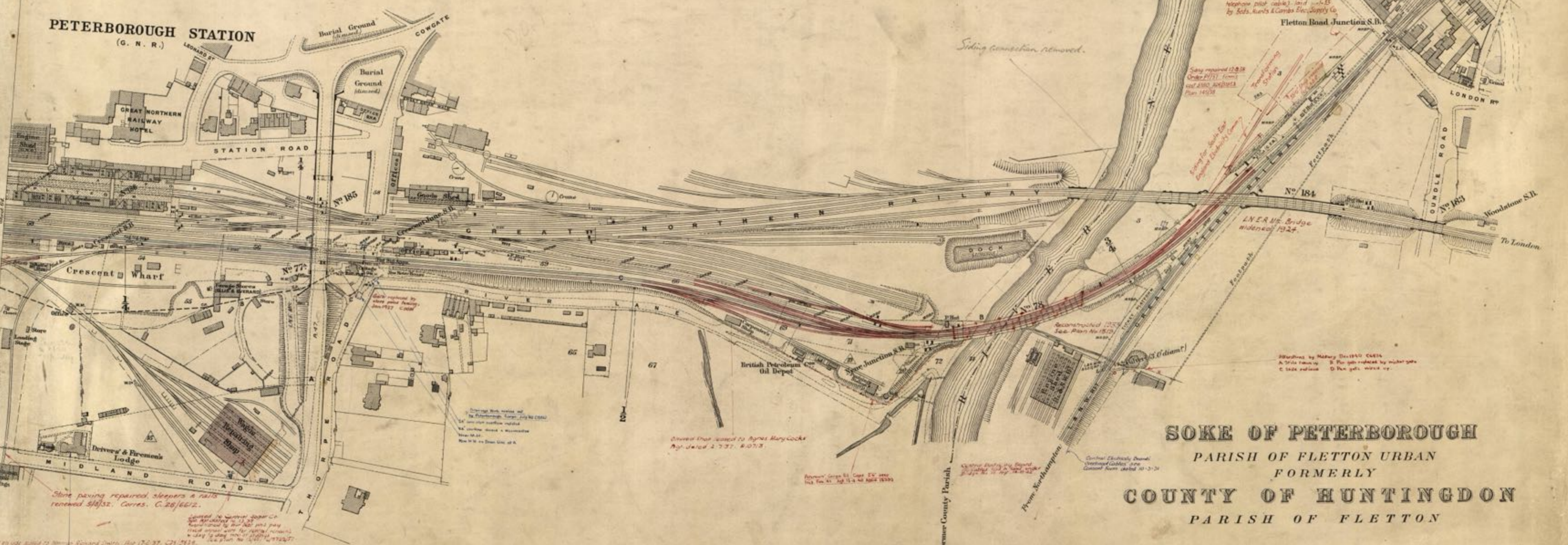

SOKE OF PETERBOROUGH
PARISH OF FLETON URBAN
FORMERLY
COUNTY OF HUNTINGDON
PARISH OF FLETON

Scale, 2 Chains to an Inch.

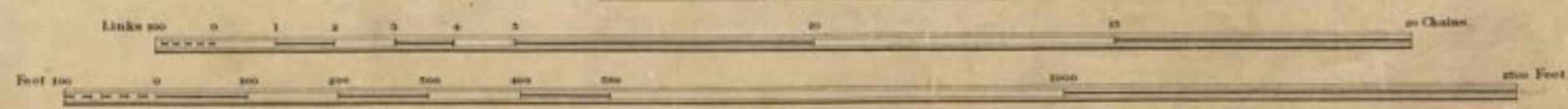

SURVEYED Nov. 1926.
 Estate Agents Office
 Midland Railway
 Dept.