

# MIDLAND RAILWAY.

## MANGOTSFIELD AND BATH

## BRANCH







## LAND PLAN.

Surveyed by  
P. S. McCallum,  
Estate Agent,  
DERBY.

1905.

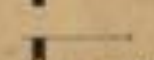
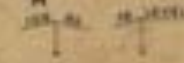
### Reference.

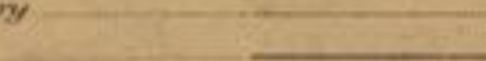
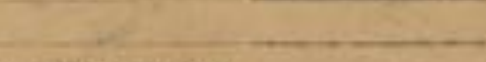
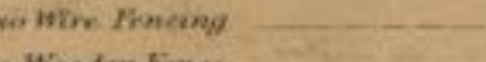







SIGNALS, &c. The Signals are shown as they appear to view

Semaphores    
Distant Signals    
Gradient Posts are shown thus   
FENCES Quick Fence is shown thus   
Ditch or Boundary   
Wall   
Iron Fencing   
Post and Rail also Wire Fencing   
Sleeper, Close Pale, Wooden Fence 

### Titles of Acts.

The Midland Railway (Bath & Thornbury Lines)	-	-	Act 1864—27 & 28 Vict.	Royal Assent 14th July, 1864.
Do. (Additional Powers) Widening of Street	-	-	Act 1867—30 & 31 Vict.	Do. 12th August, 1867.
Do. ( Do. ) Extension of time	-	-	Act 1869—32 & 33 Vict.	Do. 12th July, 1869.

COLOURING.

The Company's FREEHOLD Property is shown by RED Colour	
Do. LEASEHOLD do. RED EDGE ONLY	
Property owned JOINTLY with other Companies GREEN Colour	
Do. over or through which the Company has an EASEMENT is shown by RED dotted lines.	
Do. over or through which the Company has granted an EASEMENT is shown by PURPLE dotted lines.	
Do. granted on LEASE by the Company by RED Full lines	
Do. SOLD or otherwise disposed of by the Company is shown by PURPLE colour.	
MINERALS specially purchased by the Company shown by BLUE Full Lines.	
Do. SOLD or otherwise disposed of by the Company shown by PURPLE Full Lines.	

NOTE—Vendors Names are written in block as VENDOR.  
The figures within the circle after the names of the Vendors refer to the numbers on the deeds relating to the purchase.  
The slanting figures as 20 refer to Parliamentary numbers; Original Act Do. within a triangle as 30 are the Parliamentary numbers referring to subsequent Acts.

C O U N T Y   O F   G L O U C E S T E R

P A R I S H   O F   S I S T O N

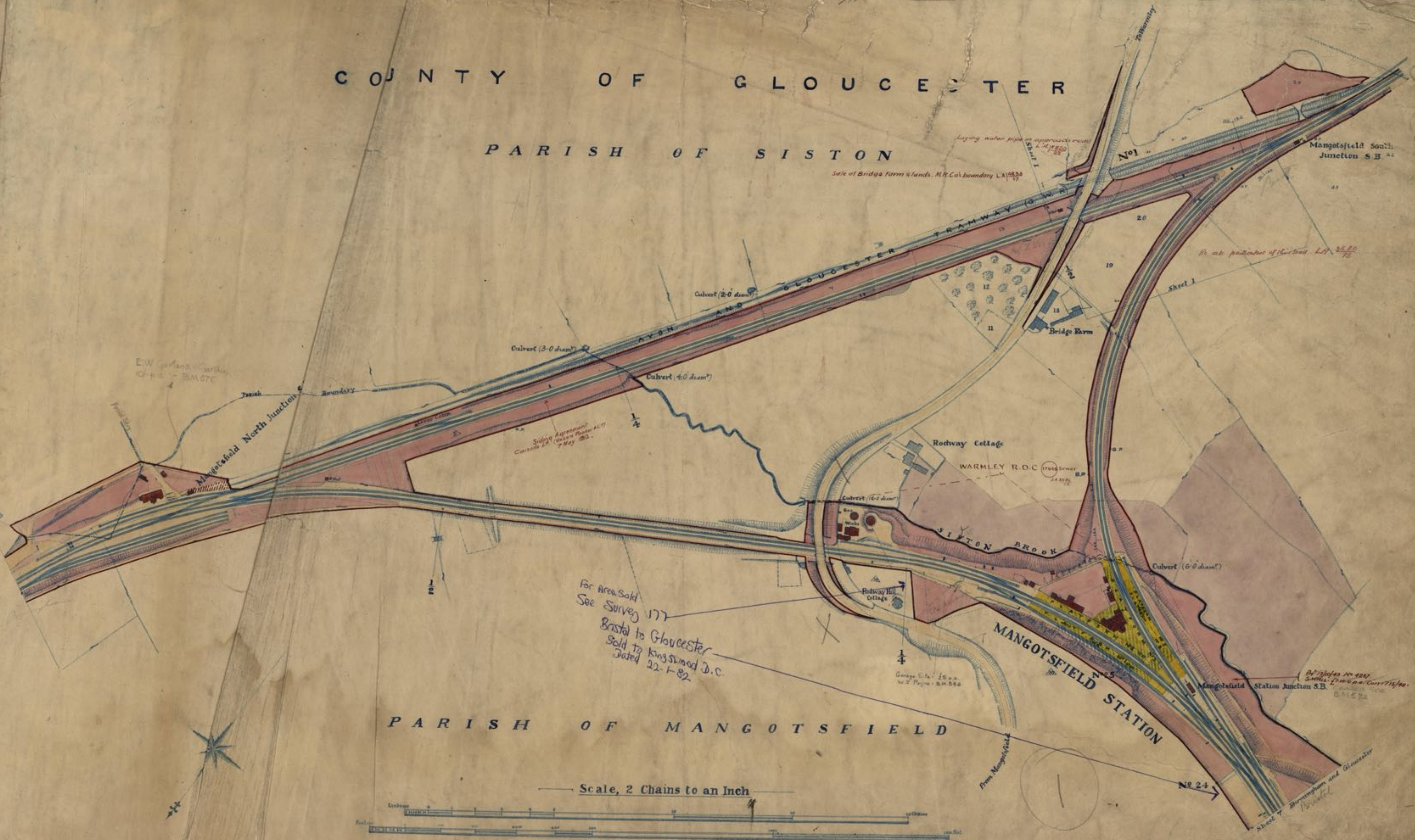

P A R I S H   O F   M A N G O T S F I E L D

Scale, 2 Chains to an Inch



5 Miles

Estates Agents Office,  
Midland Railway,  
Derby.

C O U N T Y O F G L O U C E S T E R

P A R I S H O F S I S T O N

2



Consent for overhead cable to Warmley R.D.C. dated 2.8.82

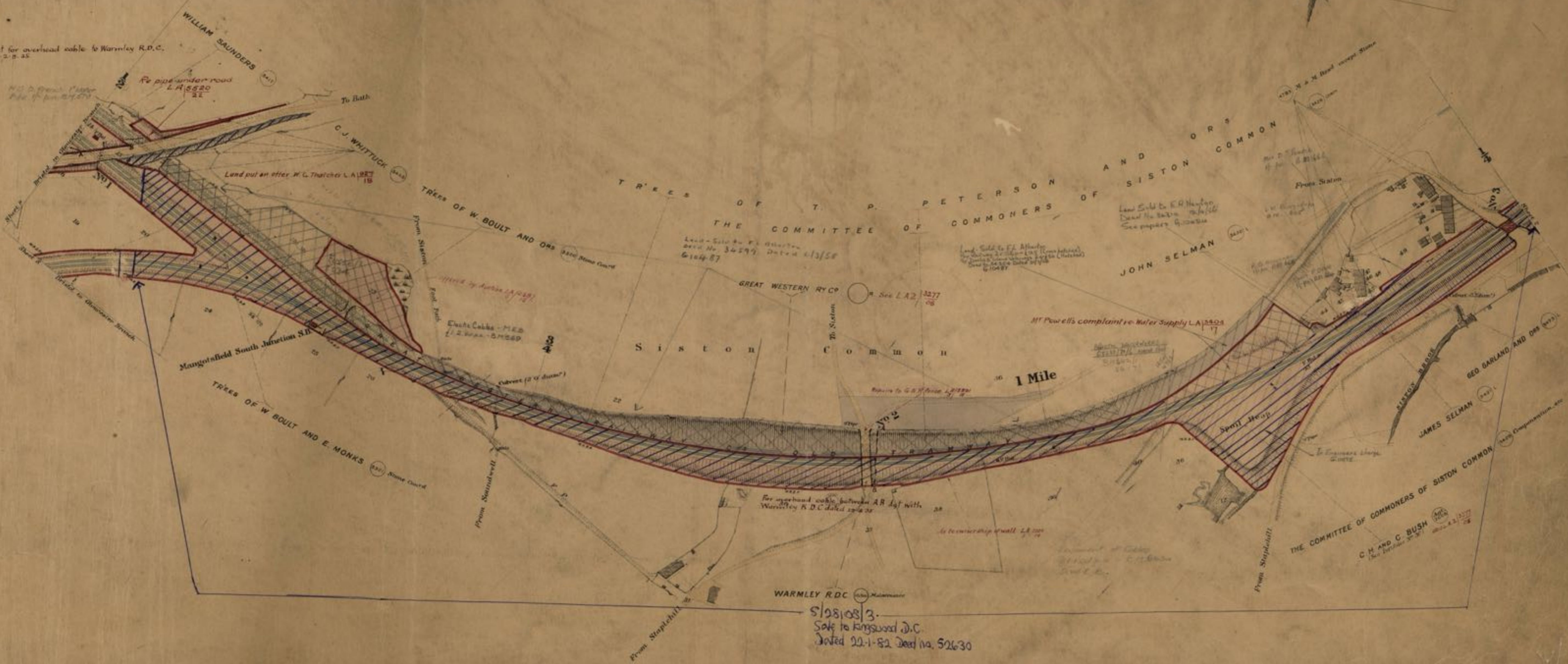

5/28/08/3.  
Sale to Kingswood D.C.  
Dated 22.1.82 Deed no. 52630

Scale, 2 Chains to an Inch.



COUNTY OF GLOUCESTER

3

PARISH OF SISTON

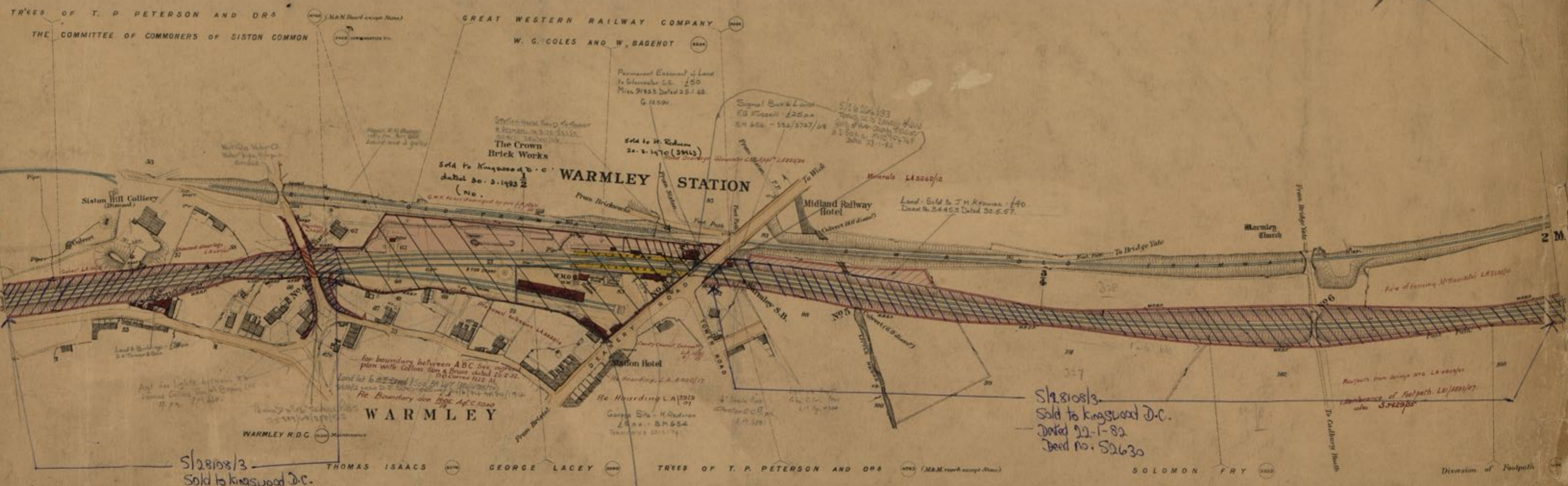

Scale. 2 Chains to an Inch.

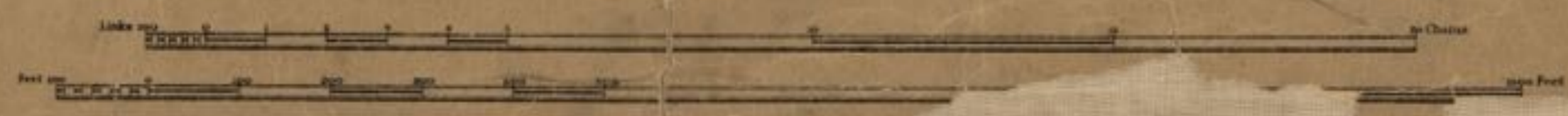

C O U N T Y O F G L O U C E S T E R

127

P A R I S H O F B I T T O N



P A R I S H O F S I S T O N

Sale of Land & Property Main Road LA1032/14

REUBEN JEFFERIS

SAMUEL LEAR

JAMES BAWN

N o r t h  
BRYCE WHITE & CO Ltd.  
(17.5.93)

Land in 177 Thimble and Boundary Comrs 182000

From-Briggs to  
To Bitton

DANIEL DORE AND MORTGEE  
GEO OLDLAND AND MORTGEE  
C. W. T. BUSH  
(TRUS OF D. DORE)

R. L. JEFFERIS AND ORS

H. BROUGHTON AND MORTGEE  
GEORGE OLLIS  
(REP OF W. CARTER)

ARETTLE (7-2-13)

MISSRS HASKINS (12.1.20)

WARMLEY R.D.C.

From Warmley  
Phillimore  
2993

EDWIN GAY

S 16764 2E  
MCS  
CABLES (1374 14C 91/100)  
10 ft per section  
CH 1/3/77

Permission to  
erect 80' high  
Education Tower  
Gas County Council  
at 1/2 p. of B. 100

SOLOMON FRY

2 Miles

REPS OF W. WATERS  
REPS OF THOS WATERS

JOHN OLIVER

REPS OF W. W. FLOWER AND J. FLOWER

A. L. BRICE AND AN

A. SHEPPARD AND ORS

Sale to Kingswood District Council  
S128108/13  
dated 22-1-82  
Deed no 52630

Scale. 2 Chains to an Inch.

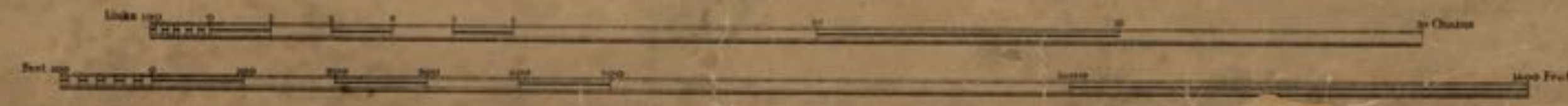

C O U N T Y O F G L O U C E S T E R

P A R I S H O F B I T T O N



4

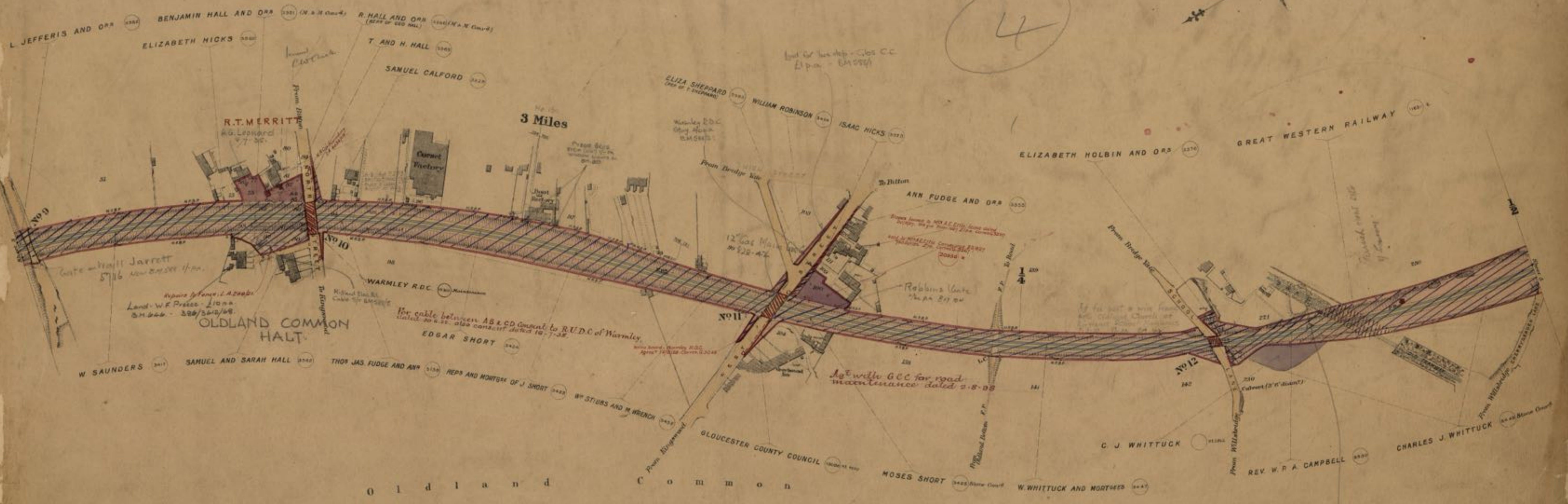

o l d l a n d c o m m o n

Sale of Land by Auction 20.2.19 L.A.

Scale, 2 Chains to an Inch.

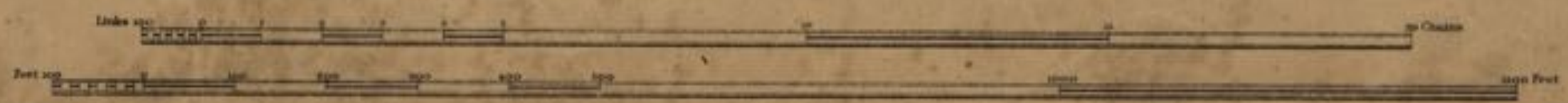

52020/49  
I. W. SMITH  
CHARTERED SURVEYOR  
110, Park Lane, W. 1  
25/10/17

Office and Railway Dept.

C O U N T Y O F G L O U C E S T E R

P A R I S H O F B I T T O N

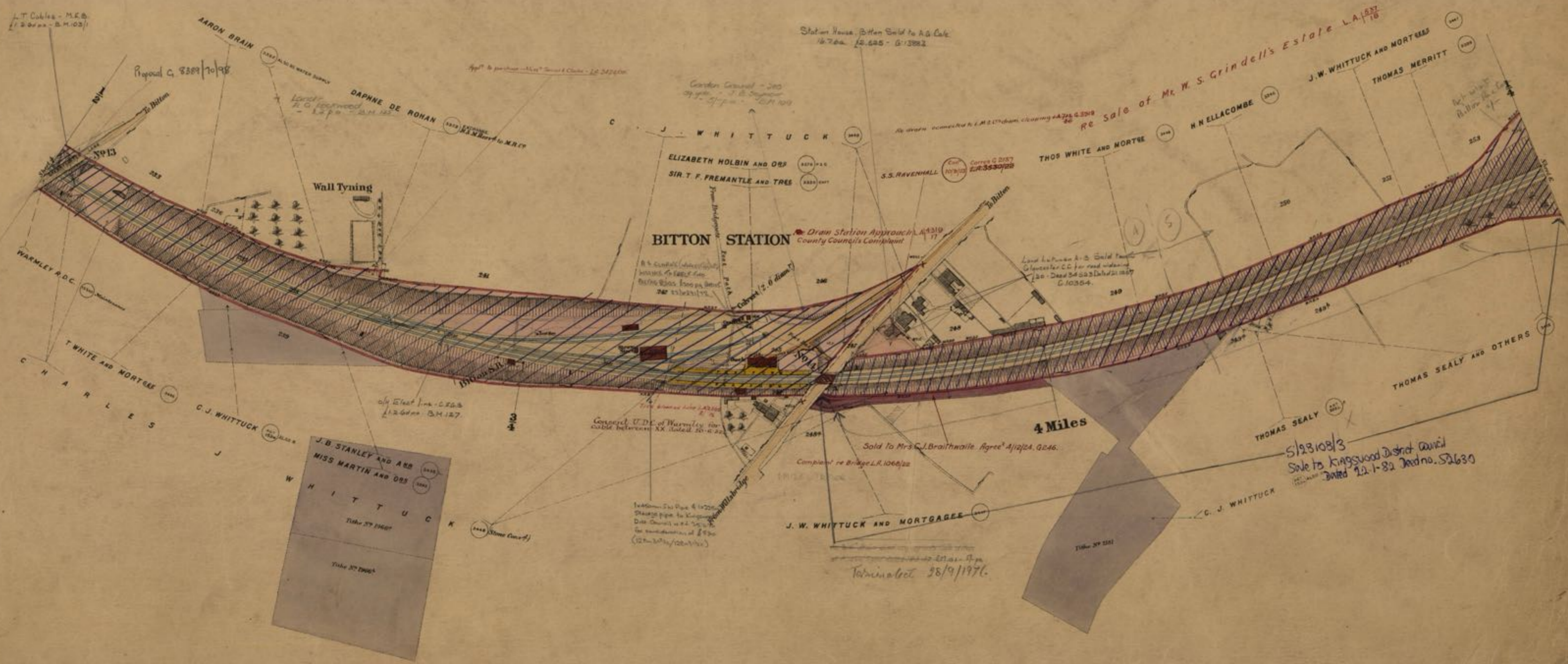

Scale. 2 Chains to an Inch.

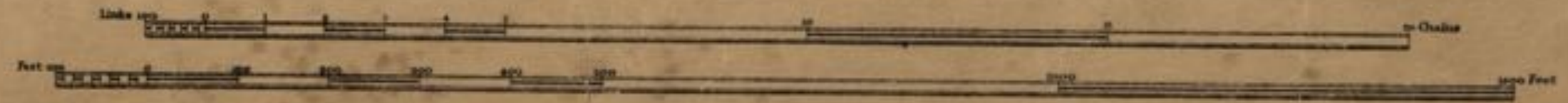

Estate Agents Office  
Midland Road  
Derby

C O U N T Y O F G L O U C E S T E R

P A R I S H O F B I T T O N



Re Sale of Mr. W. S. Grindell's Estate L.A. 1887

Sale of Land by Auction 26-2-1881

THOMAS SEALY AND OFF

J. W. WHITTUCK AND MORTGEE

Sale of Canon Ellacombe's Estate L.R. 1887/16

5 Miles

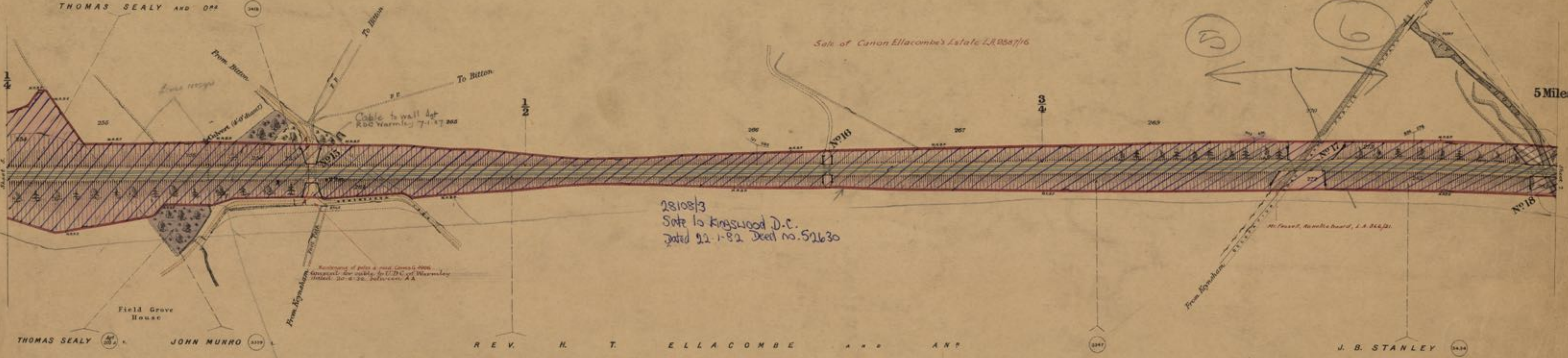

28108/3  
Sale to Kingswood D.C.  
Dated 22-1-82 Deed no. 52630

REV. H. T. ELLACOMBE

J. B. STANLEY

THOMAS SEALY

JOHN MUNRO

52584/1  
SUN ALLIANCE  
WATER PIPES  
1880 p/a

Scale, 2 Chains to an Inch.

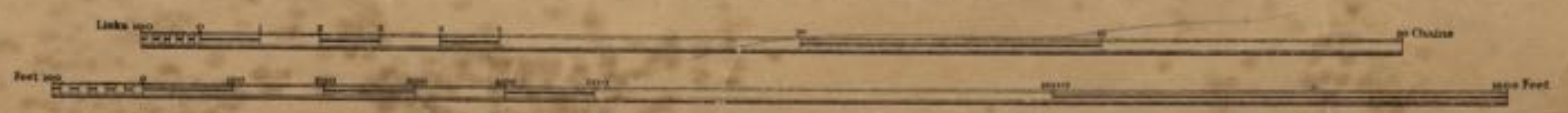

Estate Agent



COUNTY OF GLOUCESTER  
PARISH OF BITTON

C O U N T Y     O F     S O M E R S E T

P A R I S H     O F     S A L T F O R D

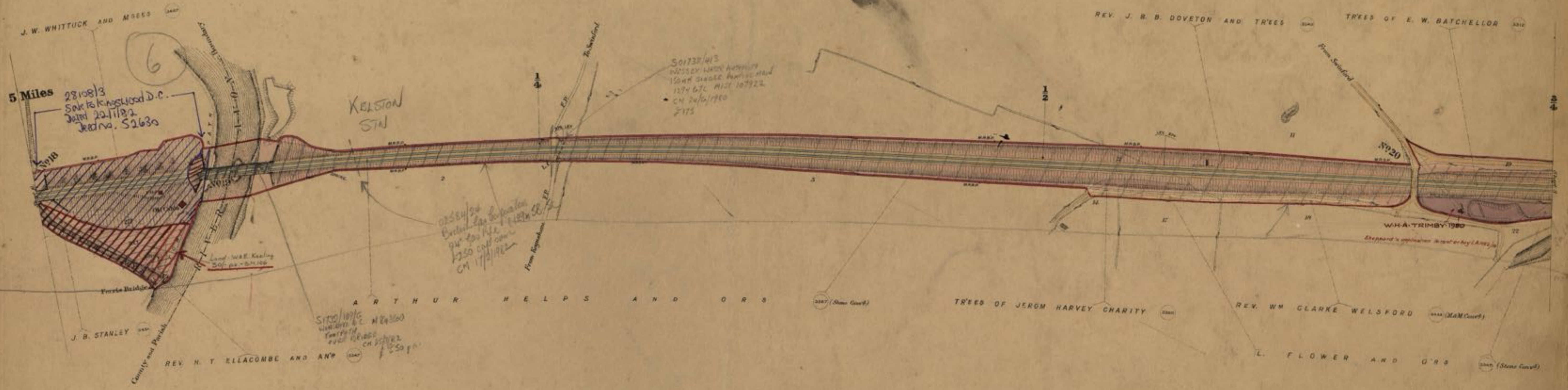

5 Miles  
28108/3  
Sink to Kingswood D.C.  
Jurat 20.11.82  
Jedno. 52630

S01737/413  
WESLEY WALK HOSPITAL  
1500ft 3000ft 4000ft 5000ft  
1274 67c 1121 10722  
CH 24/6/1780  
2175

02554/04  
Circuit for the  
1400 400 1122  
1230 000 000  
CH 17/1/1922

Land of E. Keeling  
S01-62-54.100

S100/1076  
WENTWORTH & CO. N 24/100  
TUNNEY  
S01-62-54.100  
CH 17/1/1922

Scale, 2 Chains to an Inch.

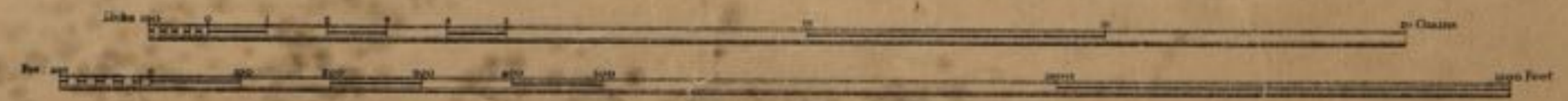

C O U N T Y O F S O M E R S E T

P A R I S H O F K E L S T O N

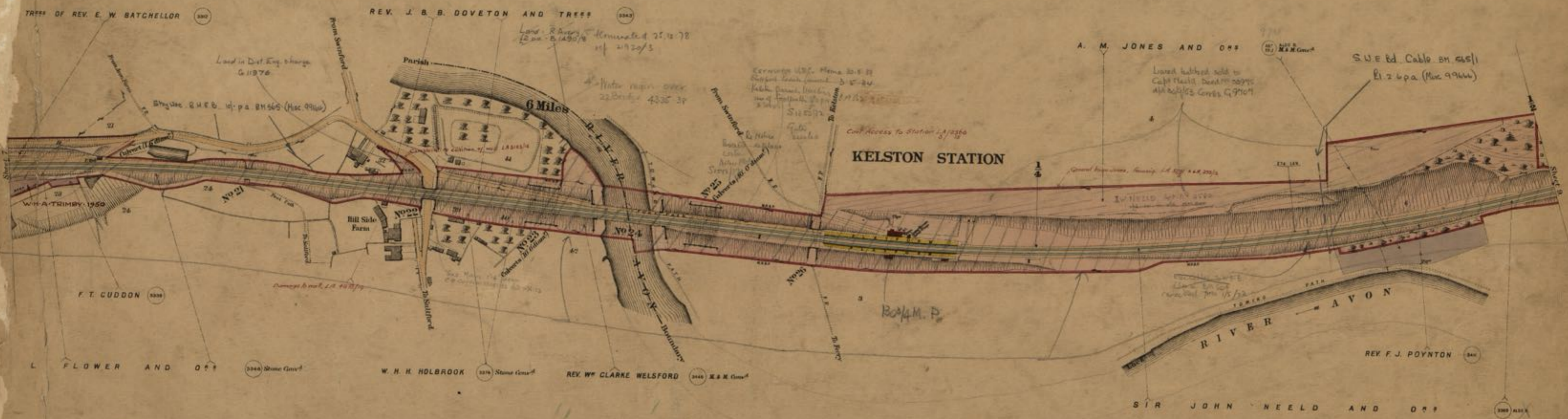

P A R I S H O F S A L T F O R D

Scale. 2 Chains to an Inch.

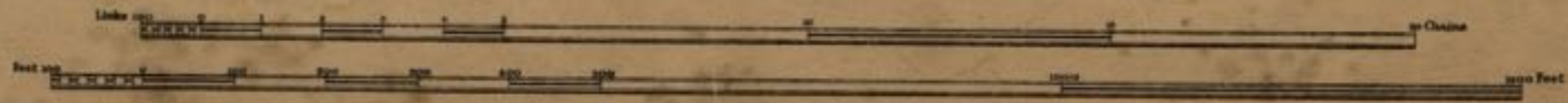

Estate A...

C O U N T Y O F S O M E R S E T

P A R I S H O F K E L S T O N

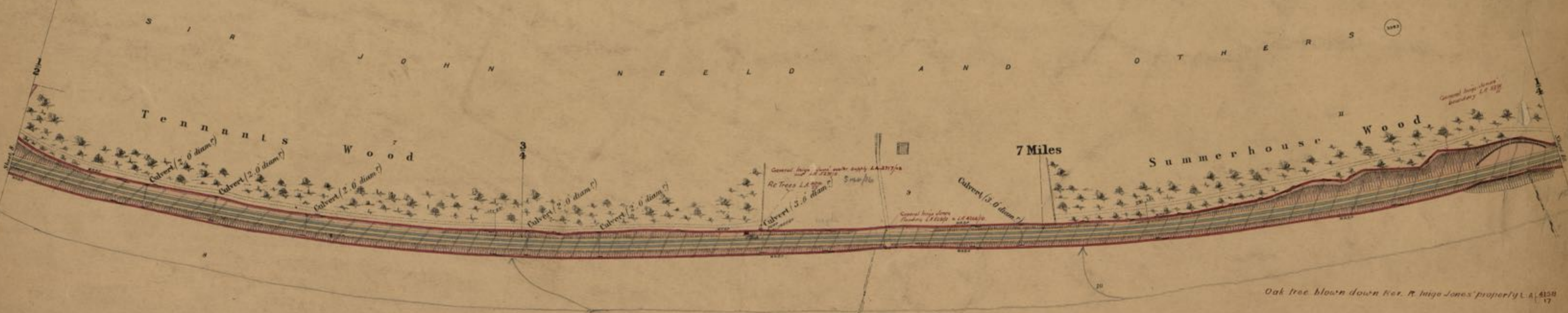

Scale, 2 Chains to an Inch.

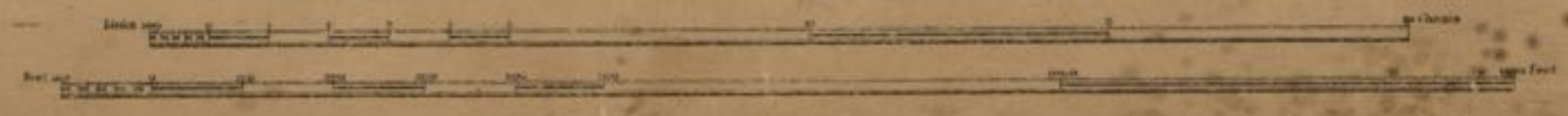

C O U N T Y O F S O M E R S E T

P A R I S H O F K E L S T O N

P A R I S H O F N E W T O N S T L O E

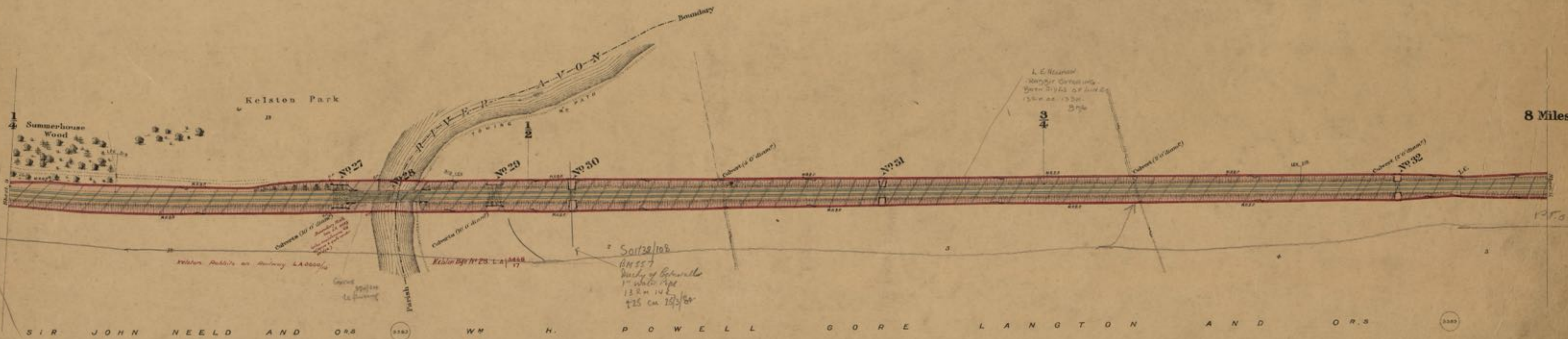

8 Miles

S I R J O H N N E E L D A N D O R S      W M H . P O W E L L G O R E L A N G T O N A N D O R S

Scale, 2 Chains to an Inch.

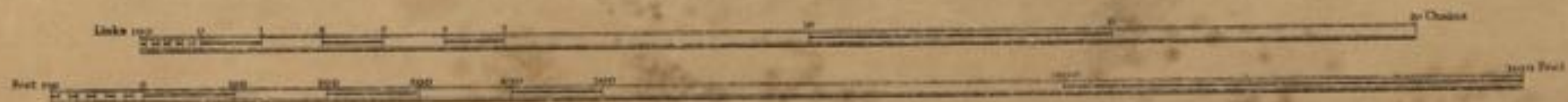

Estab. of Office, Midland Railway, Derby

COUNTY OF SOMERSET

PARISH OF NEWTON ST LOE

PARISH OF WESTON

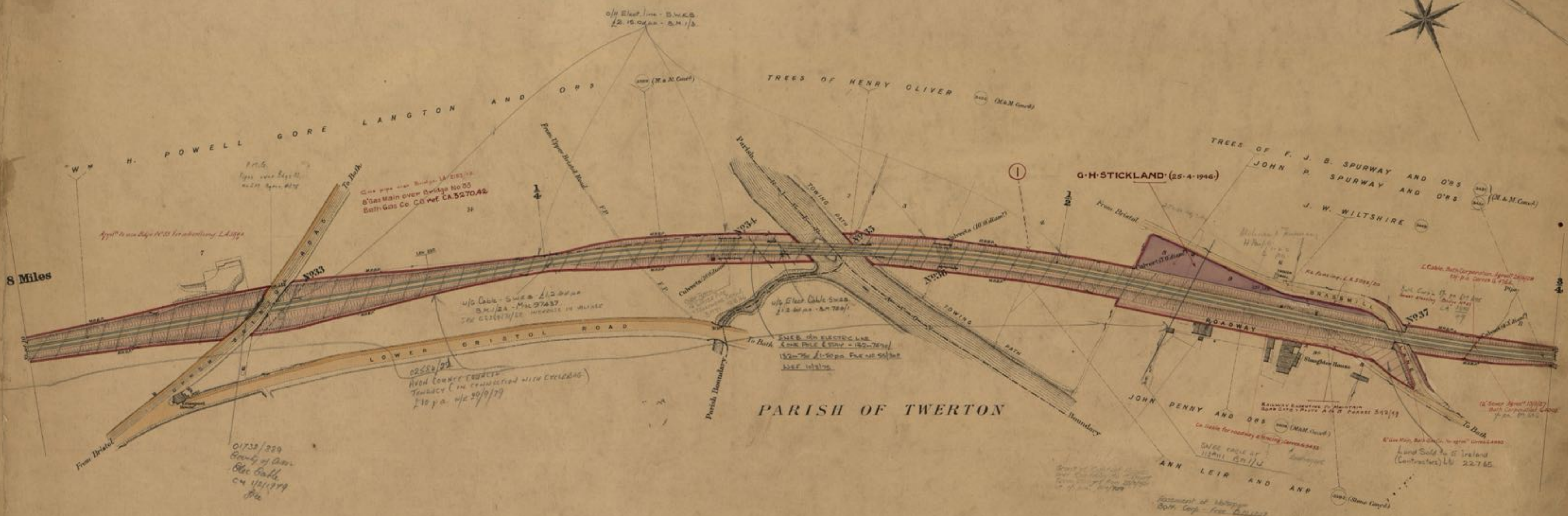

8 Miles

PARISH OF TWERTON

Scale, 2 Chains to an Inch.

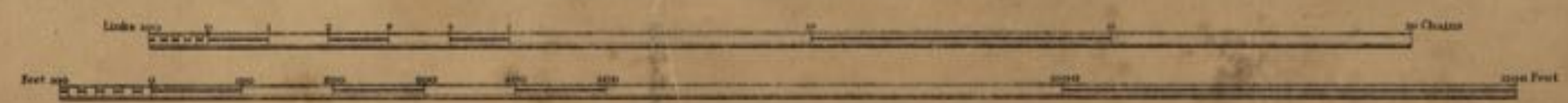

Estate Agents Office, M. J. and R. J. ...

COUNTY OF SOMERSET

PARISH OF WESTON

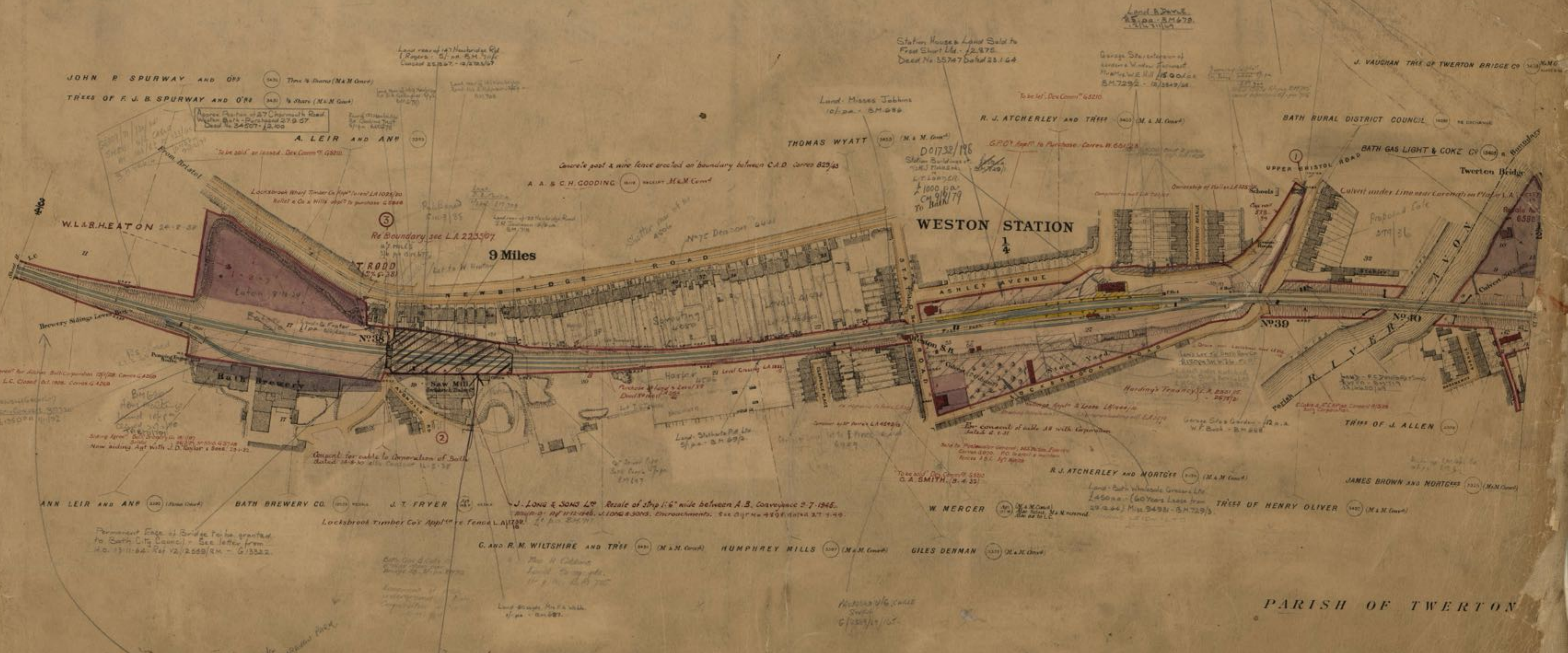

501732/420  
HARTWELLS LTD  
GAVE 24/8/1982  
DEED 52925

Scale, 2 Chains to an Inch.



PARISH OF TWERTON

Es. Agents (M)

PARISH OF WESTON

PARISH OF TWERTON

PARISH OF BATH

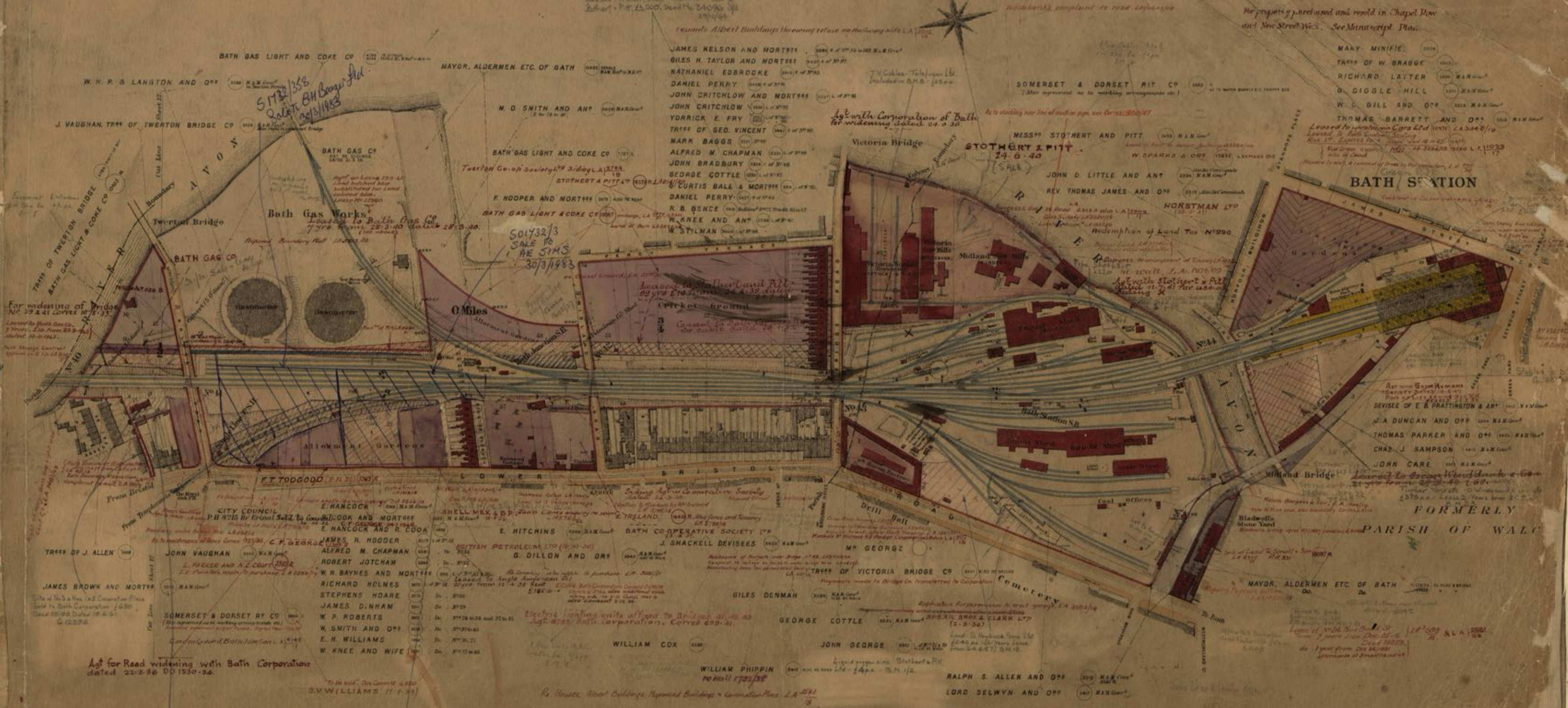

Handwritten notes in the top left corner:   
S.M. 358   
Sale to B.M. Bagnall   
29/11/1883

Handwritten notes in the center:   
501732/3   
SALE TO   
BE SIMS   
30/3/1883

For widening of bridge   
No. 29 & 41 L.P. 1875-76

As for Road widening with Bath Corporation   
dated 22-2-86 D.D. 1850-54

Handwritten notes at the bottom left:   
01732/3631   
Bath City Council   
Grant to B.M. Bagnall   
800/- for fuel drain   
Bath 11/6/1880

Scale, 2 Chains to an Inch

FORMERLY   
PARISH OF LYNCOMBE & WIDCOMBE