

# MIDLAND RAILWAY.

## LONDON & BEDFORD LINE

### (LUTON TO BEDFORD)

## LAND PLAN.

### Titles of Acts.

The Midland Railway	(London Station) - - -	St. Pancras Goods Branch, North London Incline - - -	Act 1860—23 & 24 Vict.	Royal Assent 25th May 1860.
Do.	(Extension to London) - - -	Main Line and Branches - - -	Act 1863—26 & 27 Vict.	do. 22nd June 1863.
Do.	(St. Pancras Branch) - - -	Branches and Deviations, Roads, etc. - - -	Act 1864—27 & 28 Vict.	do. 25th July 1864.
Do.	(New Lines & Additional Powers)			
Do.	( Do. do. )	St. Pancras Goods Station Branch, Hendon Roads - - -	Act 1865—28 & 29 Vict.	do. 5th July 1865.
Do.	(Branches, etc.) - - -	Diversions & Improvements of Roads. Deviation of G. N. Rly. near Luton	Act 1866—29 & 30 Vict.	do. 30th July 1866.
Do.	(Additional Powers) - - -	Extension of Powers (St. Pancras Branch) - - -	Act 1866—29 & 30 Vict.	do. 11th June 1866.
Do.	( Do. ) - - -	St. Pancras connecting line. (Metropolitan Railway Co.'s Agt.)	Act 1868—31 & 32 Vict.	do. 25th June 1868.
Do.	( Do. ) - - -	Removal of roof of Railway, Camden Square - - -	Act 1870—33 & 34 Vict.	do. 20th June 1870.
Do.	( Do. ) - - -	St. Pancras connecting line - - -	Act 1875—38 & 39 Vict.	do. 29th June 1875.
Do.	(Further Powers) - - -	Agreement with Metropolitan District Railway Co. - - -	Act 1877—40 & 41 Vict.	do. 12th July 1877.
Do.	(Additional Powers) - - -	Belsize Second Tunnel and Tottenham & Hampstead North Curve	Act 1880—43 & 44 Vict.	do. 6th Aug. 1880.
Do.	( Do. ) - - -	Do. and Hendon Crossing - - -	Act 1881—44 & 45 Vict.	do. 18th July 1881.
Do.	- - -	Hendon Crossing (Extension of time). Hendon Road - - -	Act 1886—49 & 50 Vict.	do. 25th June 1886.
Do.	- - -	St. Pancras Widening - - -	Act 1889—52 & 53 Vict.	do. 24th June 1889.
Do.	- - -	Bedford Curve, St. Pancras Widening. New Street - - -	Act 1890—53 & 54 Vict.	do. 25th July 1890.
Do.	(Additional Powers) - - -	Elstree and Ampthill Second Tunnels - - -	Act 1892—55 & 56 Vict.	do. 28th June 1892.
Do.	- - -	Childs Hill Bridge Widening - - -	Act 1893—56 Vict.	do. 9th June 1893.
Do.	- - -	Camden Town & Kentish Town Widening, Kentish Town Curve, New St.	Act 1894—57 & 58 Vict.	do. 20th July 1894.
Do.	- - -	St. Pancras Gardens Viaduct. (Filling up.) - - -	Act 1897—60 & 61 Vict.	do. 6th Aug. 1897.
Do.	- - -	Finchley Road and Welsh Harp Widening - - -	Act 1900—63 & 64 Vict.	do. 30th July 1900.
Do.	- - -	Hendon New Road - - -	Act 1904—4 Edward VII.	do. 24th June 1904.
Do.	- - -	Luton Widening of Bridge - - -	Act 1906—6 Edward VII.	do. 20th July 1906.

### Reference.

SIGNALS, &c. The Signals are shown as they appear to view

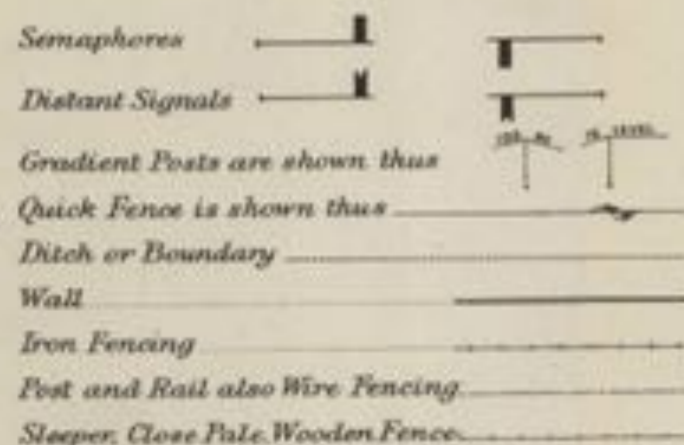

Surveyed by  
*P. J. McCallum*  
 Estate Agent  
 Derby  
 1909.

**COLOURING.** The Company's **FREEHOLD** Property is shown by **RED** Colour  
 Do. **LEASEHOLD** do. **RED EDGE ONLY**  
 Property owned **JOINTLY** with other Companies **GREEN** Colour  
 Do. over or through which the Company has an **EASEMENT**  
 is shown by **RED** dotted lines.  
 Do. over or through which the Company has granted an  
**EASEMENT** is shown by **PURPLE** dotted lines.  
 Do. granted on **LEASE** by the Company by **RED** Full lines.  
 Do. **SOLD** or otherwise disposed of by the Company is shown  
 by **PURPLE** colour.  
**MINERALS** specially purchased by the Company shown by **BLUE**  
 Full lines.  
 Do. **SOLD** or otherwise disposed of by the Company shown  
 by **PURPLE** Full lines.

**NOTE.**— Vendors' Names are written in block as **VENDOR**.  
 The figures within the circle after the names of the Vendors  
 refer to the numbers on the deeds relating to the purchases &c.  
 The slanting figures as 20 refer to Parliamentary numbers /Original Act/  
 Do. within a triangle as 20, are the Parliamentary  
 numbers referring to subsequent Acts.

1907-5/1180.1

C O U N T Y O F B E D F O R D

P A R I S H O F L U T O N

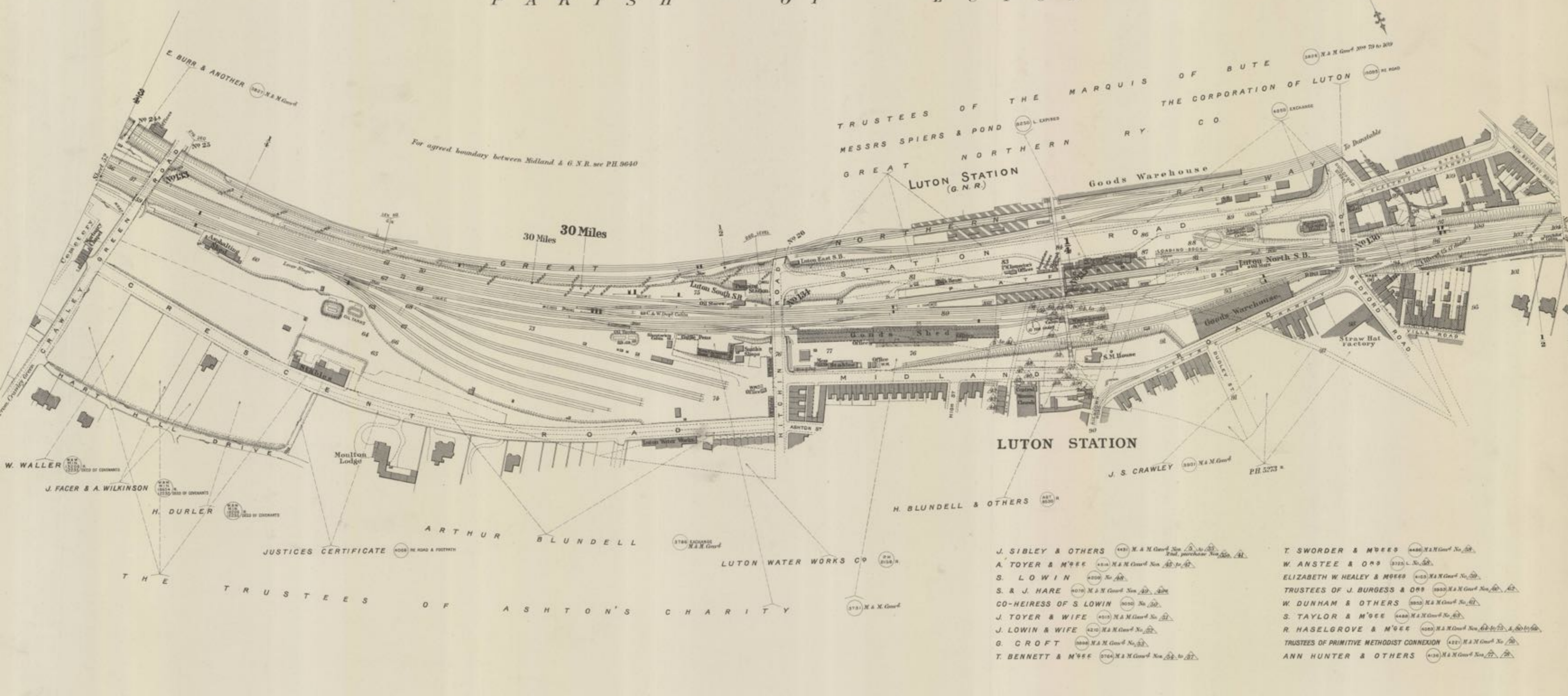

For agreed boundary between Midland & G.N.R. see PH.9640

30 Miles

- J. SIBLEY & OTHERS
- A. TOYER & M<sup>rs</sup>EE
- S. LOWIN
- S. & J. HARE
- CO-HEIRESS OF S. LOWIN
- J. TOYER & WIFE
- J. LOWIN & WIFE
- G. CROFT
- T. BENNETT & M<sup>rs</sup>EE
- T. SWORDER & M<sup>rs</sup>EE
- W. ANSTEE & O<sup>rs</sup>
- ELIZABETH W. HEALEY & M<sup>rs</sup>EE
- TRUSTEES OF J. BURGESS & O<sup>rs</sup>
- W. DUNHAM & OTHERS
- S. TAYLOR & M<sup>rs</sup>EE
- R. HASELGROVE & M<sup>rs</sup>EE
- TRUSTEES OF PRIMITIVE METHODIST CONNEXION
- ANN HUNTER & OTHERS

Scale, 2 Chains to an Inch.

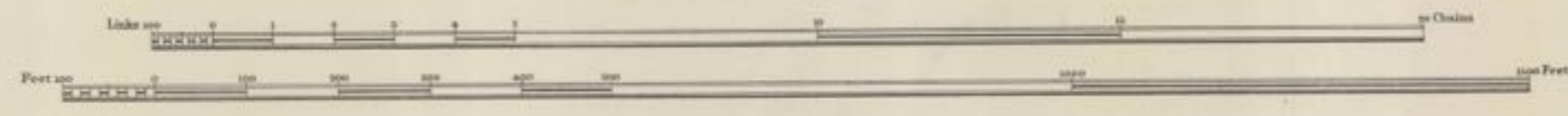

Estate Agents Office, Midland Railway, Derby.

1947-5/1180-2

C O U N T Y O F B E D F O R D

P A R I S H O F L U T O N



J O H N S A M B R O O K

C R A W L E Y

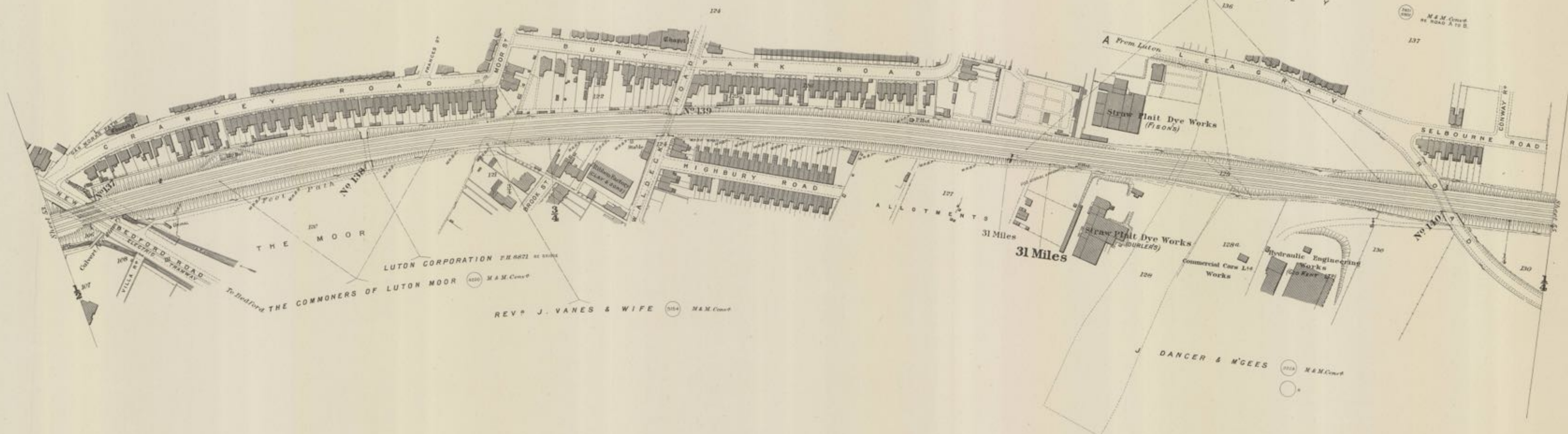

Scale. 2 Chains to an Inch.

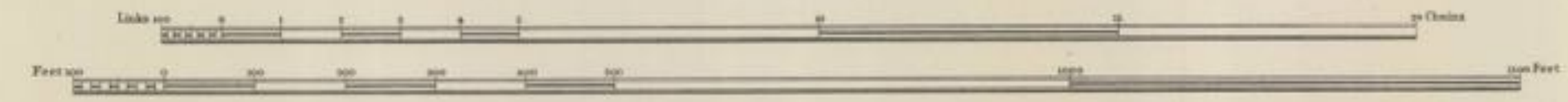

Estate Agents Office, Midland Railway Derby.

1997-5/1180.3

# COUNTY OF BEDFORD

## BOROUGH OF LUTON

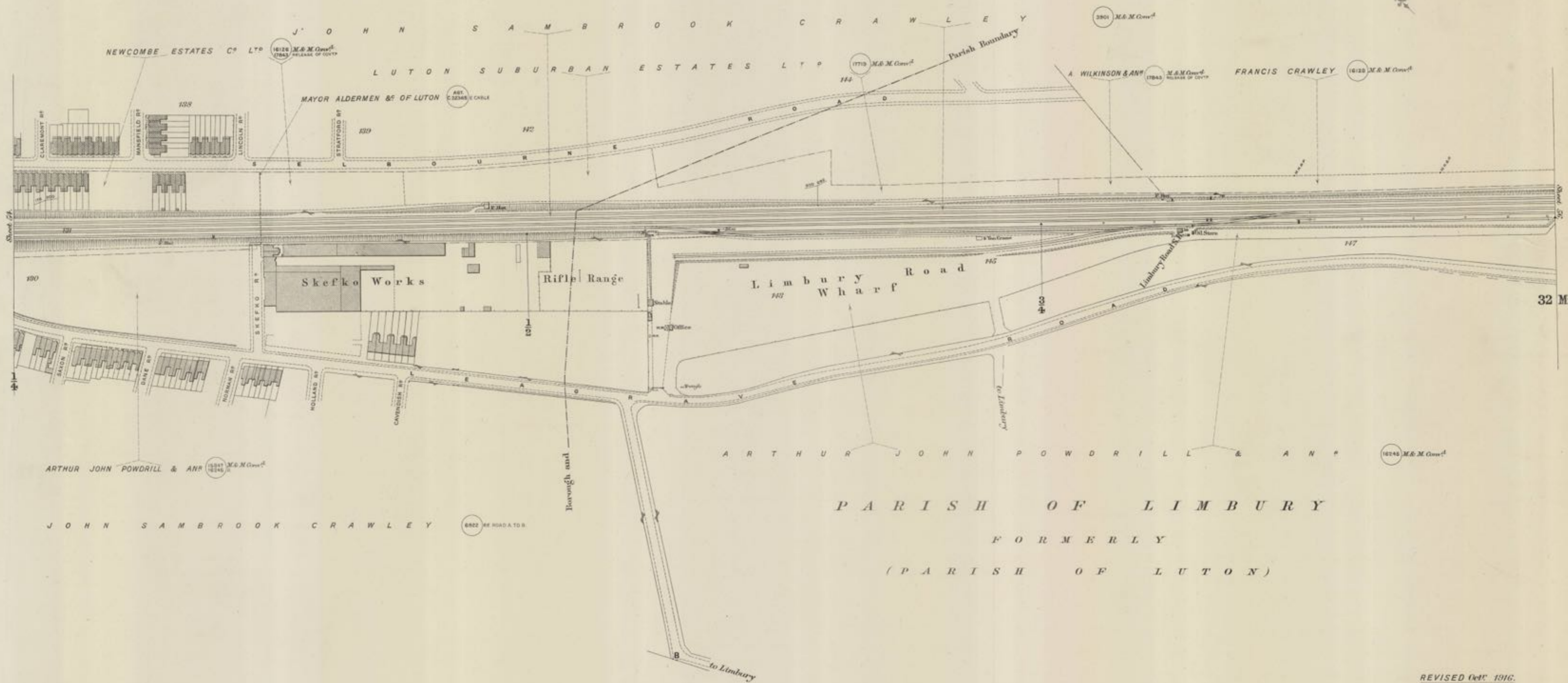
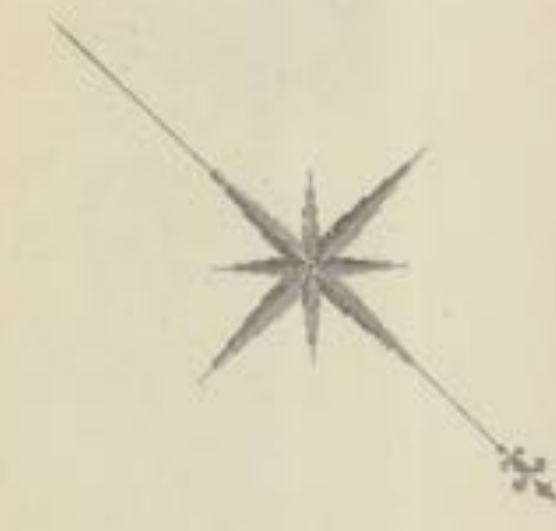

Scale, 2 Chains to an Inch.

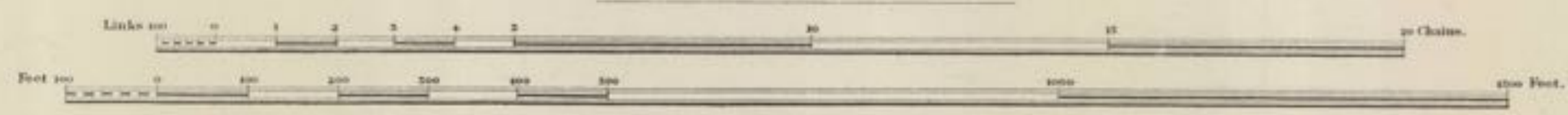

REVISED Oct. 1916.  
 Estate Agents Office,  
 Midland Railway,  
 Derby.

1937-5/180.4

C O U N T Y O F B E D F O R D

P A R I S H O F L U T O N

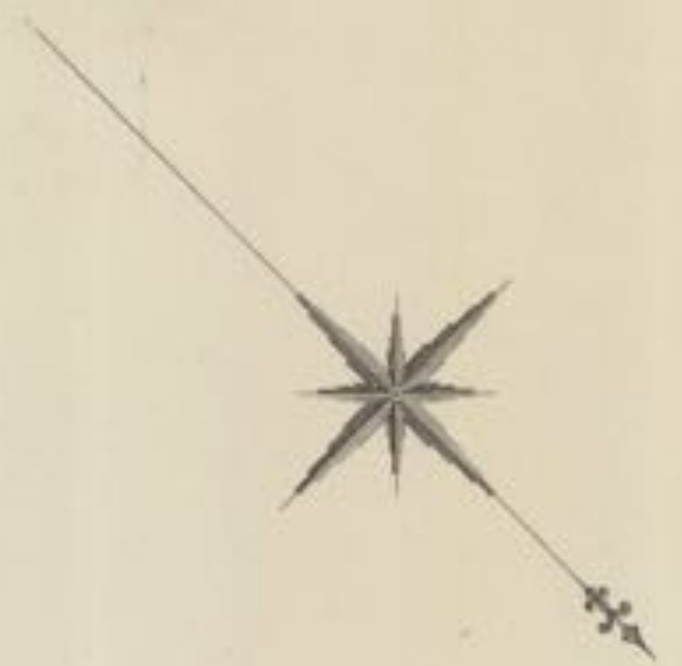

J O H N

S A M B R O O K

C R A W L E Y

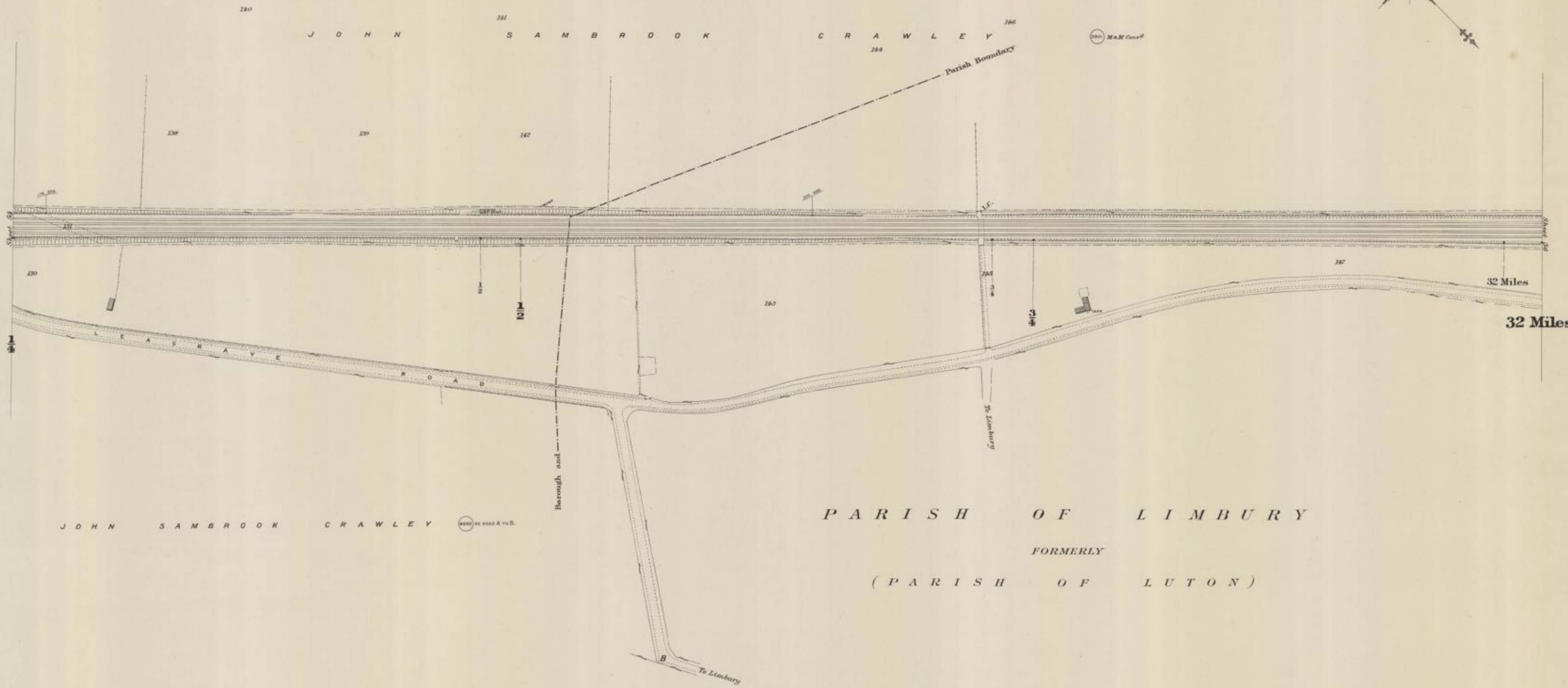
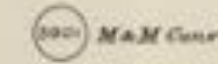

J O H N S A M B R O O K C R A W L E Y

P A R I S H O F L I M B U R Y

F O R M E R L Y

( P A R I S H O F L U T O N )

Scale. 2 Chains to an Inch.

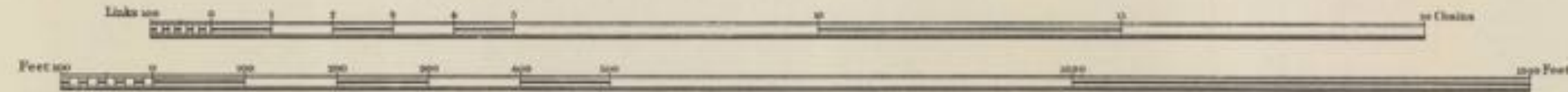

Estate Agent's Office,  
Midland Railway,  
Derby.

1997-5/1180.5

C O U N T Y O F B E D F O R D

P A R I S H O F L I M B U R Y  
FORMERLY  
(P A R I S H O F L U T O N)

P A R I S H O F L E A G R A V E  
FORMERLY  
(P A R I S H O F L U T O N) LEAGRAVE

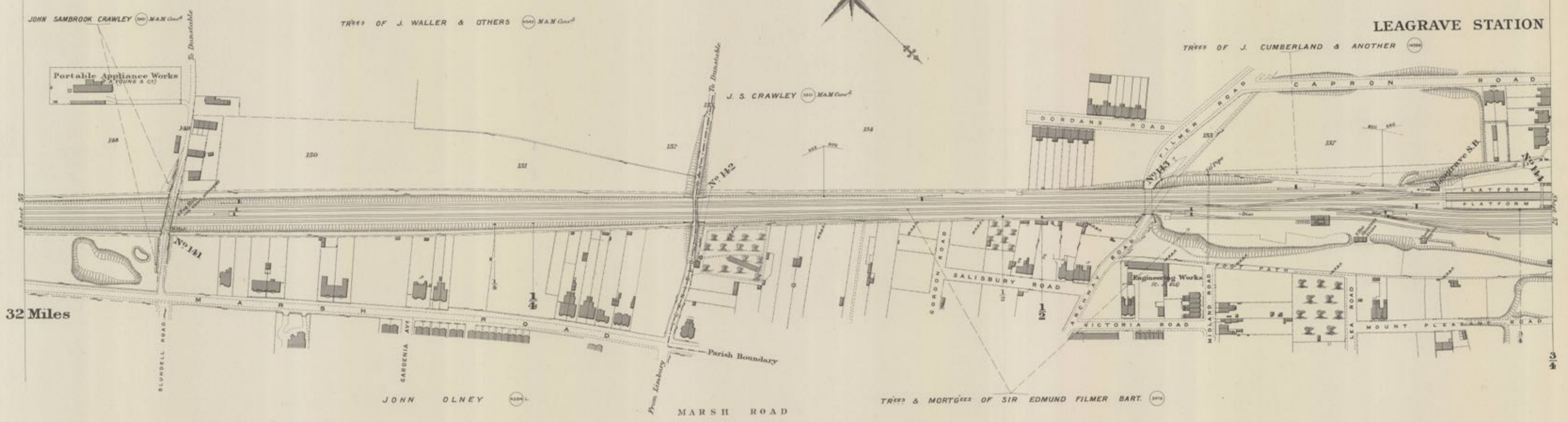

32 Miles

Scale, 2 Chains to an Inch.

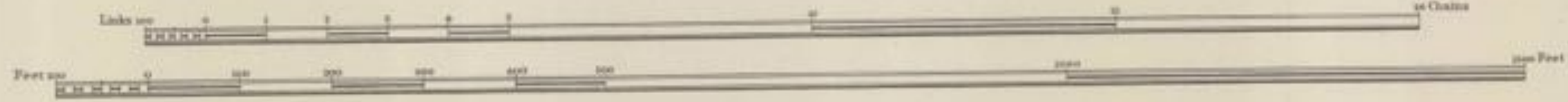

Estate Agents Office,  
Midland Railway,  
Derby.

1997-5/1180.6

C O U N T Y O F B E D F O R D

P A R I S H O F L E A G R A V E

(FORMERLY PARISH OF LUTON)

LEAGRAVE

P A R I S H O F  
T O D D I N G T O N

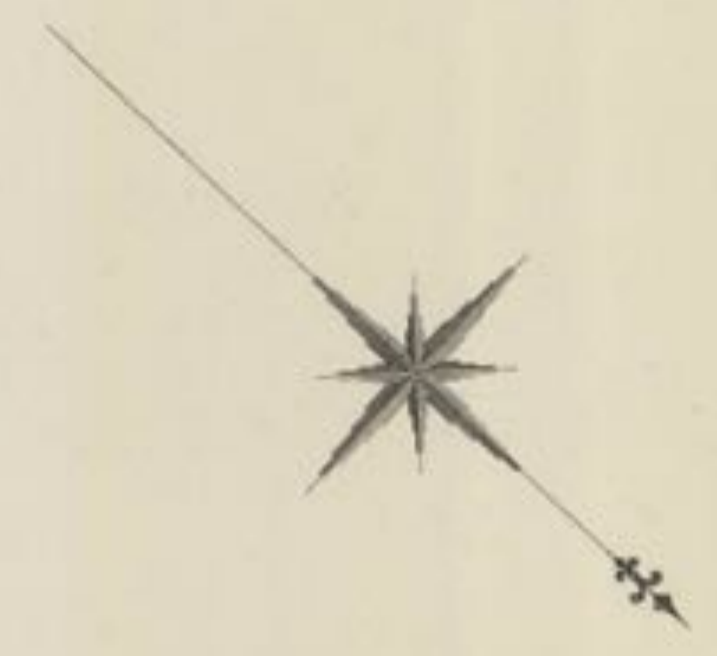

THY OF J. CURBERLAND & ANOTHER 14300  
LEAGRAVE STATION

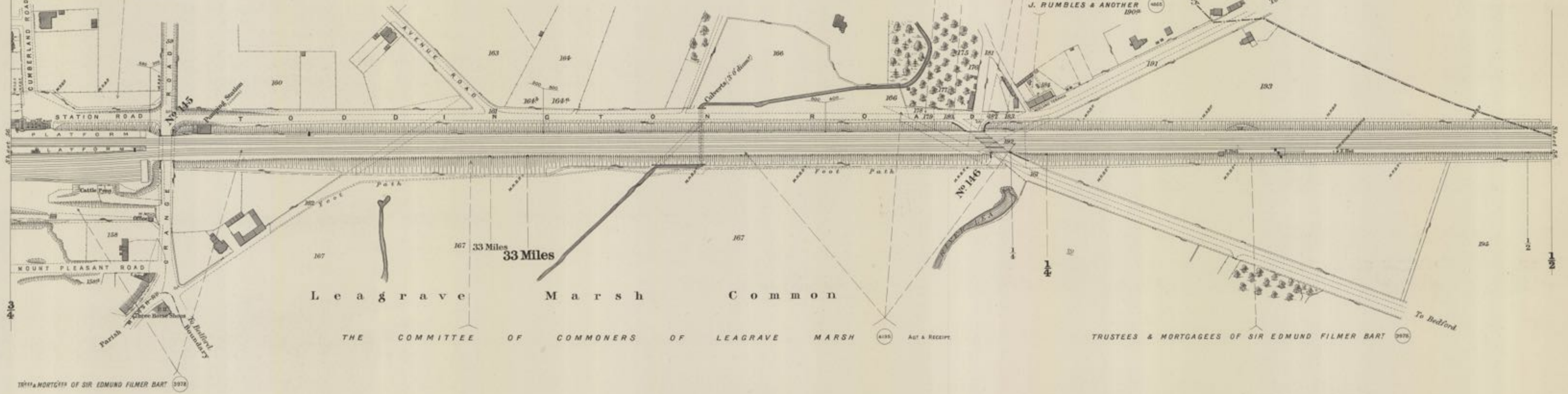

THY & MORTGEE OF SIR EDMUND FILMER BART 3976  
PARISH OF LIMBURY  
(FORMERLY PARISH OF LUTON)

Leagrave Marsh Common

THE COMMITTEE OF COMMONERS OF LEAGRAVE MARSH

TRUSTEES & MORTGAGEES OF SIR EDMUND FILMER BART

Scale, 2 Chains to an Inch.



Estate Agents Office,  
Midland Railway,  
Derby.

1907-5/1180.7

C O U N T Y O F B E D F O R D

P A R I S H O F T O D D I N G T O N



W I L L I A M C O O P E R C O O P E R A N D O T H E R S

1892 N. & N. Co. Ltd

JOHN & WILLIAM ANSTEE 1874 N. & N. Co. Ltd

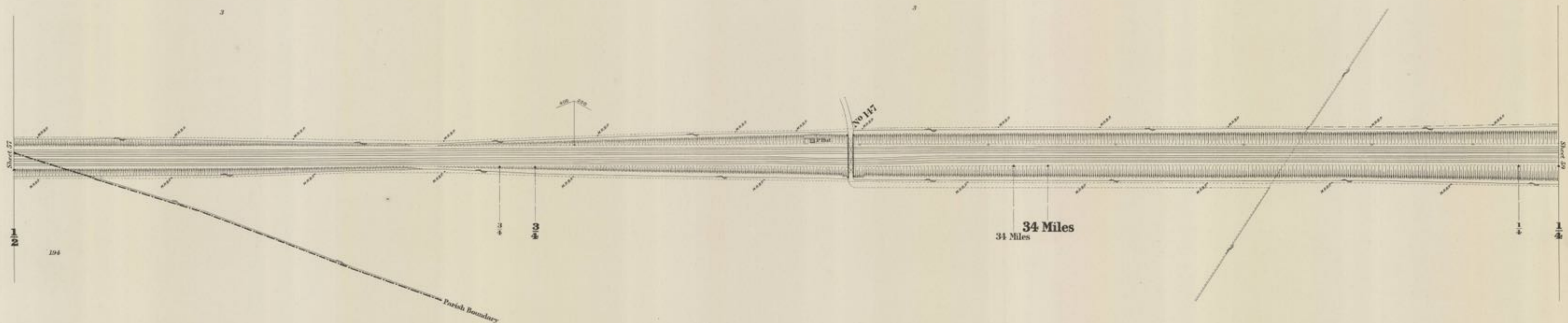

P A R I S H O F L E A G R A V E  
F O R M E R L Y  
P A R I S H O F L U T O N

—Scale, 2 Chains to an Inch.—

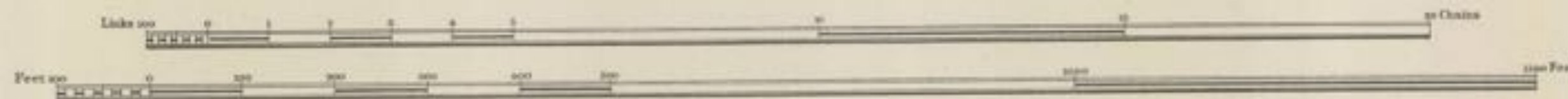

Estate Agents Office,  
Midland Railway  
Derby.

1897-5/1180-B



C O U N T Y O F B E D F O R D

P A R I S H O F T O D D I N G T O N

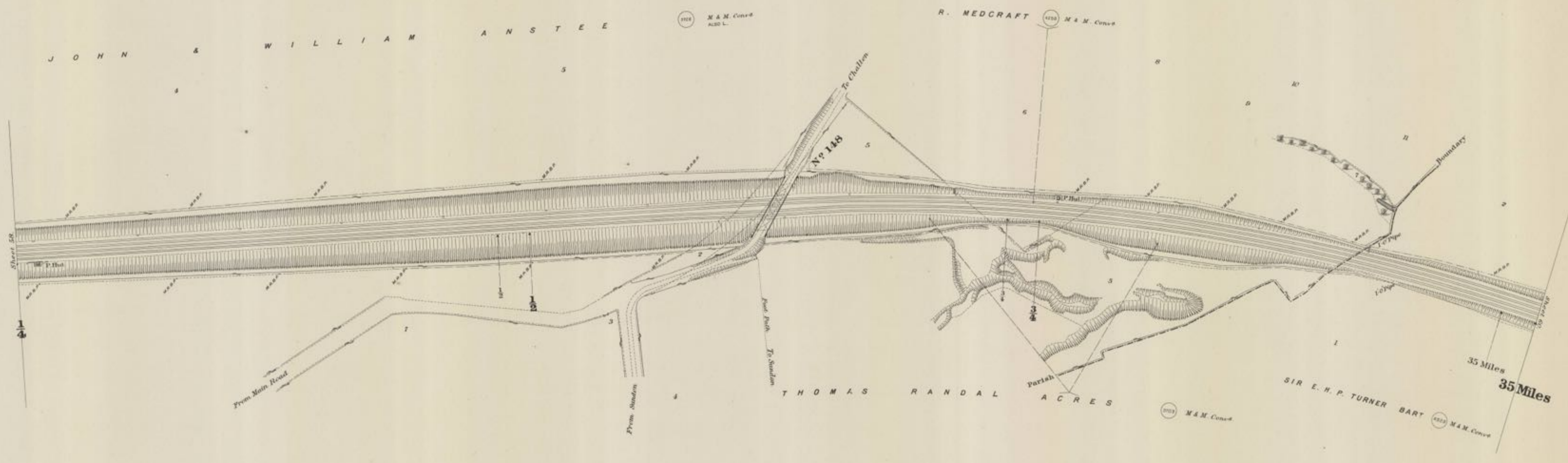

P A R I S H O F S U N D O N

Scale. 2 Chains to an Inch.

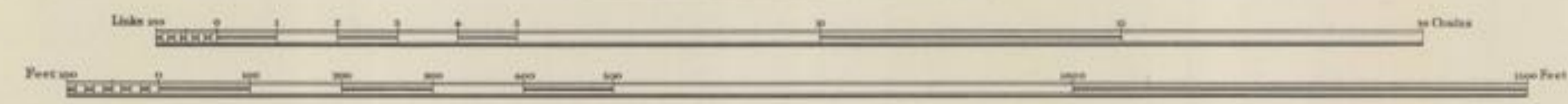

Estate Agents Office,  
Midland Railway,  
Derby.

1907-5/1180.9  
6.0011/5-1061

C O U N T Y O F B E D F O R D

P A R I S H O F S U N D O N

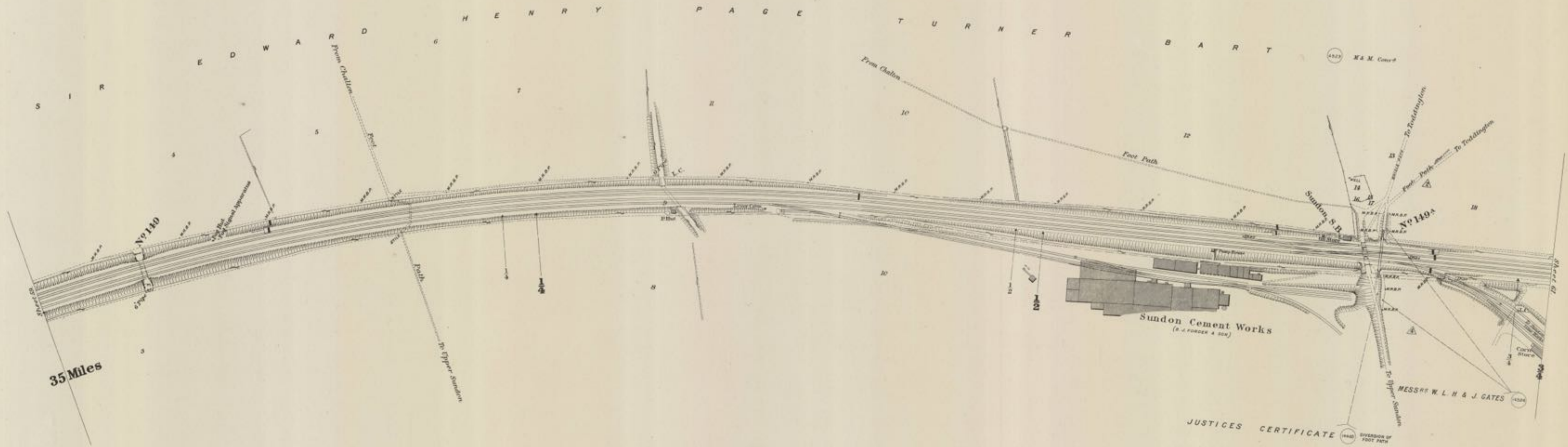

Scale, 2 Chains to an Inch.

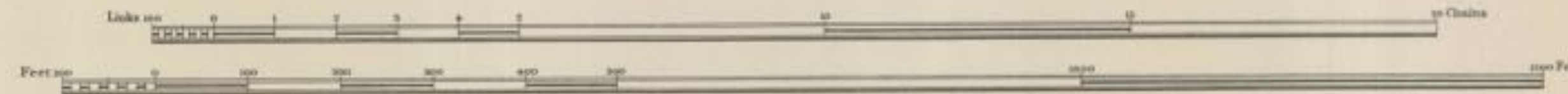

1897-5/1180.10

C O U N T Y O F B E D F O R D

P A R I S H O F S U N D O N

P A R I S H O F T O D D I N G T O N



SIR EDWARD HENRY PAGET TURNER BART (M. & M. Conv<sup>d</sup>)

WILLIAM COOPER COOPER & OTHERS (M. & M. Conv<sup>d</sup>)

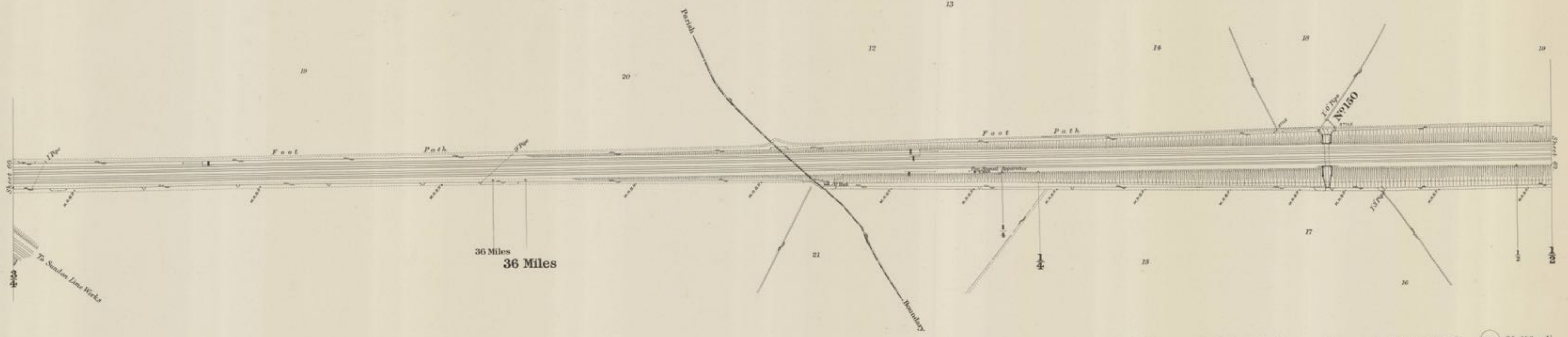

Scale, 2 Chains to an Inch

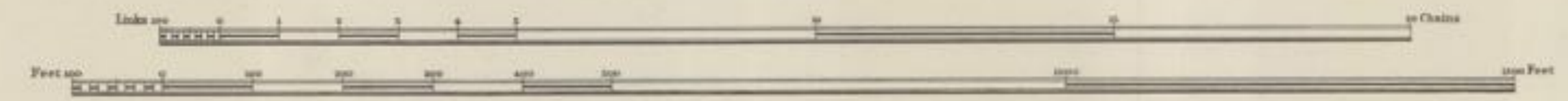

Estate Agents Office, Midland Railway Derby.

11-0-0115-666

C O U N T Y O F B E D F O R D

PARISH OF TODDINGTON

PARISH OF HARLINGTON

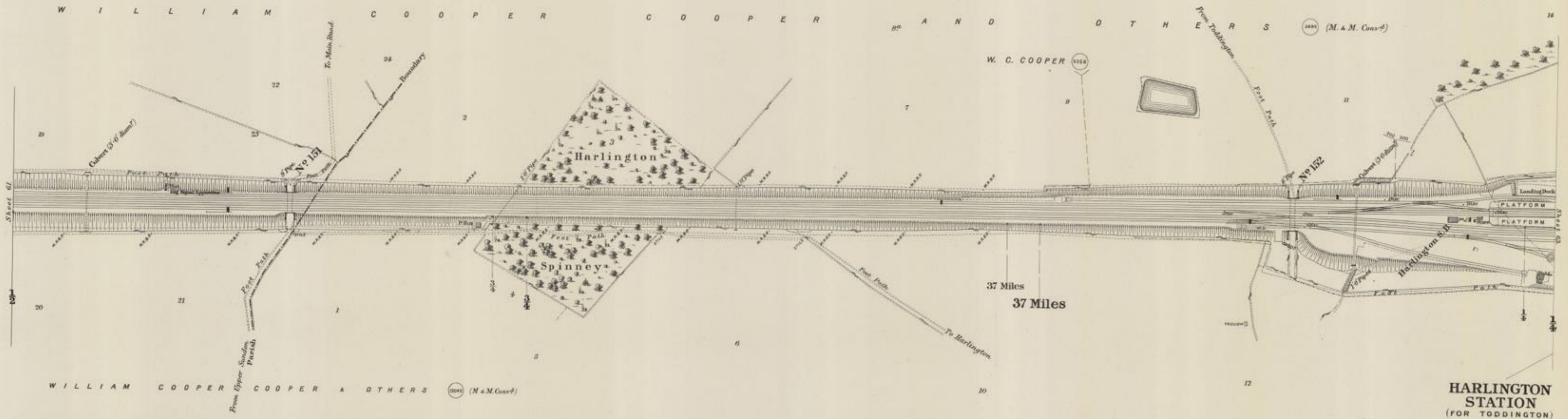

HARLINGTON STATION (FOR TODDINGTON)

Scale, 2 Chains to an Inch.



Estate Agents Office, Midland Railway, Derby.

897-5/1100.12

C O U N T Y O F B E D F O R D

P A R I S H O F H A R L I N G T O N

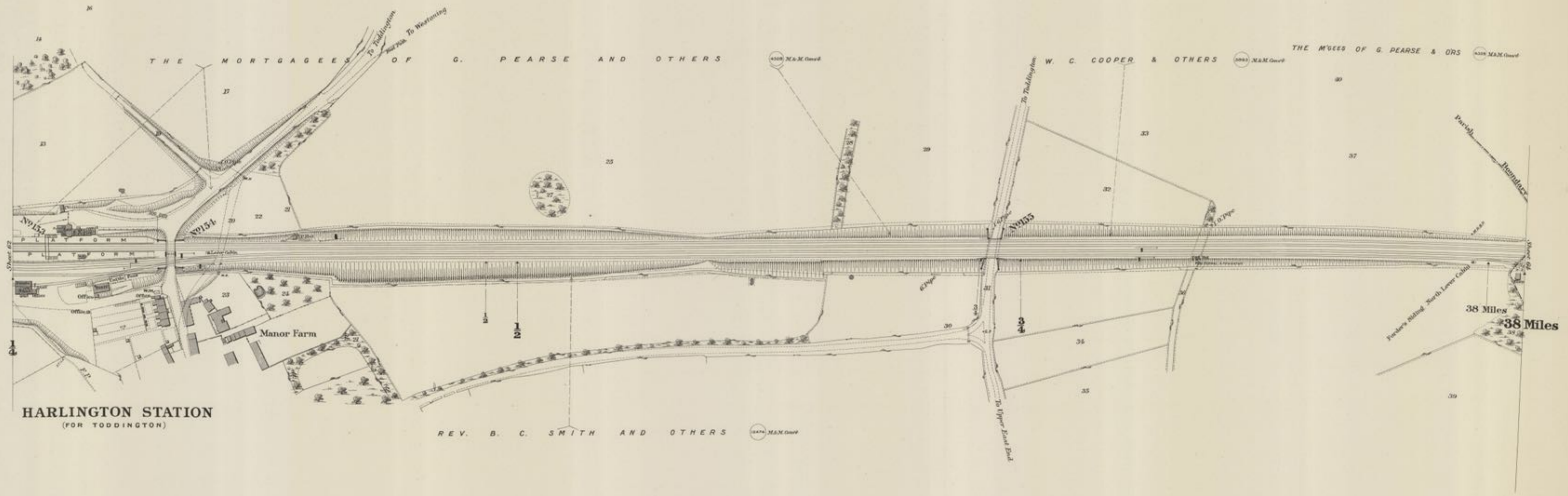

HARLINGTON STATION (FOR TODDINGTON)

HARLINGTON

REV. B. C. SMITH AND OTHERS

W. C. COOPER & OTHERS

THE M'GEE'S OF G. PEARSE & ORS

Scale, 2 Chains to an Inch

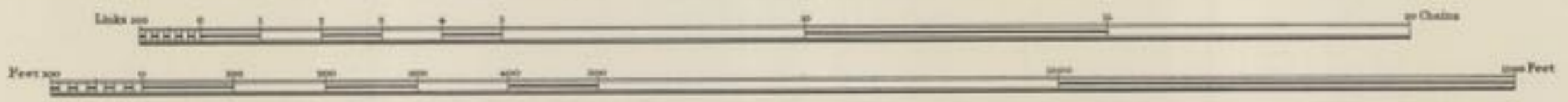

Estate Agent's Office, Midland Railway, Derby.

1997-5/1180-13



C O U N T Y O F B E D F O R D

P A R I S H O F W E S T O N I N G

P A R I S H O F F L I T T O N



WESTONING

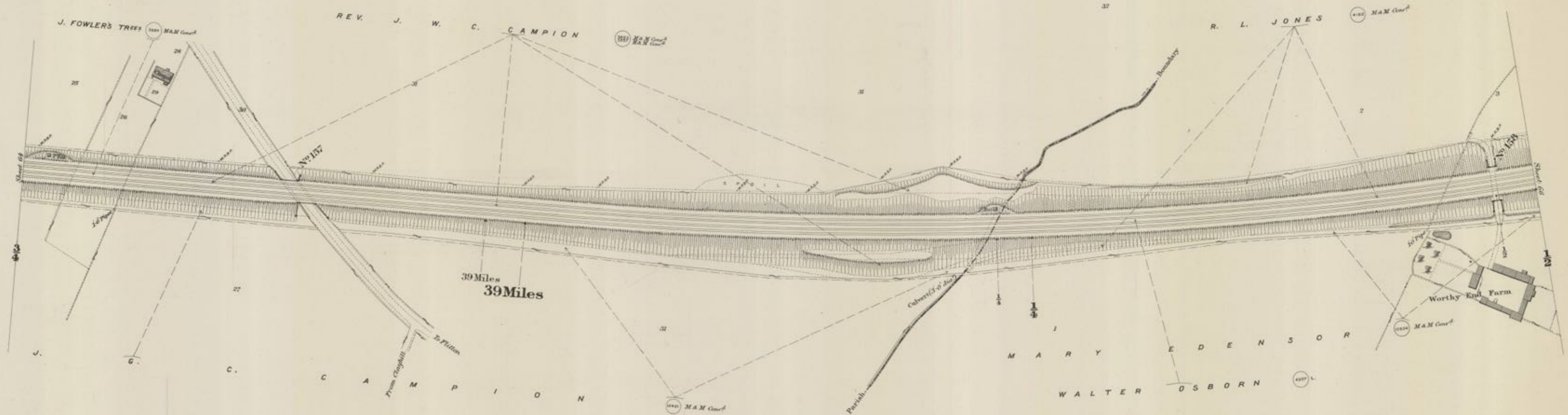

Scale. 2 Chains to an Inch.

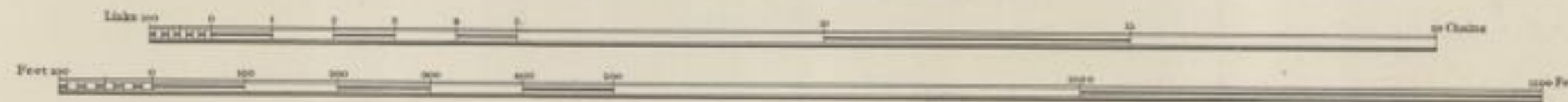

Estate Agents Office,  
Midland Railway,  
Derby.

197-5/180-15

C O U N T Y O F B E D F O R D

PARISH OF FLITTON

PARISH OF FLITWICK

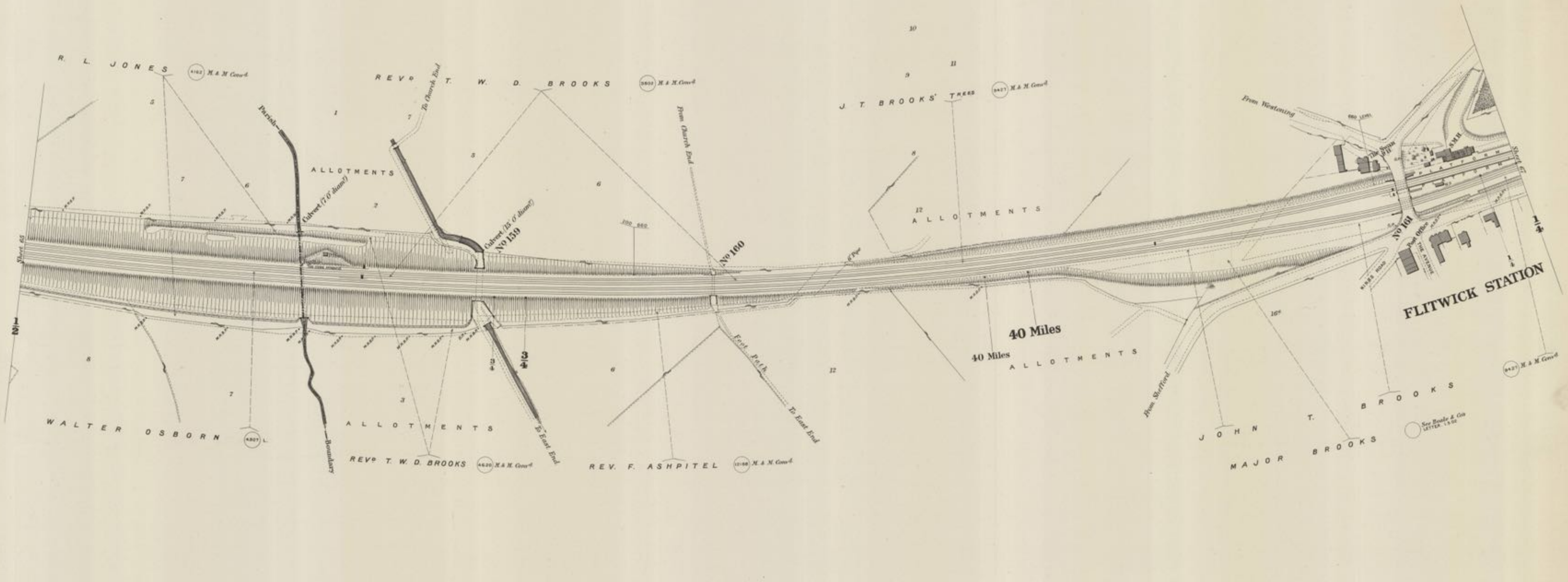

Scale, 2 Chains to an Inch

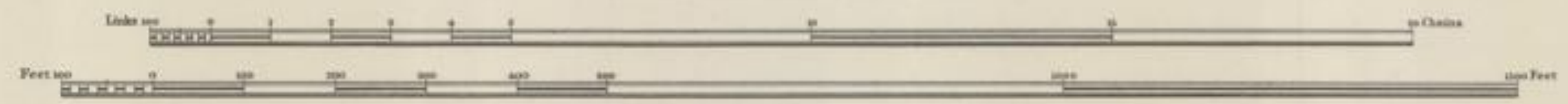

Estate Agent's Office, Midland Railway, Derby

1997-5/1180416



C O U N T Y O F B E D F O R D

P A R I S H O F F L I T W I C K

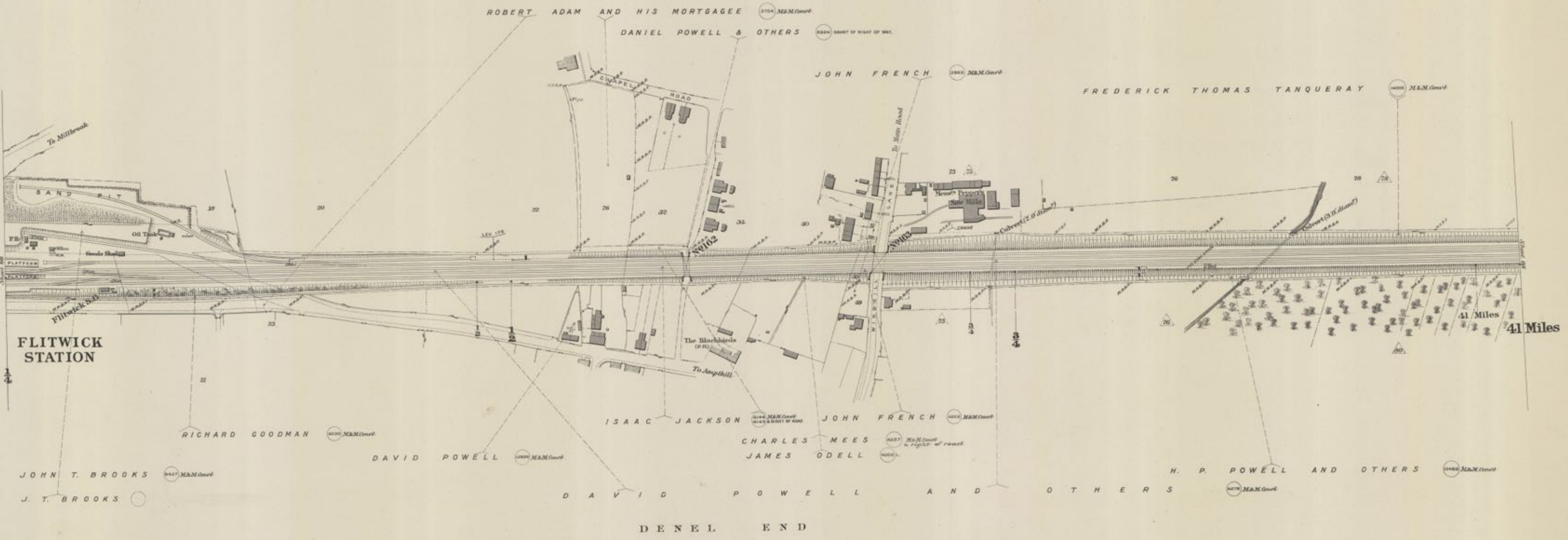

Scale. 2 Chains to an Inch.

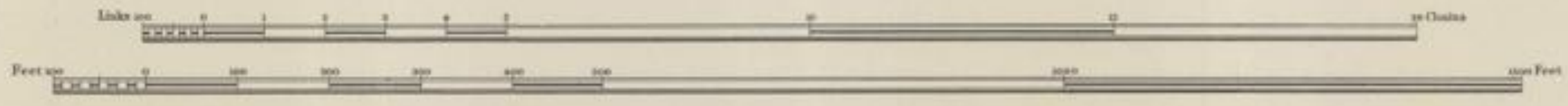

Estate Agents Office,  
Midland Railway,  
Derby.

1997-5/1180.17

C O U N T Y O F B E D F O R D

P A R I S H O F A M P T H I L L



1997-5/180.18

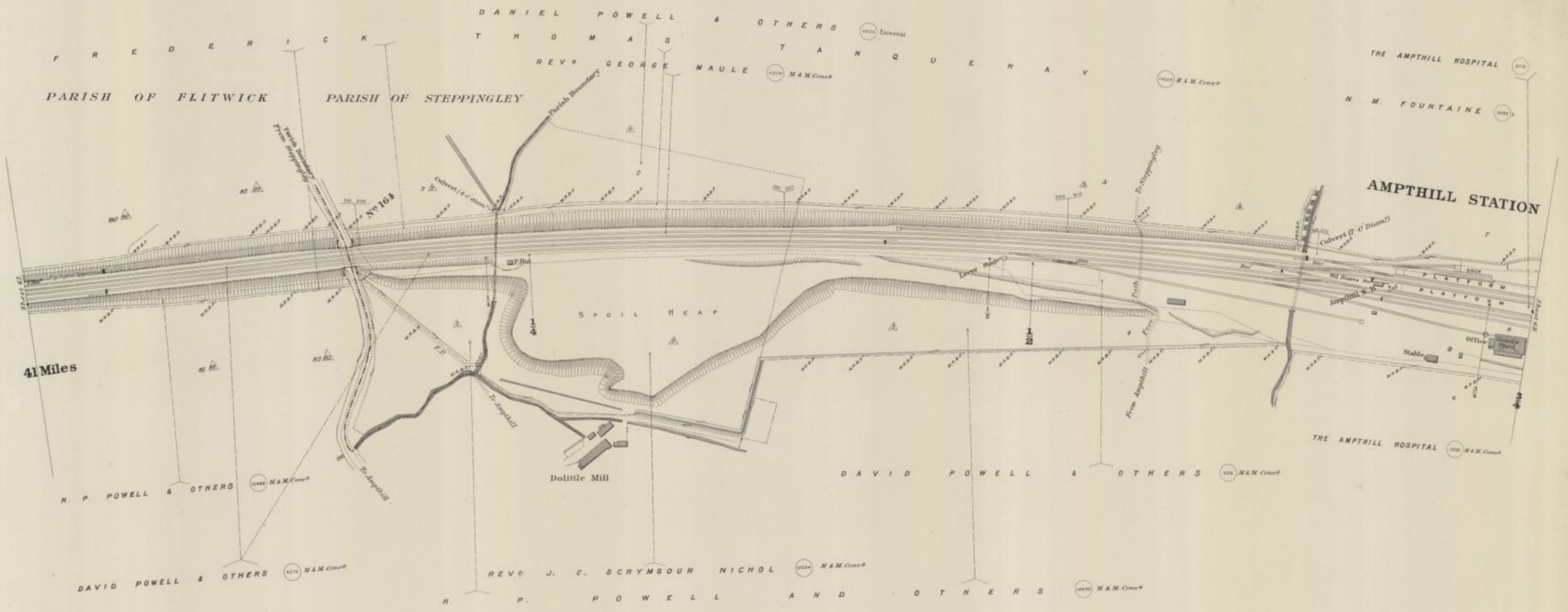

41 Miles

Scale. 2 Chains to an Inch.

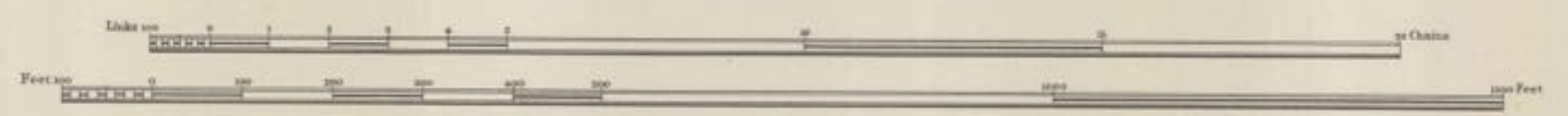

Estate Agent's Office,  
Midland Railway,  
Derby.

C O U N T Y O F B E D F O R D

P A R I S H O F A M P T H I L L

T H E A M P T H I L L H O S P I T A L  
N. M. F O U N T A I N E

PARISH OF MILLBROOK



270 M.A.M. Conr  
1777 M.A.M. Conr  
1826 M.A.M. Conr  
1906 M.A.M. Conr

AMPTHILL STATION

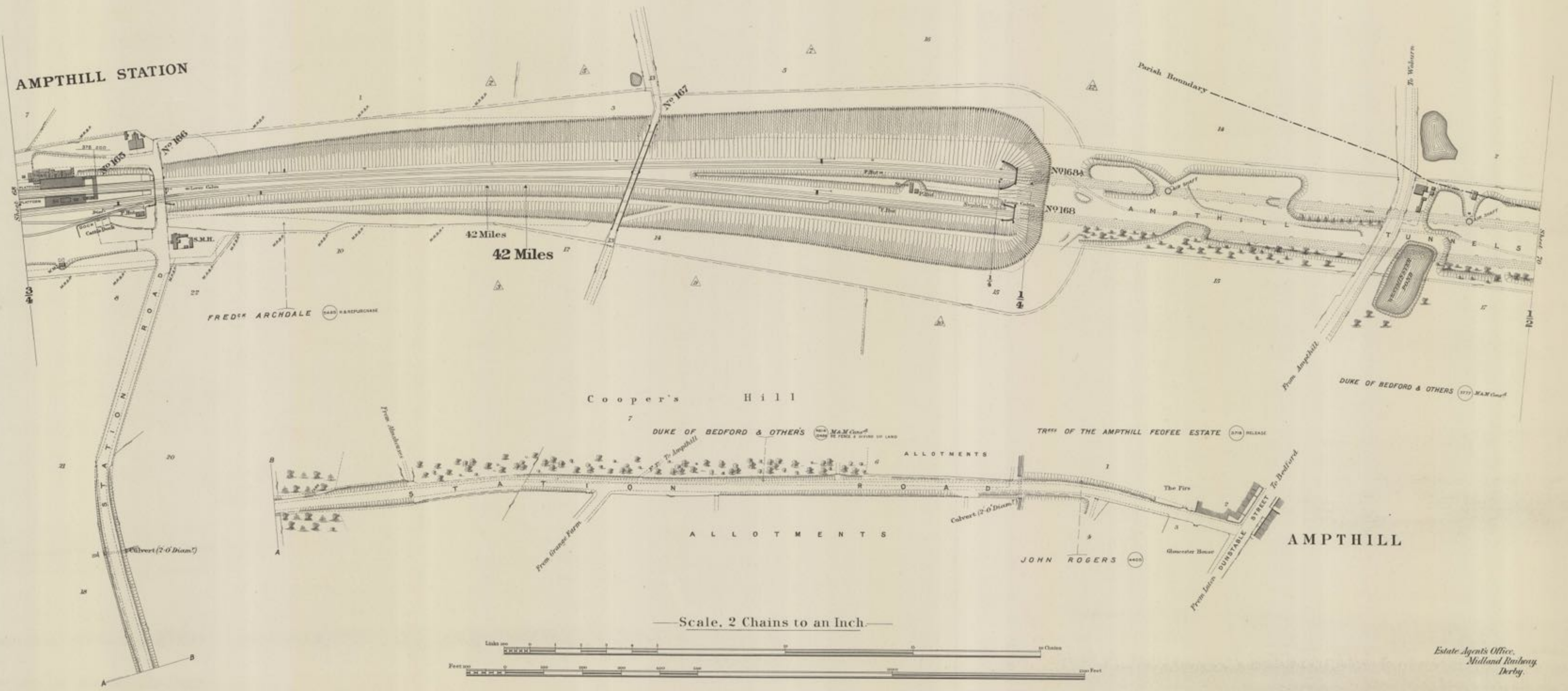

42 Miles  
42 Miles

Cooper's Hill

DUKE OF BEDFORD & OTHERS

TRUSTEES OF THE AMPTHILL FEEFEE ESTATE

ALLOTMENTS

JOHN ROGERS

AMPTHILL

Scale. 2 Chains to an Inch.

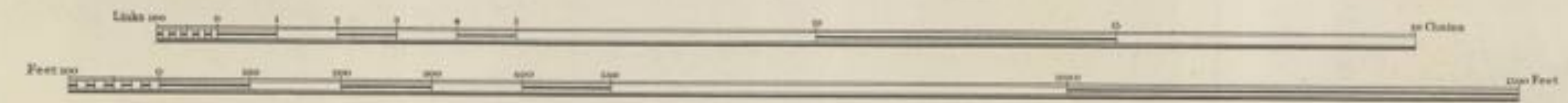

Estate Agents Office,  
Midland Railway  
Derby.

61-0811/5-4661

C O U N T Y O F B E D F O R D

P A R I S H O F M I L L B R O O K



T H E D U K E O F B E D F O R D & H I S T R U S T E E S  
G E O R G E G R E E N

5777 M & M. Conv'd  
THE DUKE OF BEDFORD (1848 Temp Occupation)

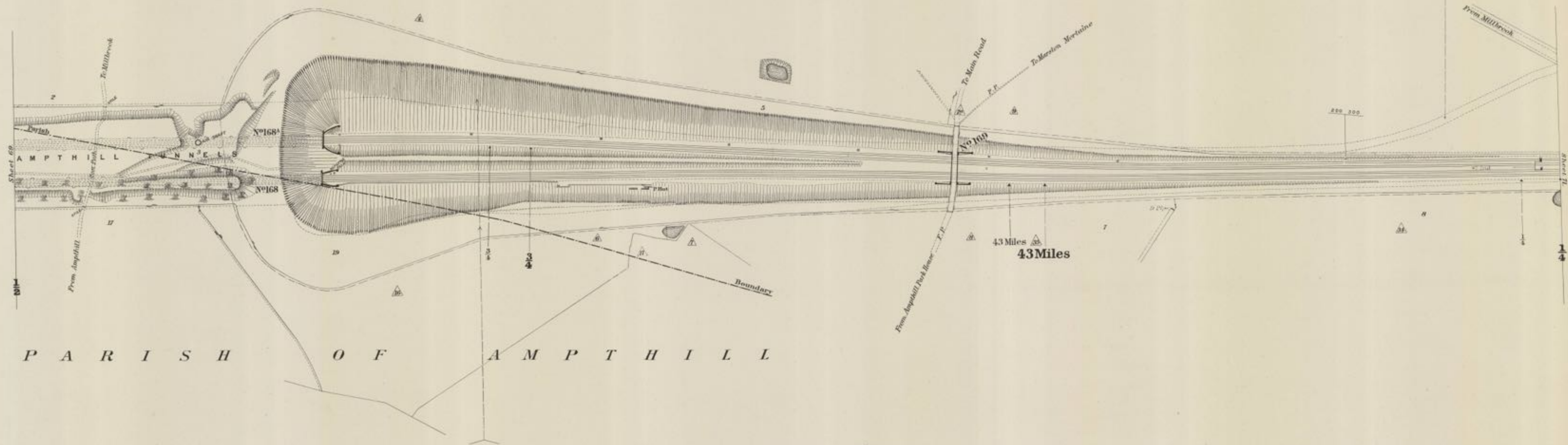

P A R I S H O F A M P T H I L L

T H E D U K E O F B E D F O R D & T R U S T E E S  
T H E D U K E O F B E D F O R D & H I S T R U S T E E S

—Scale. 2 Chains to an Inch.—

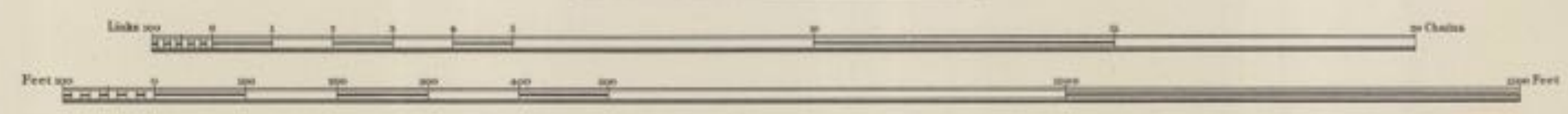

Estate Agents Office,  
Midland Railway  
Derby.

1997-5/1180.20

C O U N T Y O F B E D F O R D

P A R I S H O F M I L L B R O O K

P A R I S H O F M A R S T O N M O R E T A I N E

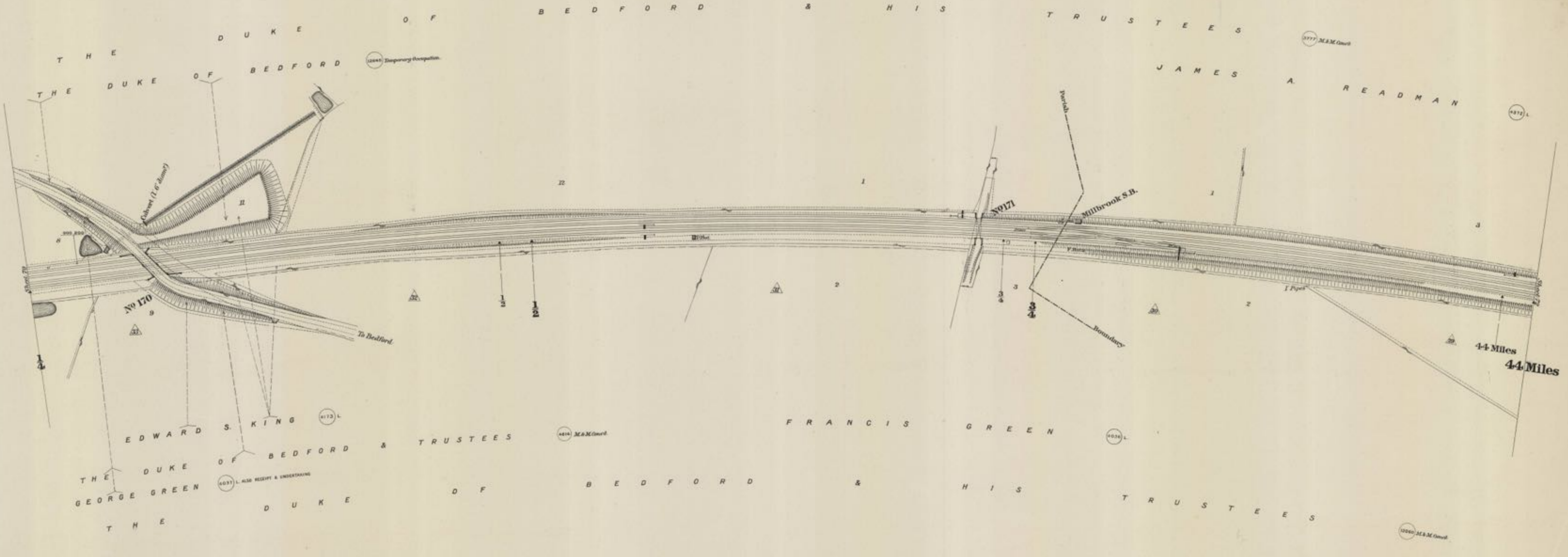

Scale. 2 Chains to an Inch.

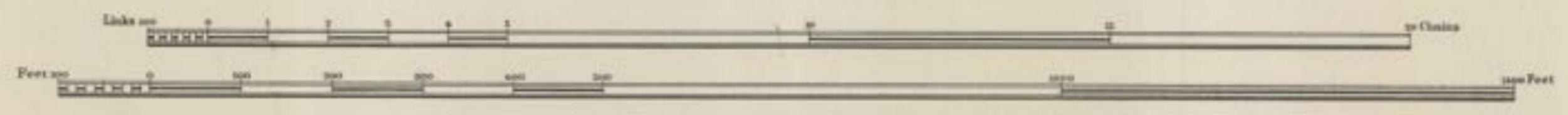

1997-5/180.21

C O U N T Y O F B E D F O R D

PARISH OF MARSTON MORETAINE

PARISH OF WOOTTON



THE MASTER FELLOWS & SCHOLARS OF SIDNEY SUSSEX COLLEGE CAMBRIDGE

DUKE OF BEDFORD & HIS TRUSTEES  
JAMES A READMAN

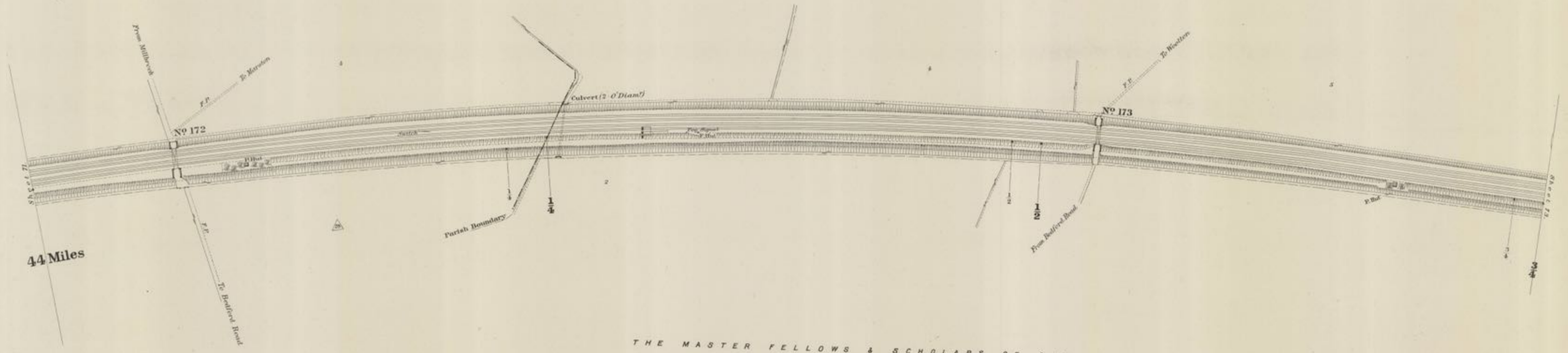

44 Miles

DUKE OF BEDFORD & HIS TRUSTEES

THE MASTER FELLOWS & SCHOLARS OF SIDNEY SUSSEX COLLEGE CAMBRIDGE

Scale. 2 Chains to an Inch.



1997-5/1180.22

C O U N T Y O F B E D F O R D

P A R I S H O F W O O T T O N P A R I S H O F H O U G H T O N C O N Q U E S T



MASTER FELLOWS & SCHOLARS OF SYDNEY SUSSEX COLLEGE, CAMBRIDGE. (4440) (M. & M. Conv<sup>d</sup>) T R U S T E E S O F M A R T H A M O R R I S (4278) (M. & M. Conv<sup>d</sup>)

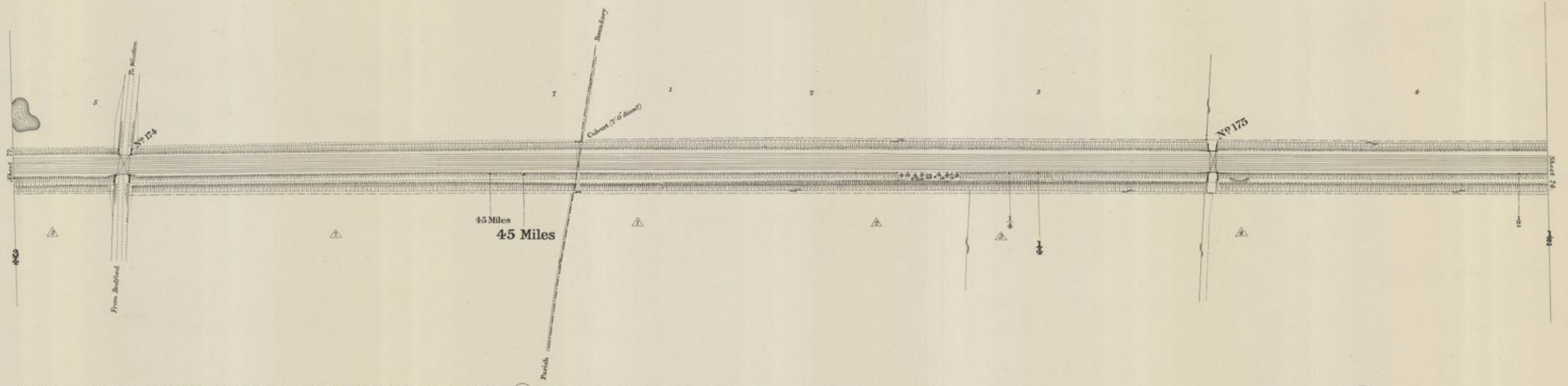

MASTER FELLOWS & SCHOLARS OF SYDNEY SUSSEX COLLEGE, CAMBRIDGE. (12438) (M. & M. Conv<sup>d</sup>) T R U S T E E S O F C A R O L I N E U P C H E R (12488) (M. & M. Conv<sup>d</sup>)

Scale, 2 Chains to an Inch.

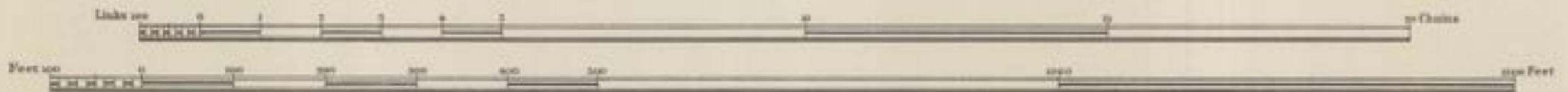

Estate Agent's Office,  
Midland Railway  
Derby.

1441-5/5-4461

C O U N T Y O F B E D F O R D

P A R I S H O F K E M P S T O N R U R A L



1897-5/186.A.4

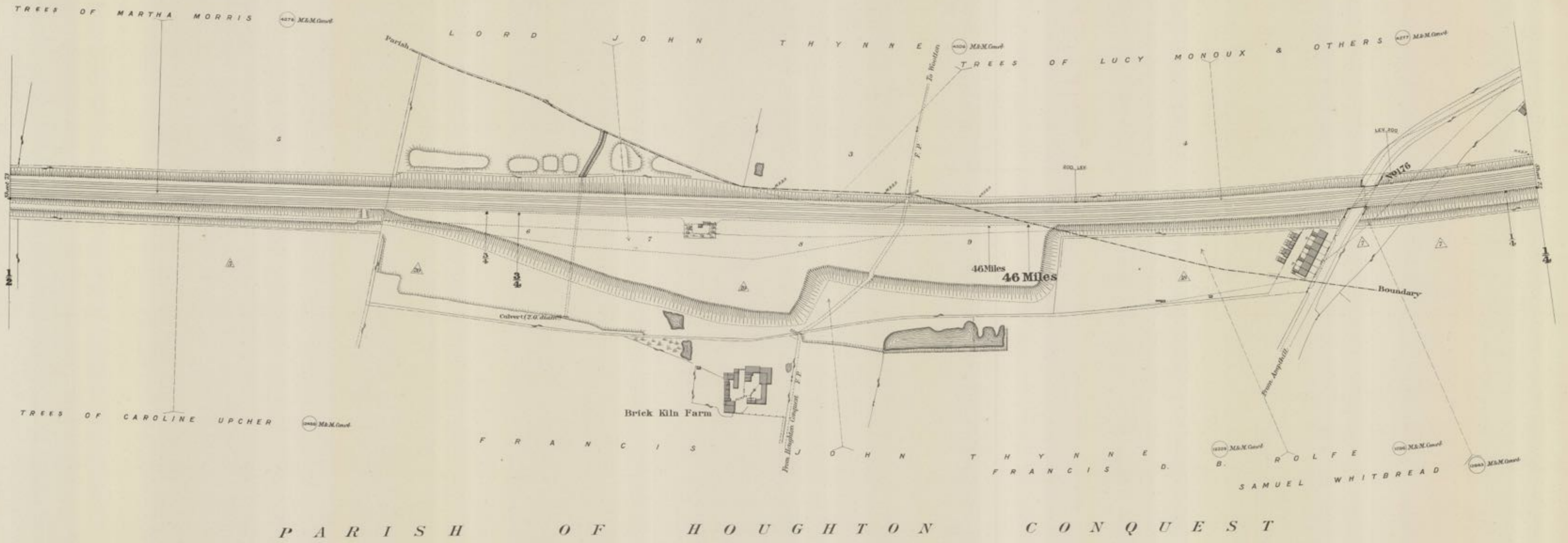

P A R I S H O F H O U G H T O N C O N Q U E S T

Scale, 2 Chains to an Inch.

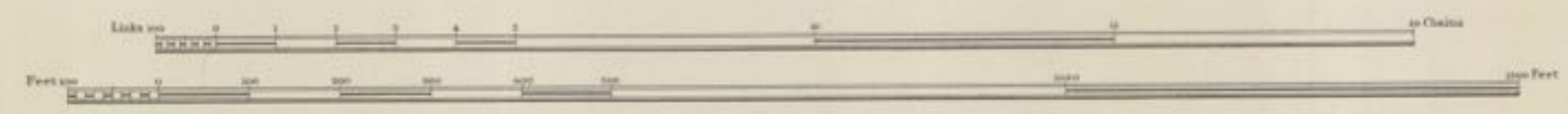

Estate Agent's Office,  
Midland Railway  
Derby.



C O U N T Y O F B E D F O R D



PARISH OF KEMPSTON RURAL

PARISH OF ELSTOW

TRES OF LUCY MONDOUX & OTHERS 1877 M.A.M. Conv<sup>d</sup>

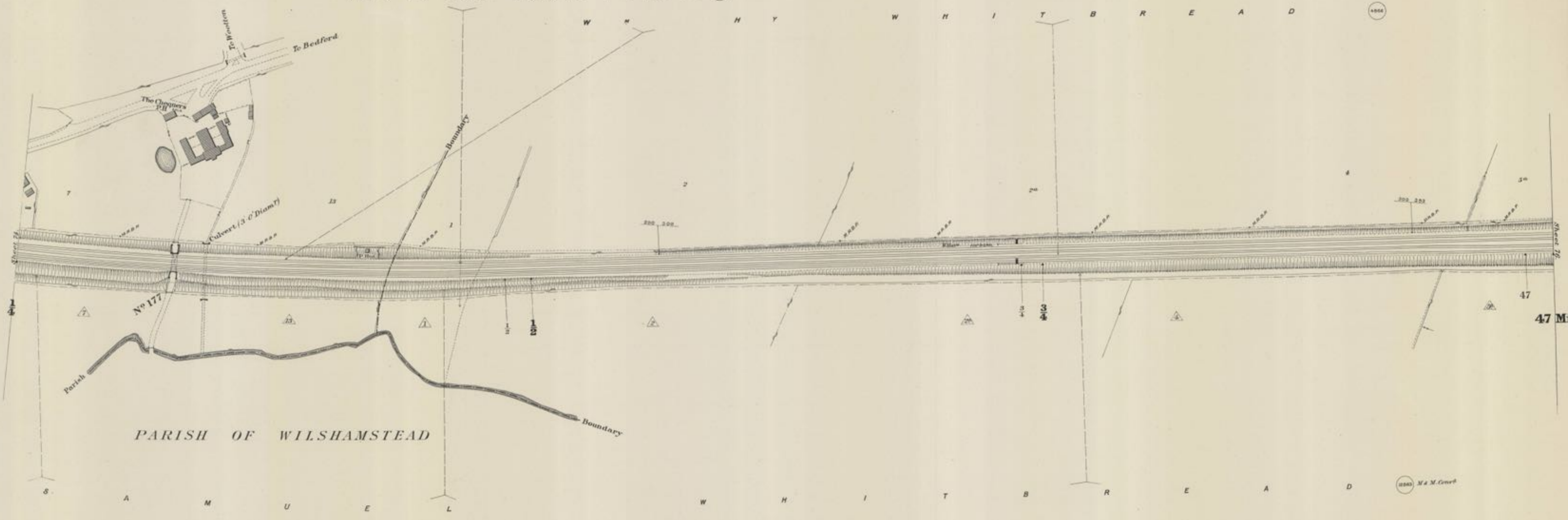

47 Miles

PARISH OF WILSHAMSTEAD

Scale, 2 Chains to an Inch.



Estate Agents Office,  
Midland Railway,  
Derby.

52.0811/5-1661

C O U N T Y O F B E D F O R D

P A R I S H O F E L S T O W



W I L L I A M

H E N R Y

W H I T B R E A D

4560

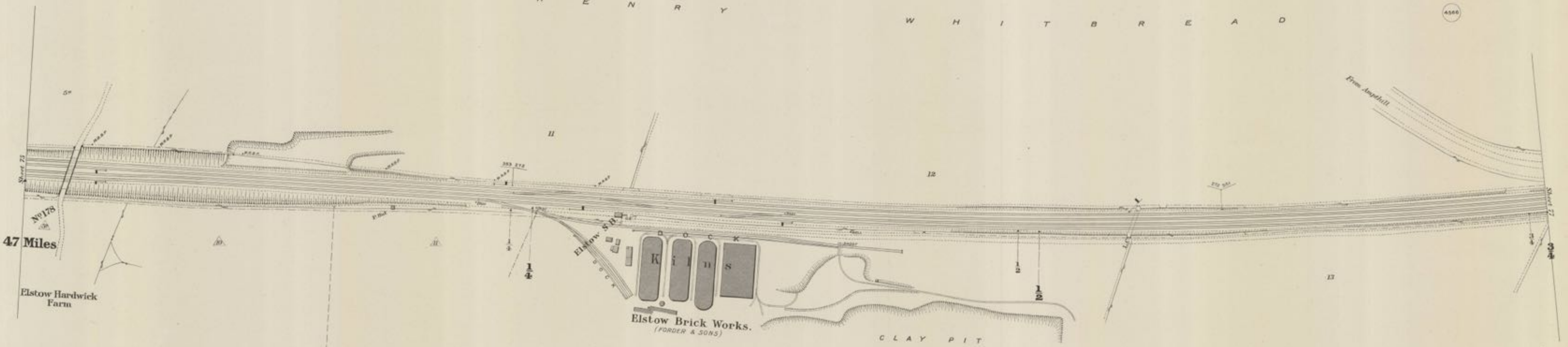

47 Miles

Elstow Hardwick Farm

Elstow Brick Works (FORDER & SONS)

CLAY PIT

S. A M U E L

W H I T B R E A D

1260 N. & N. One f

—Scale, 2 Chains to an Inch.—



Estate Agent's Office,  
Midland Railway,  
Derby.

1997-5/1180.2.6

C O U N T Y O F B E D F O R D

PARISH OF ELSTOW

PARISH OF KEMPSTON

W I L L I A M H E N R Y W H I T B R E A D A N D O T H E R S

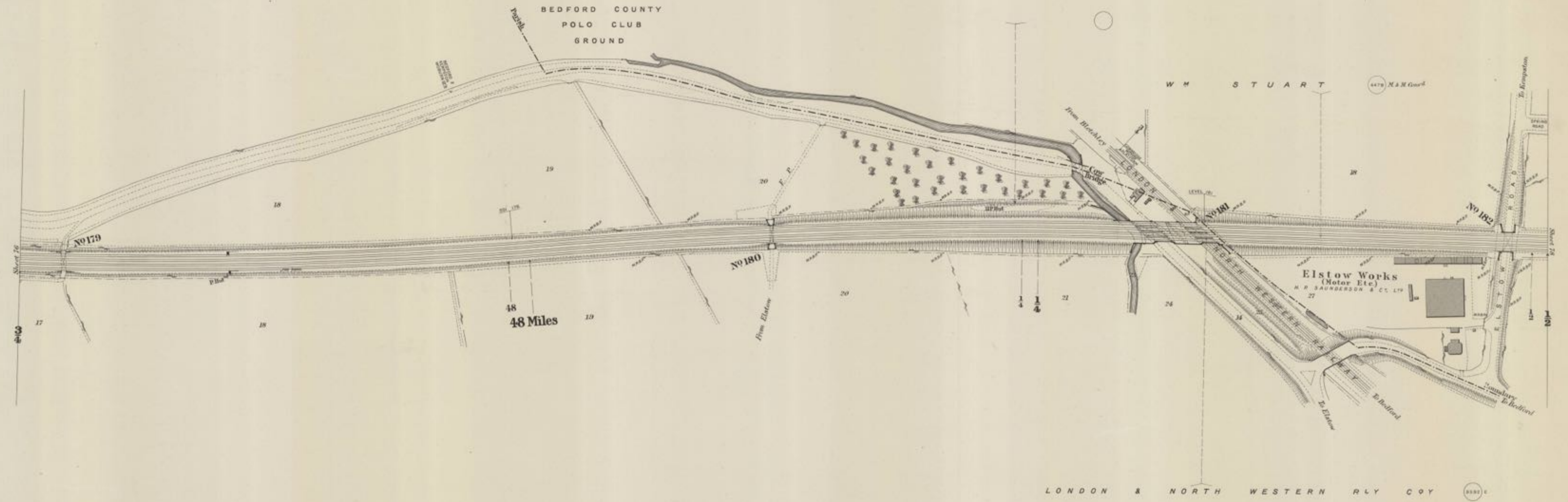

48 Miles

Scale, 2 Chains to an Inch.

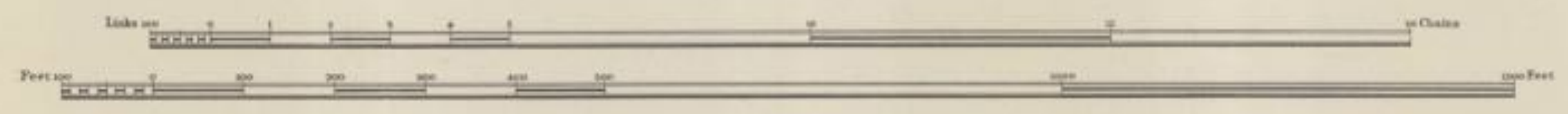

1997-5/1/89. 77

Estate Agent's Office,  
Midland Railway,  
Derby.

C O U N T Y O F B E D F O R D

REV. CANON BRERETON (1842) M.A.M. Genl. to depth of 1000 Feet. SHEET 78.

P A R I S H O F K E M P S T O N

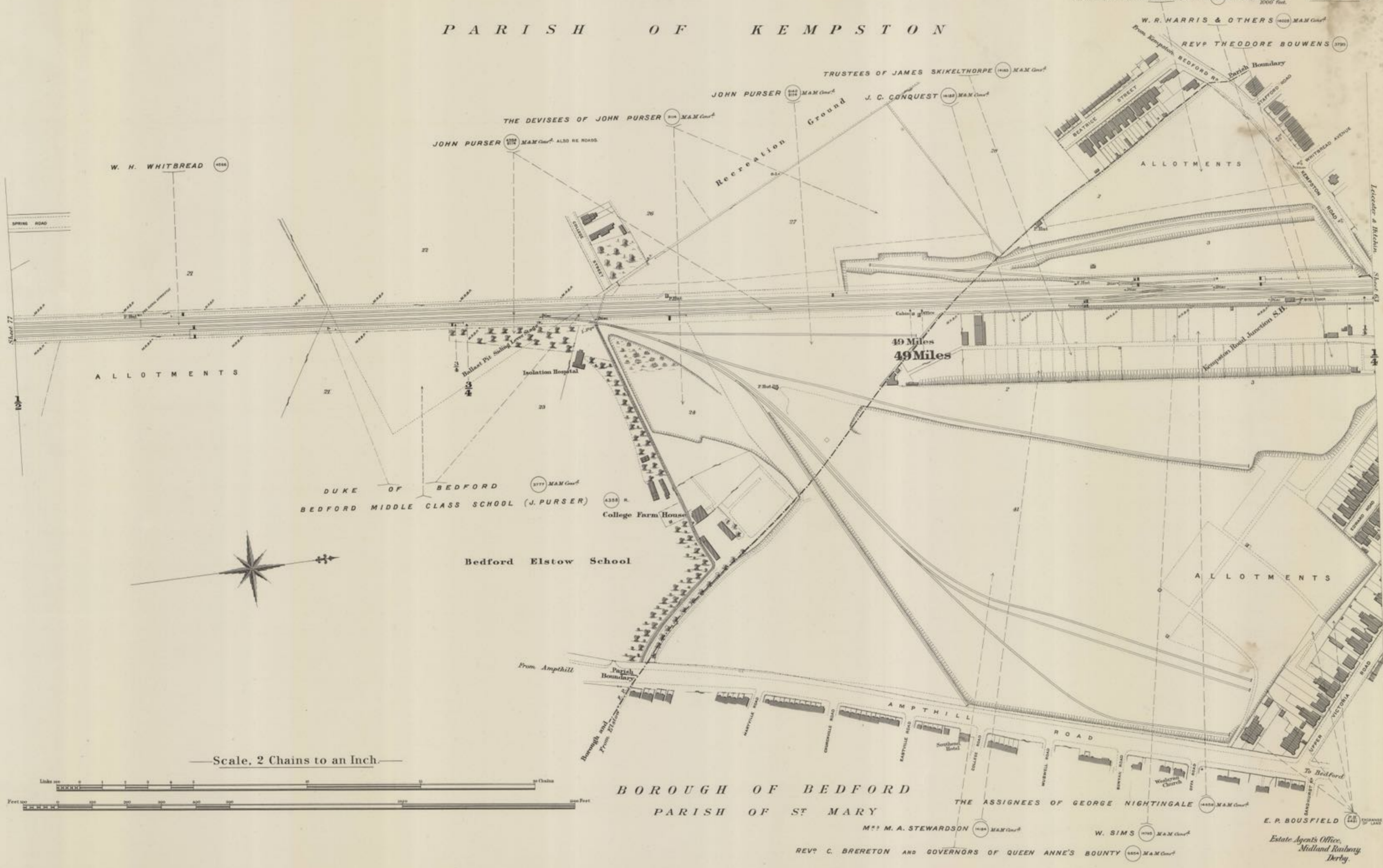

Scale, 2 Chains to an Inch.

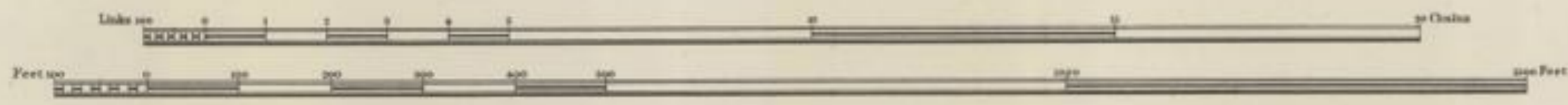

B O R O U G H O F B E D F O R D  
P A R I S H O F S T M A R Y

MRS. M. A. STEWARDSON (1824) M.A.M. Genl.  
W. SIMS (1875) M.A.M. Genl.  
REV. C. BRERETON AND GOVERNORS OF QUEEN ANNE'S BOUNTY (1834) M.A.M. Genl.  
E. P. BOUSFIELD (1851) M.A.M. Genl.  
Estate Agents Office, Midland Railway, Derby.

1887-5/120.28