

MIDLAND RAILWAY.

BLACKWELL BRANCHES

& EXTENSIONS

LAND PLAN.

Surveyed by
W. H. C. Clay,
 Estate Agent,
 Derby
 1915.

Reference.

SIGNALS, &c. The Signals are shown as they appear to view

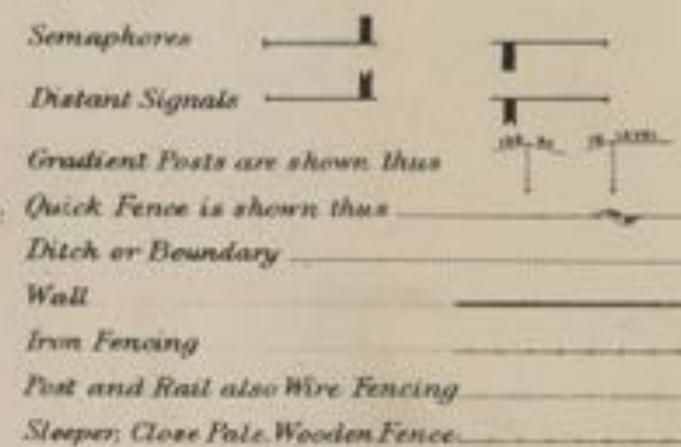

Titles of Acts.

The Midland Railway (Additional Powers)	Tibshelf and Blackwell Branch	— — Act 1875, 38 & 39 Vict.—Royal Assent 29th June, 1875.
Do. (New Works, etc.)	Power to acquire Blackwell Branch, also New Road	„ 1877, 40 & 41 „ — Do. 28th June, 1877.
Do. — — — — —	Blackwell Branch Extension	„ 1889, 52 & 53 „ — Do. 24th June, 1889.
Do. (Additional Powers)	Do. do. Abandonment of portion	„ 1890, 53 & 54 „ — Do. 25th July, 1890.
Do. — — — — —	Do. do. Extension of time	„ 1892, 55 & 56 „ — Do. 28th June, 1892.

COLOURING The Company's FREEHOLD Property is shown by RED Colour

Do. LEASEHOLD do. RED EDGE ONLY	<input type="checkbox"/>
Property owned JOINTLY with other Companies GREEN Colour	<input type="checkbox"/>
Do. over or through which the Company has an EASEMENT is shown by RED dotted lines.	<input type="checkbox"/>
Do. over or through which the Company has granted an EASEMENT is shown by PURPLE dotted lines.	<input type="checkbox"/>
Do. granted on LEASE by the Company by RED Full lines.	<input type="checkbox"/>
Do. SOLD or otherwise disposed of by the Company is shown by PURPLE colour.	<input type="checkbox"/>
MINERALS specially purchased by the Company shown by BLUE Full lines.	<input type="checkbox"/>
Do. SOLD or otherwise disposed of by the Company shown by PURPLE Full lines.	<input type="checkbox"/>

NOTE— Vendors Names are written in block as VENDOR.
 The figures within the circle after the names of the Vendors refer to the numbers on the deeds relating to the purchase.
 The slanting figures as 20 refer to Parliamentary numbers (Original Act).
 Do. within a triangle as 20 are the Parliamentary numbers referring to subsequent Acts.

1997-5/1174.1

1997-5/1174.2

C O U N T Y O F D E R B Y
P A R I S H O F B L A C K W E L L

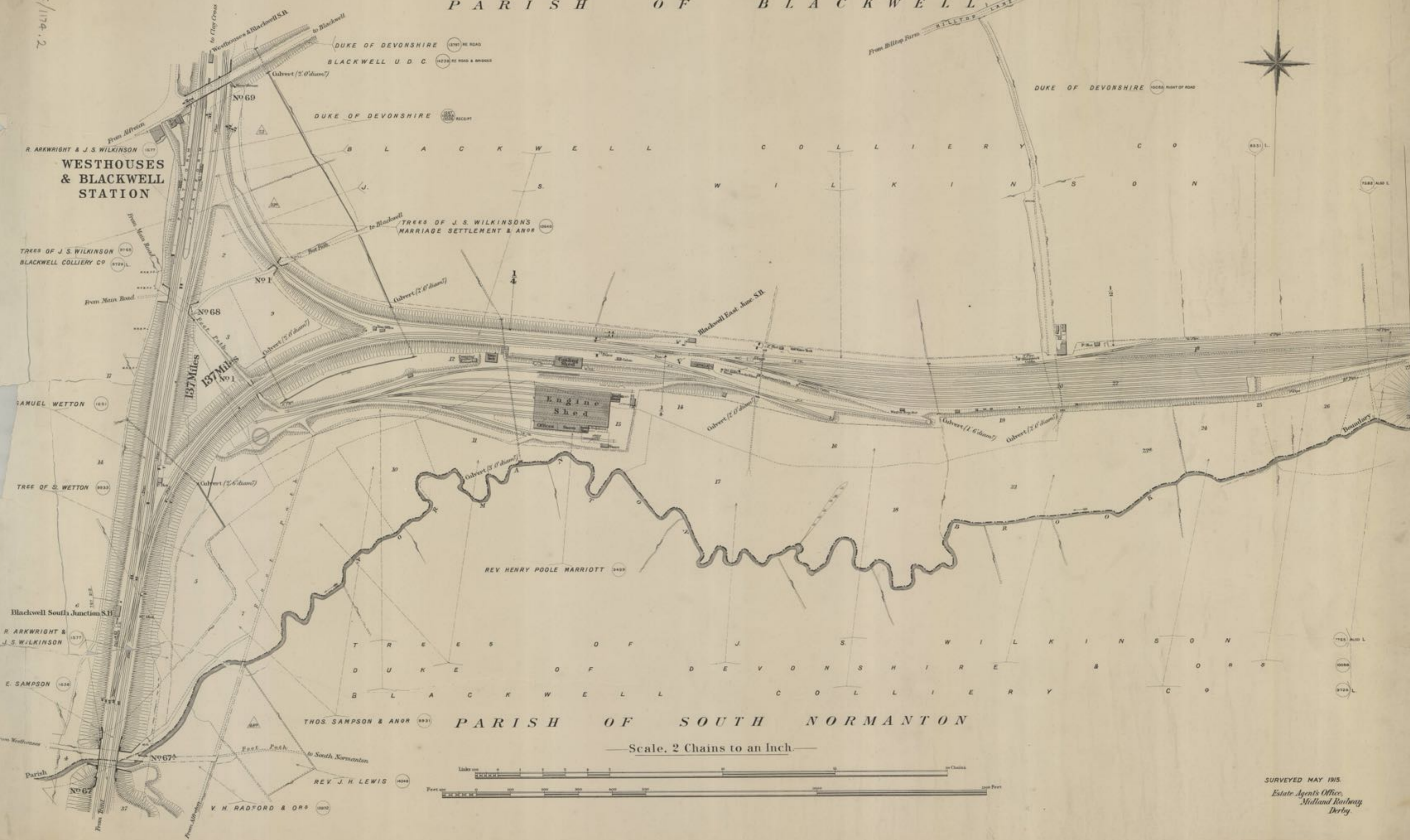

WESTHOUSES
& BLACKWELL
STATION

Engine
Shed

REV HENRY POOLE MARRIOTT

THOS. SAMPSON & ANOR

P A R I S H O F S O U T H N O R M A N T O N

Scale, 2 Chains to an Inch.

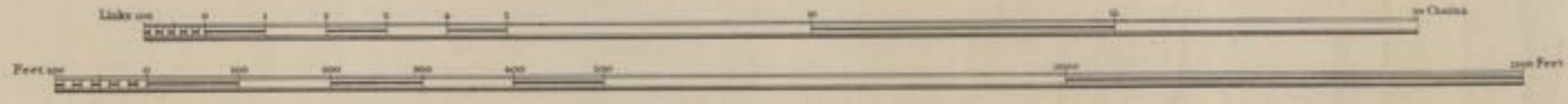

SURVEYED MAY 1915.
Estate Agents Office,
Midland Railway,
Derby.

1997-5/1174.3

C O U N T Y O F D E R B Y

P A R I S H O F B L A C K W E L L

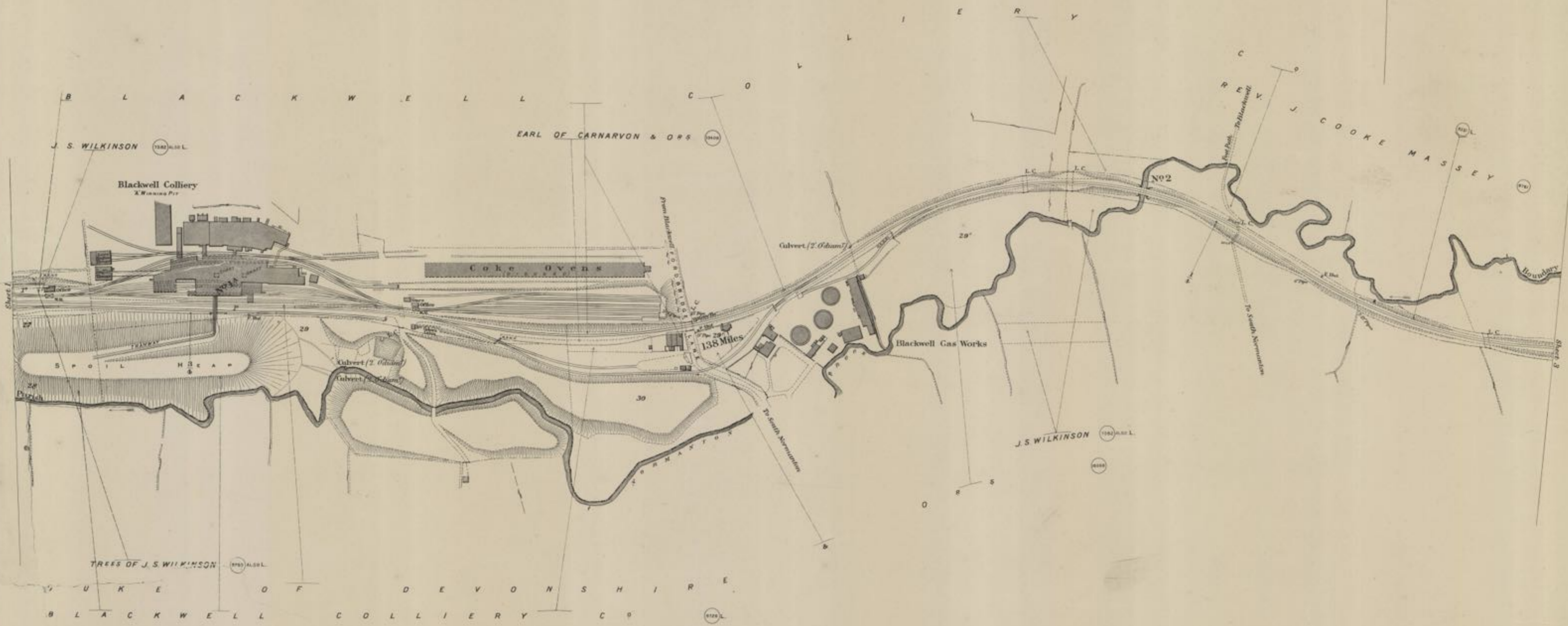

TREES OF J. S. WILKINSON
B L A C K W E L L C O L L I E R Y C O

P A R I S H O F S O U T H N O R M A N T O N

Scale, 2 Chains to an Inch.

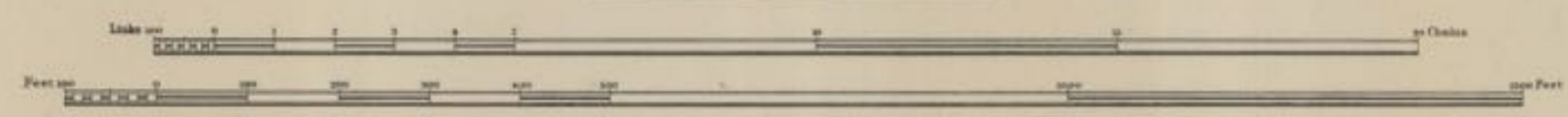

C O U N T Y O F D E R B Y

P A R I S H O F B L A C K W E L L

1997-5/1174.4

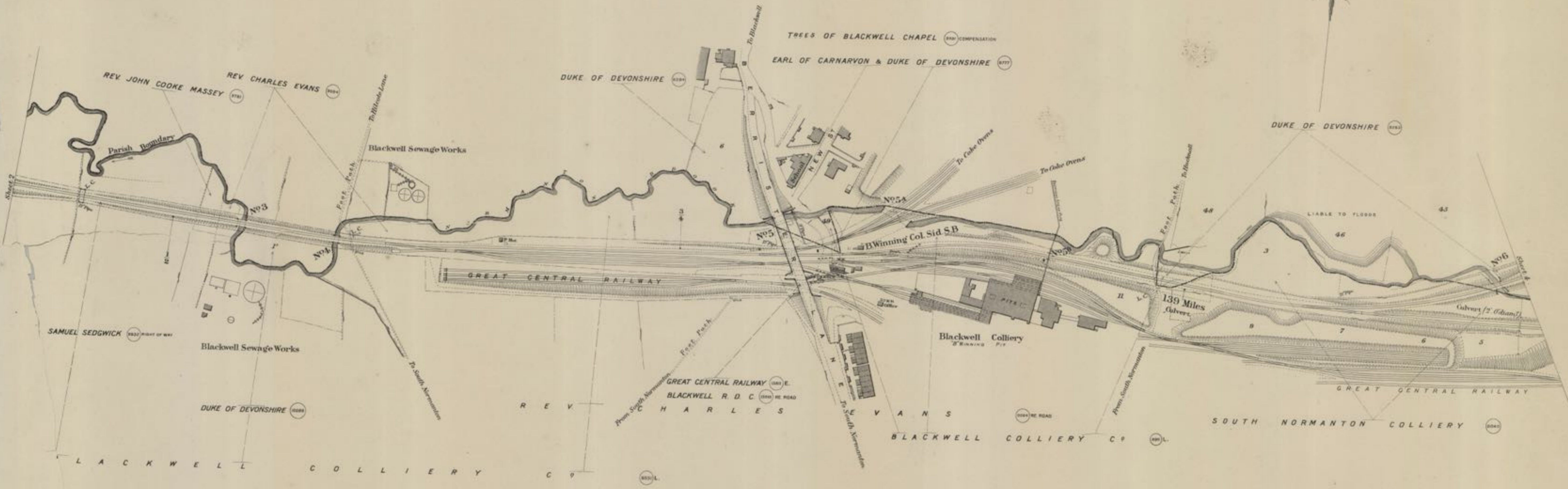

P A R I S H O F S O U T H N O R M A N T O N

Scale, 2 Chains to an Inch.

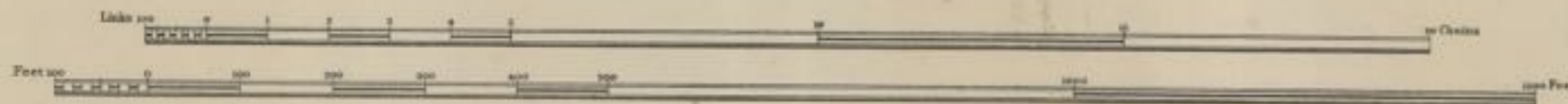

SURVEYED MAY 1913.
Estate Agents Office,
Midland Railway
Derby.

COUNTY OF DERBY

COUNTY OF NOTTINGHAM

PARISH OF BLACKWELL 35

PARISH OF HUCKNALL UNDER HUTHWAITE

1997-5/1174.5

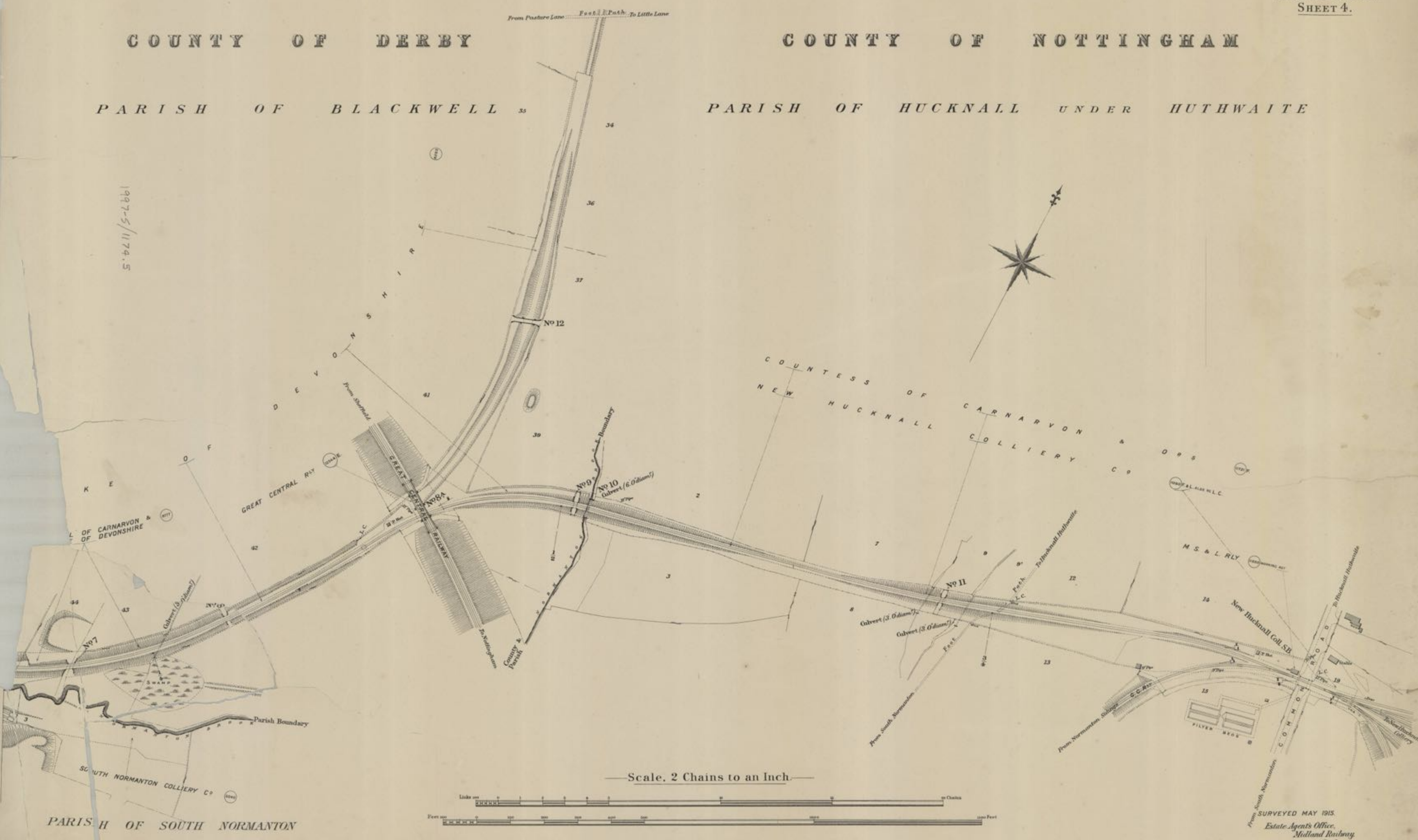

Scale. 2 Chains to an Inch.

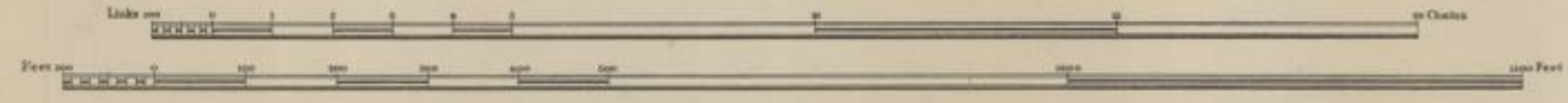

PARISH OF SOUTH NORMANTON

SURVEYED MAY 1915.
Estate Agents Office,
Midland Railway,
Derby.