

# MIDLAND RAILWAY.

## IRCHESTER & RAUNDS BRANCH







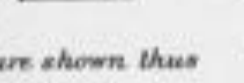

## CRANSLEY BRANCH & EXTENSION

## LAND PLAN.

Surveyed by  
*P. S. M. Callum.*  
 Estate Agent,  
 Derby.  
 1912.

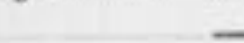
### Titles of Acts.

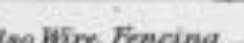
#### Reference.

- SIGNALS, &c.** The Signals are shown as they appear to view
- Semaphores 
  - Distant Signals 
  - Gradient Posts are shown thus 
- FENCES.** Quick Fence is shown thus 
- Ditch or Boundary 
  - Wall 
  - Iron Fencing 
  - Post and Rail also Wire Fencing 
  - Sleeper, Close Pile, Wooden Fence 

		<b>IRCHESTER AND RAUNDS BRANCH.</b>	
The Midland Railway (Additional Powers)	Irchester and Raunds Branch	- -	Act 1890—53&54 Vict., Royal Assent 25th July, 1890.
		<b>CRANSLEY BRANCH AND EXTENSION.</b>	
The Midland Railway (New Works, &c.)	Powers to acquire Cransley Branch Railway	-	Act 1877—40&41 Vict., Royal Assent 28th June, 1877.
Do.	( do. do. )	do.	do. Cransley Branch Extension ,, 1895—58&59 Vict., do. 6th July, 1895.

- COLOURING.** The Company's FREEHOLD Property is shown by RED Colour
- Do. LEASEHOLD do. RED EDGE ONLY
- Property owned JOINTLY with other Companies GREEN Colour
- Do. over or through which the Company has an EASEMENT is shown by RED dotted lines.
- Do. over or through which the Company has granted an EASEMENT is shown by PURPLE dotted lines.
- Do. granted on LEASE by the Company by RED Full lines.
- Do. SOLD or otherwise disposed of by the Company is shown by PURPLE colour.
- MINERALS specially purchased by the Company shown by BLUE Full lines.
- Do. SOLD or otherwise disposed of by the Company shown by PURPLE Full lines.

**NOTE.** Vendors Names are written in block as VENDOR. The figures within the circle after the names of the Vendors refer to the numbers on the deeds relating to the purchases &c. (214)

The slanting figures as 20 refer to Parliamentary numbers (Original Act) Do. within a triangle as 20 are the Parliamentary numbers referring to subsequent Acts.

# C O U N T Y O F N O R T H A M P T O N

## P A R I S H O F I R C H E S T E R

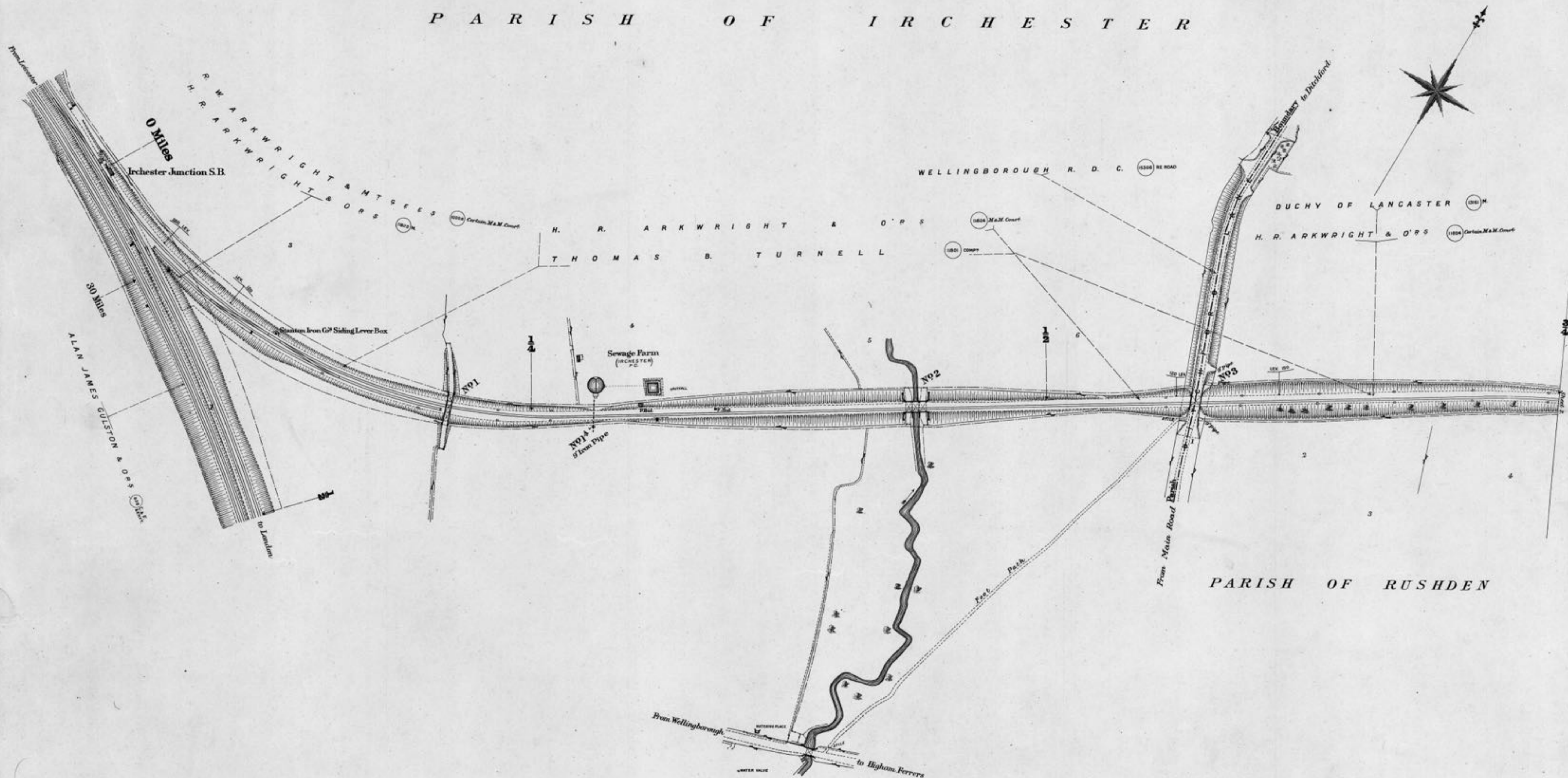

Scale, 2 Chains to an Inch

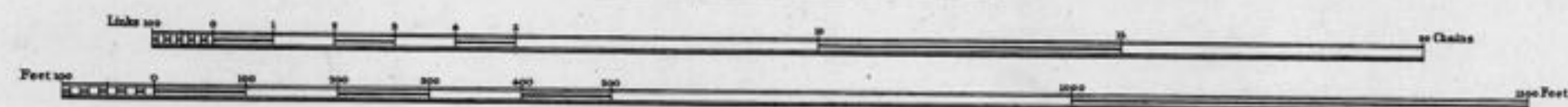

C O U N T Y O F N O R T H A M P T O N

P A R I S H O F R U S H D E N

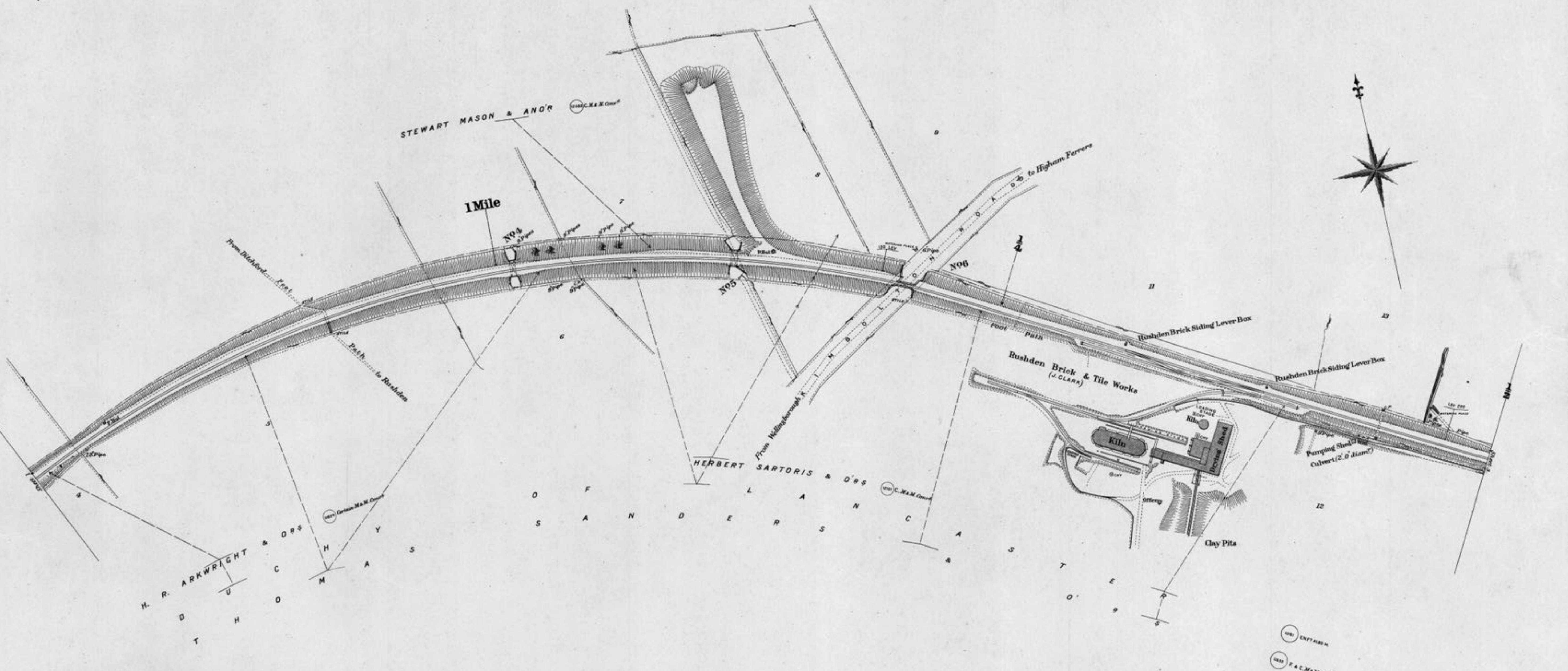

Scale, 2 Chains to an Inch.

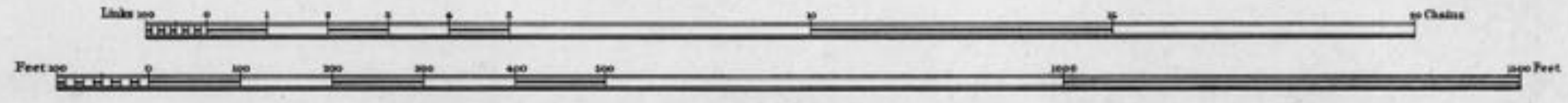

Estate Agents Office,  
Midland Railway,  
Derby.

C O U N T Y       O F       N O R T H A M P T O N

P A R I S H       O F       R U S H D E N

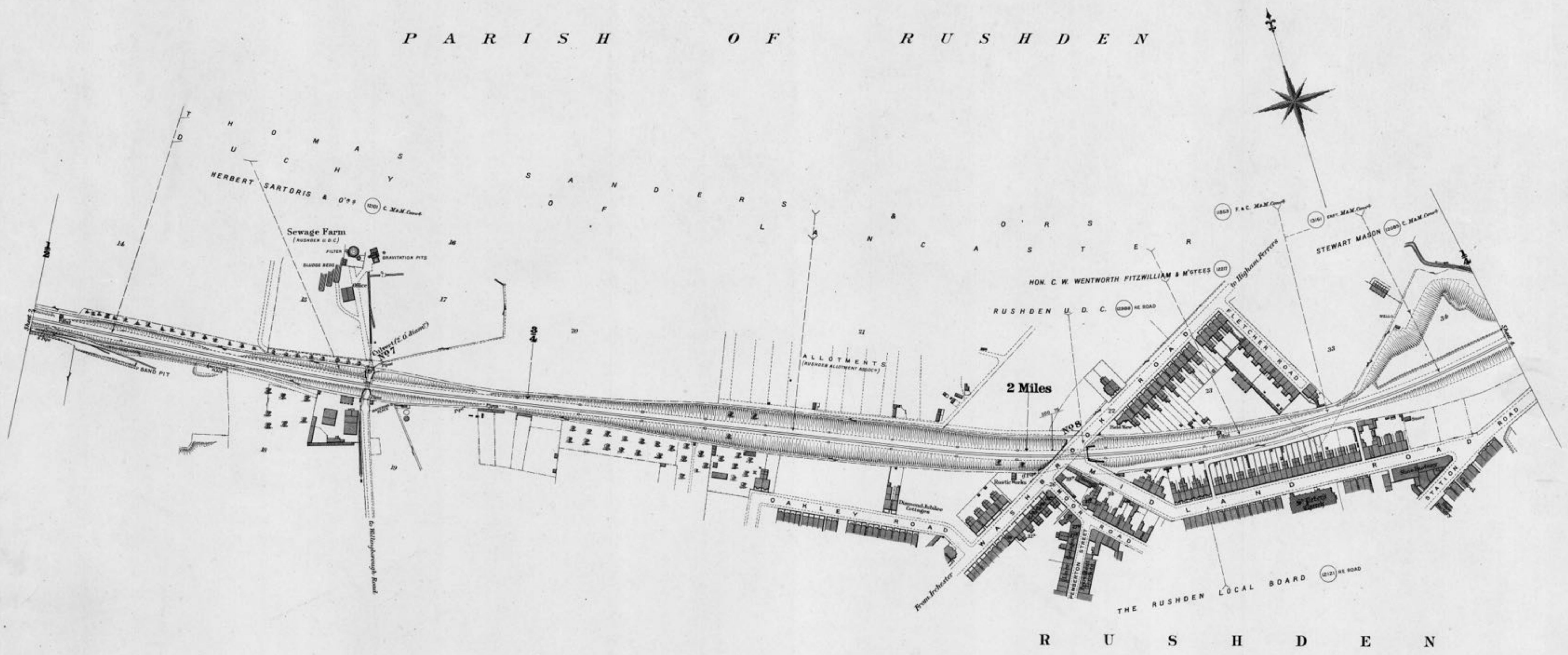

—Scale, 2 Chains to an Inch.—

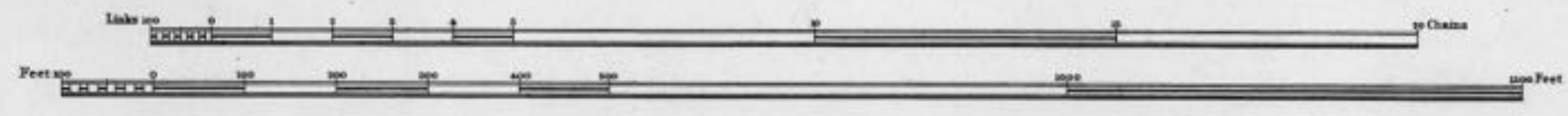

C O U N T Y O F N O R T H A M P T O N

P A R I S H O F R U S H D E N

D  
S  
U  
C  
H  
T  
H  
E  
Y  
W  
A  
R  
O  
F  
L  
A  
N  
C  
A  
S  
T  
E  
R  
N

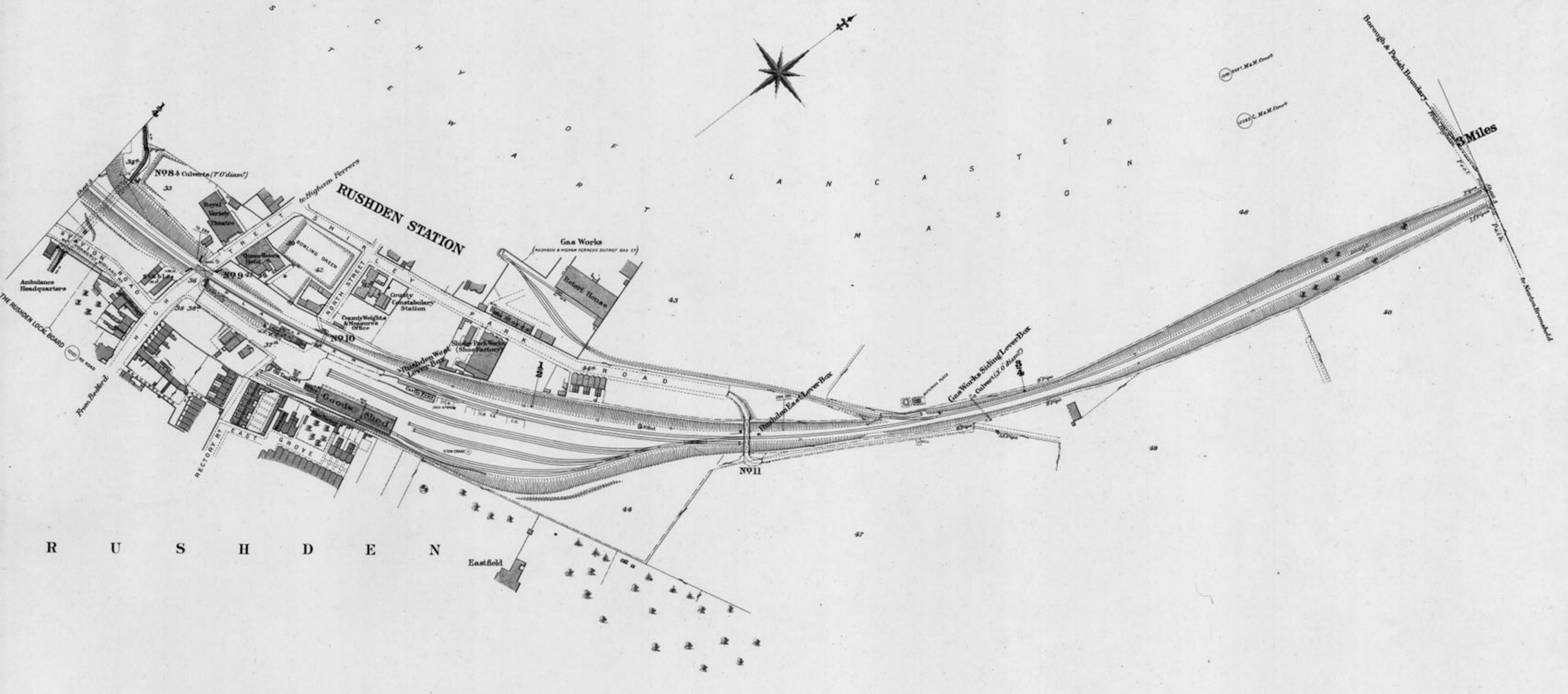

R U S H D E N

Scale. 2 Chains to an Inch.

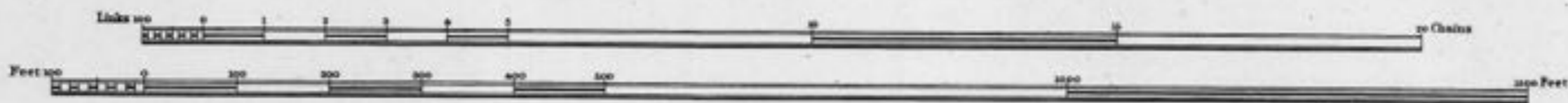

C O U N T Y     O F     N O R T H A M P T O N

B O R O U G H   O F   H I G H A M   F E R R E R S

P A R I S H   O F   H I G H A M   F E R R E R S

H I G H A M   F E R R E R S

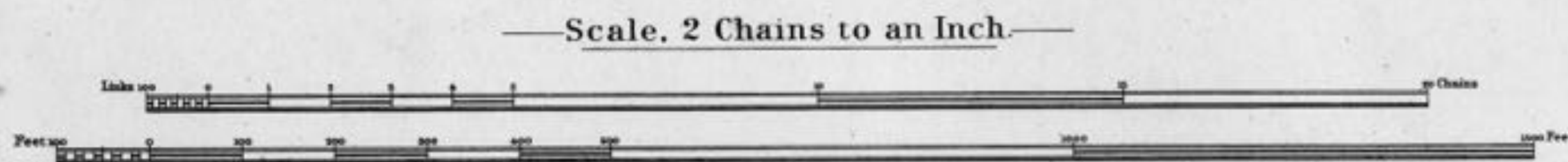
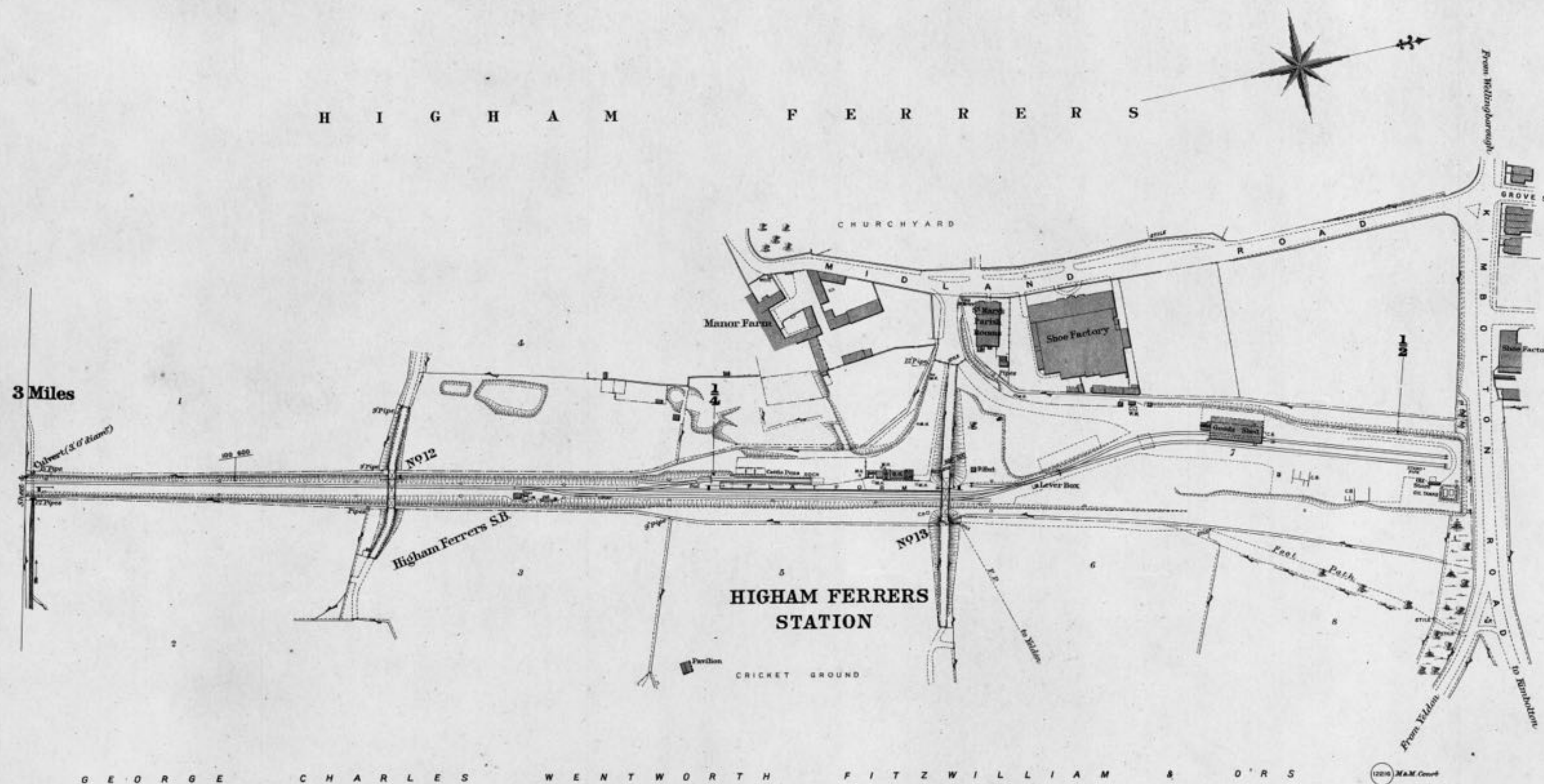

# COUNTY OF NORTHAMPTON

## P A R I S H O F K E T T E R I N G

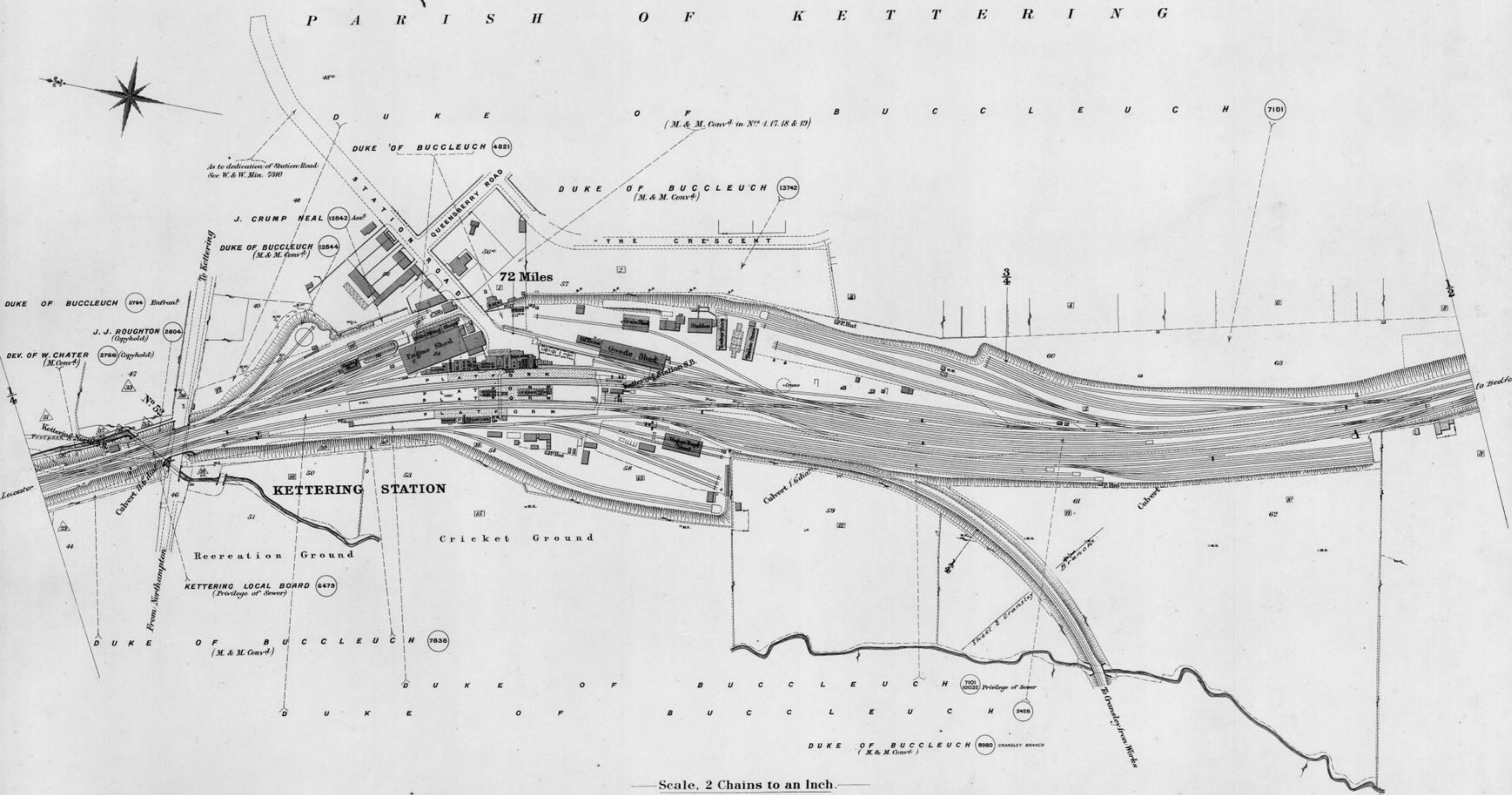

Scale, 2 Chains to an Inch.

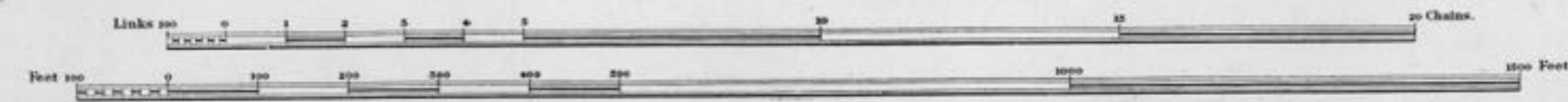

C O U N T Y O F N O R T H A M P T O N

P A R I S H O F K E T T E R I N G

P A R I S H O F B R O U G H T O N

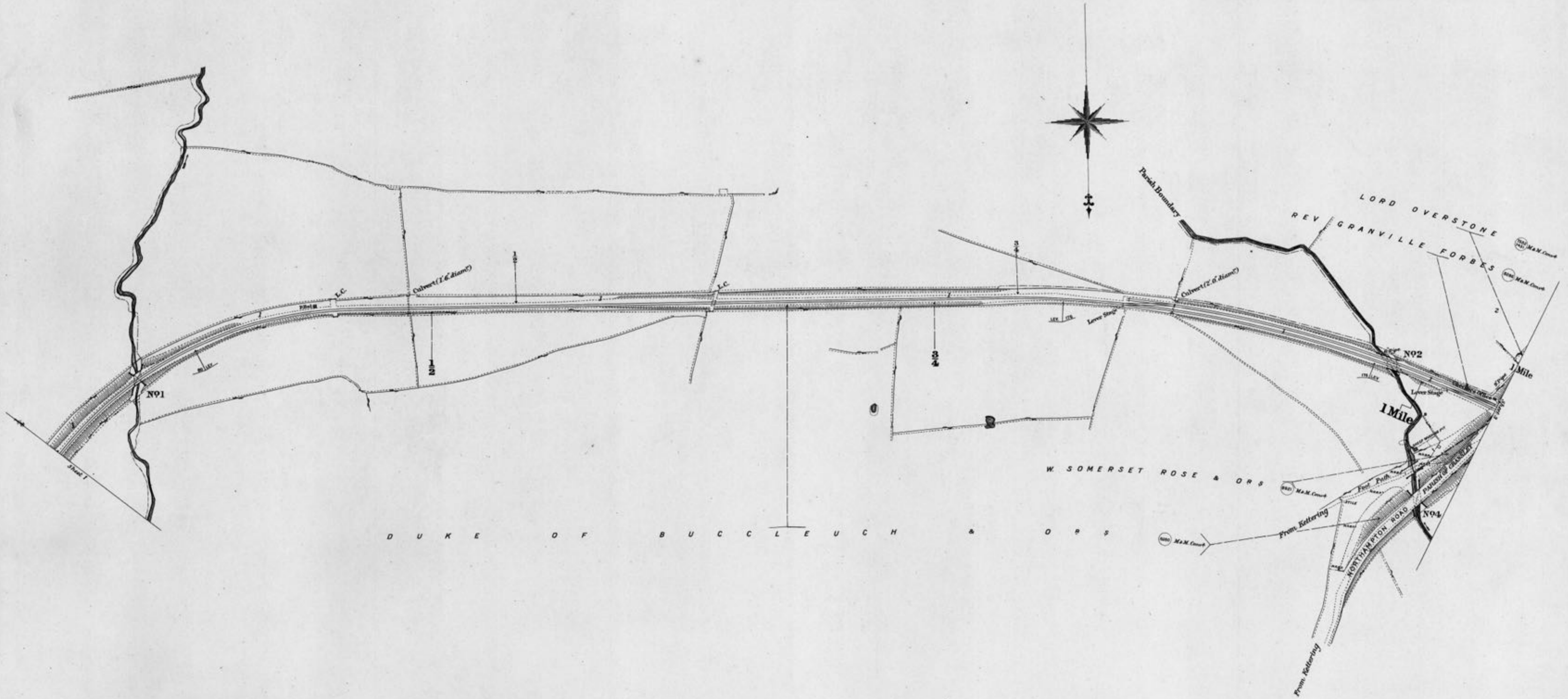

Scale, 2 Chains to an Inch.





# C O U N T Y            O F            N O R T H A M P T O N

## P A R I S H            O F            C R A N S L E Y

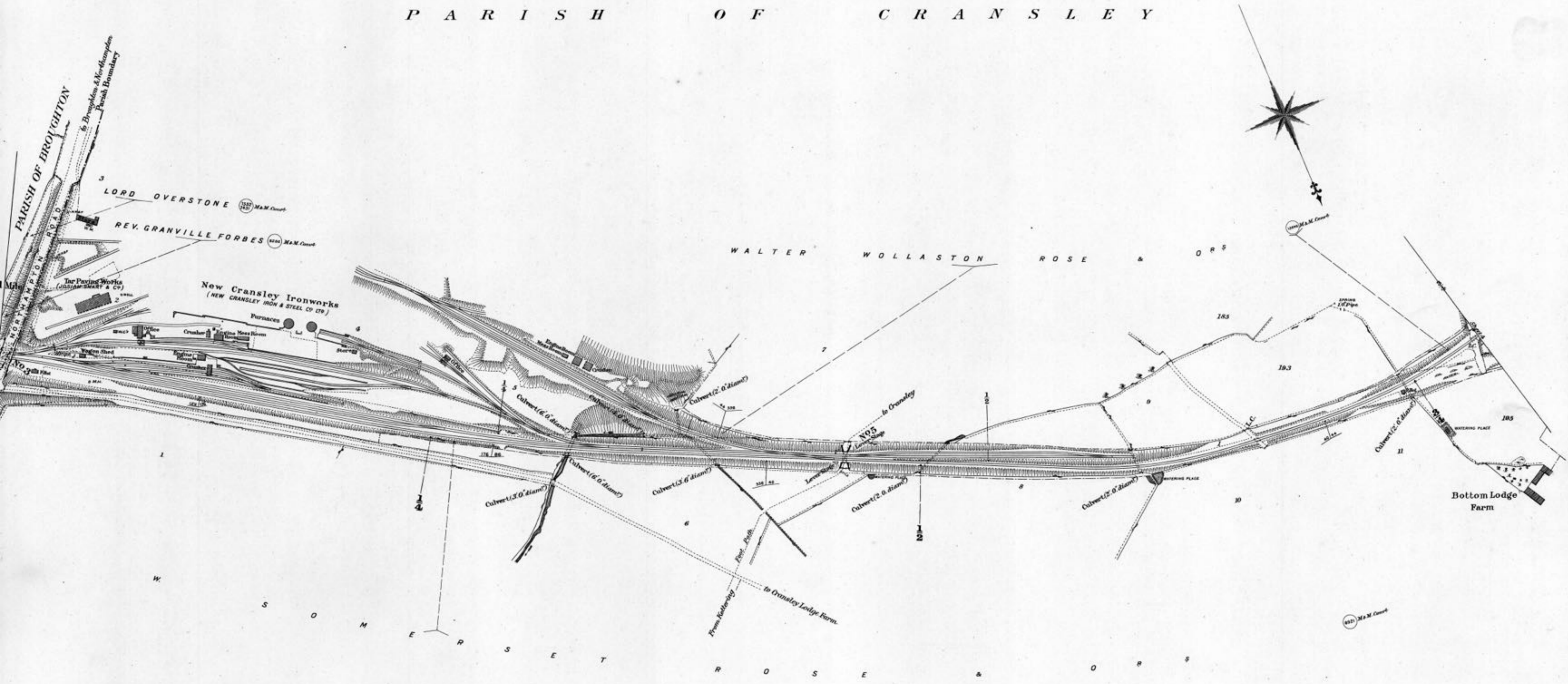

—Scale. 2 Chains to an Inch.—



C O U N T Y            O F            N O R T H A M P T O N

P A R I S H            O F            C R A N S L E Y

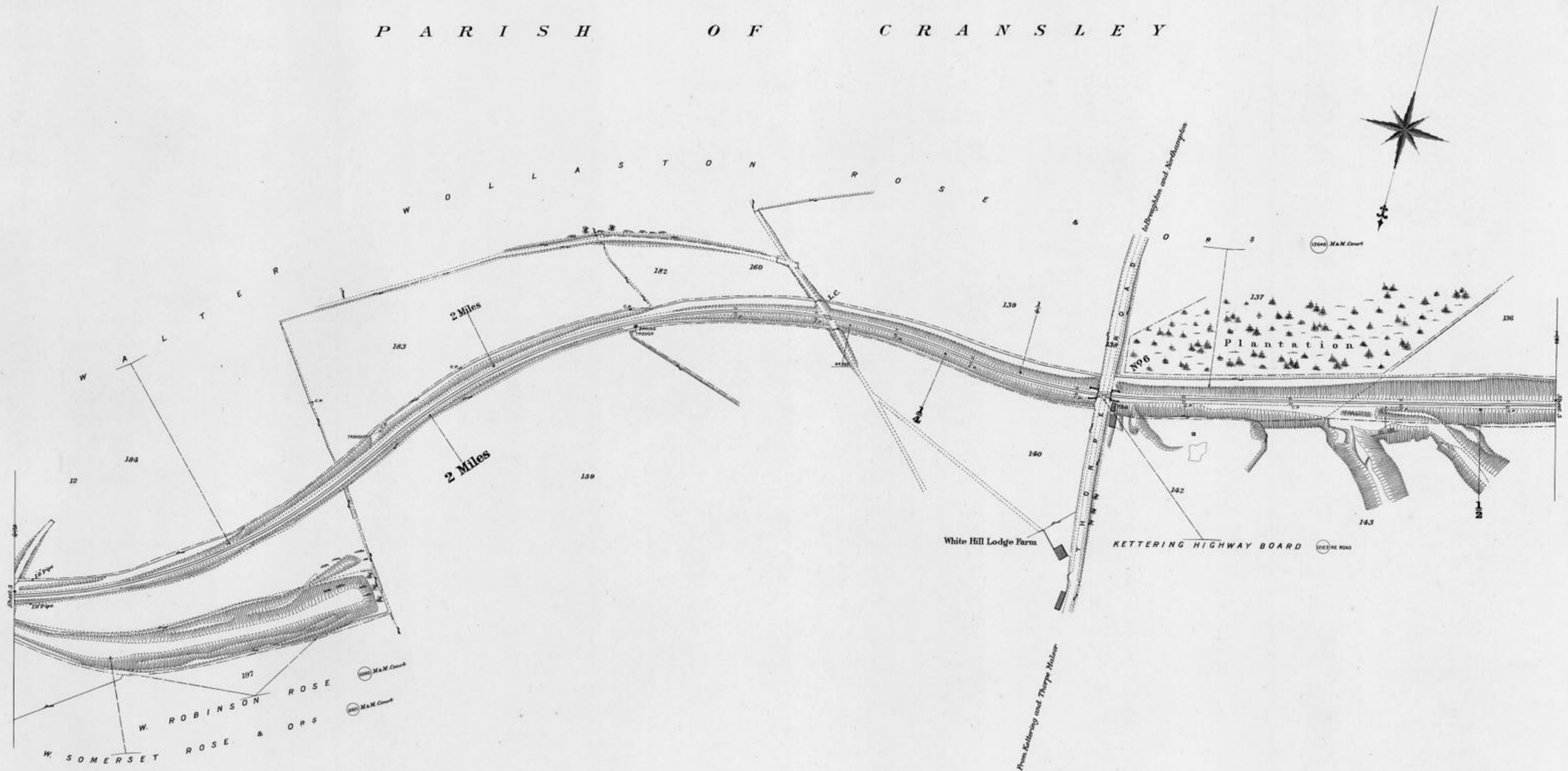

—Scale, 2 Chains to an Inch—

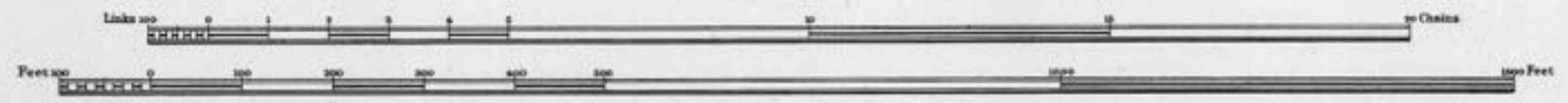

# COUNTY OF NORTHAMPTON

## PARISH OF CRANSLEY

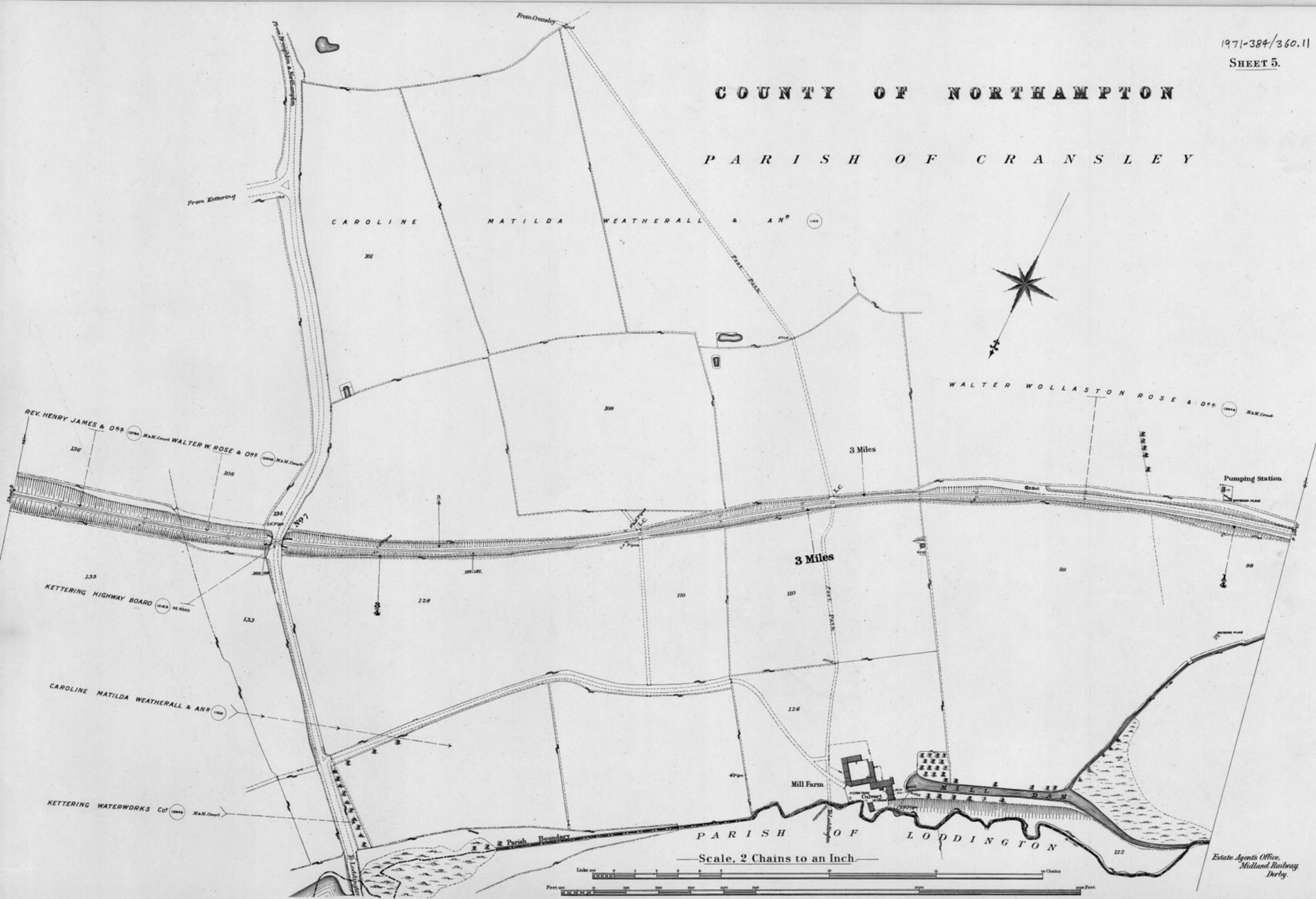

Scale, 2 Chains to an Inch.

Estate Agents Office,  
Midland Railway,  
Derby.

# COUNTY OF NORTHAMPTON

## PARISH OF CRANSLLEY

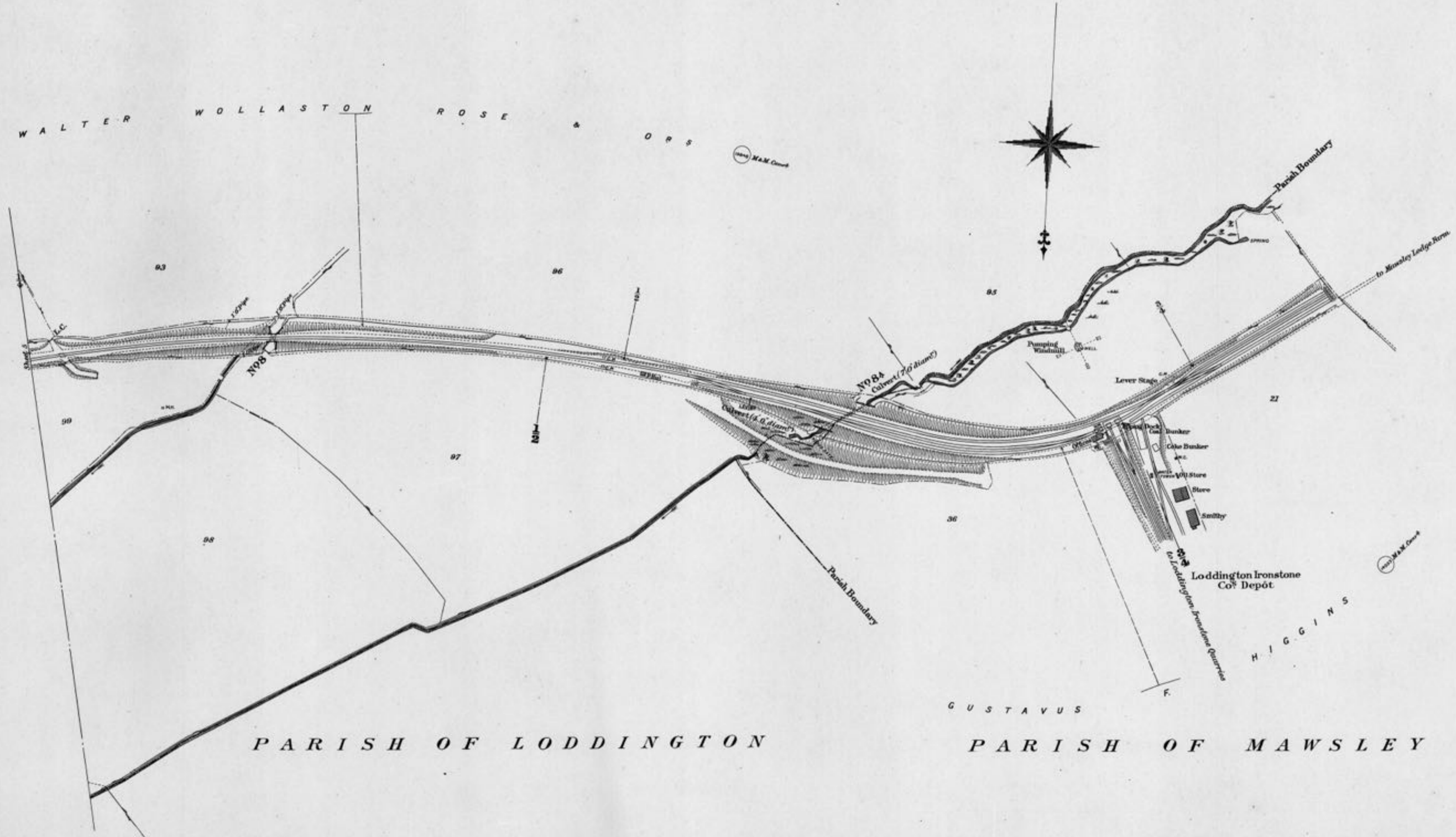

—Scale. 2 Chains to an Inch.—

