

MIDLAND RAILWAY.

WALSALL WOOD BRANCH

AND

EXTENSIONS

LAND PLAN.

Surveyed by
P. S. McCallum,
Estate Agent,
Derby.
 1912.

Reference.

SIGNALS. &c. The Signals are shown as they appear to view

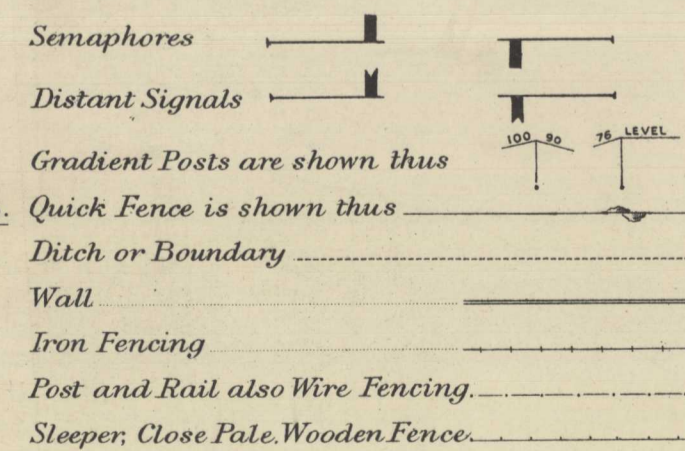

Titles of Acts.

The Midland Railway (New Works, &c.)	Walsall Wood Branch	-	-	-	Act 1876—39&40 Vict., Royal Assent 13th July, 1876.
Do. (Additional Powers)	do. do. (Deviation)	-	-	„ 1878— 41 „	do. 17th June, 1878.
Do. (do. do.)	do. do. (Extensions Nos. 1 and 2)	„	„	1880—43&44 „	do. 6th August, 1880.

COLOURING. The Company's FREEHOLD Property is shown by RED Colour	<input type="checkbox"/>
Do. LEASEHOLD do. RED EDGE ONLY	<input type="checkbox"/>
Property owned JOINTLY with other Companies GREEN Colour	<input type="checkbox"/>
Do. over or through which the Company has an EASEMENT is shown by RED dotted lines.	<input type="checkbox"/>
Do. over or through which the Company has granted an EASEMENT is shown by PURPLE dotted lines.	<input type="checkbox"/>
Do. granted on LEASE by the Company by RED Full lines.	<input type="checkbox"/>
Do. SOLD or otherwise disposed of by the Company is shown by PURPLE colour.	<input type="checkbox"/>
MINERALS specially purchased by the Company shown by BLUE Full lines.	<input type="checkbox"/>
Do. SOLD or otherwise disposed of by the Company shown by PURPLE Full lines.	<input type="checkbox"/>

NOTE.— Vendors' Names are written in block as VENDOR.
 The figures within the circle after the names of the Vendors refer to the numbers on the deeds relating to the purchases, &c. (1214)
 The slanting figures, as 20, refer to Parliamentary numbers (Original Act).
 Do. within a triangle as 20, are the Parliamentary numbers referring to subsequent Acts.

COUNTY OF STAFFORD

P A R I S H O F A L D R I D G E

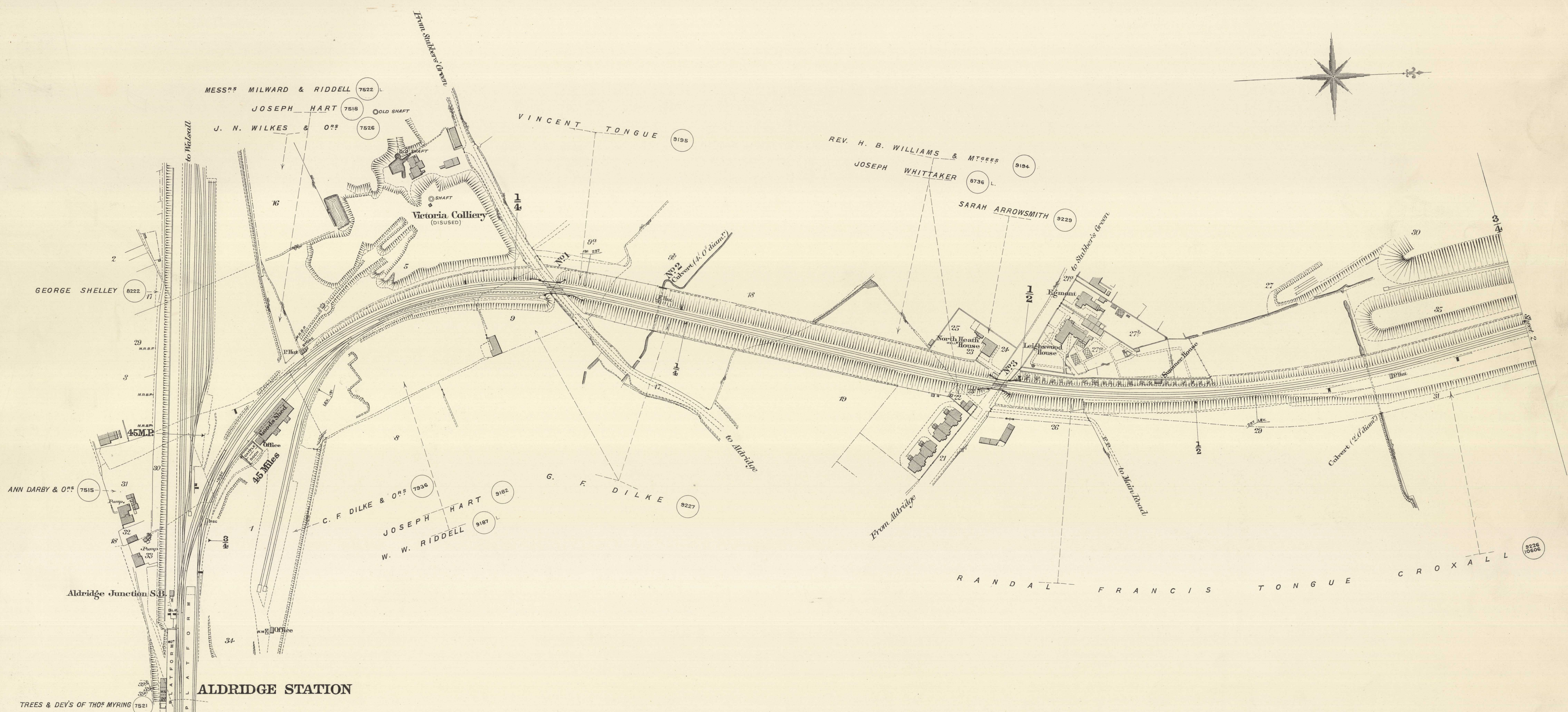
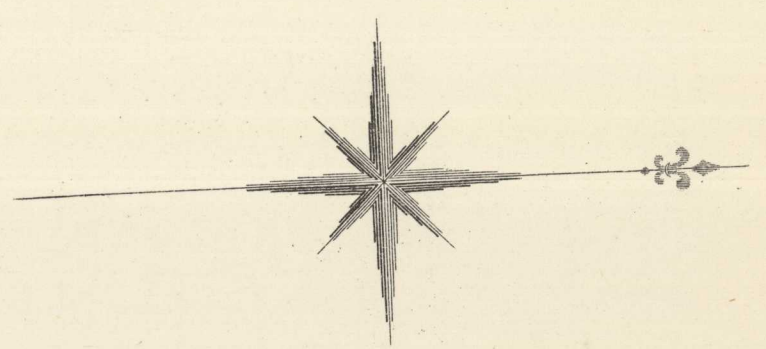

Scale, 2 Chains to an Inch.

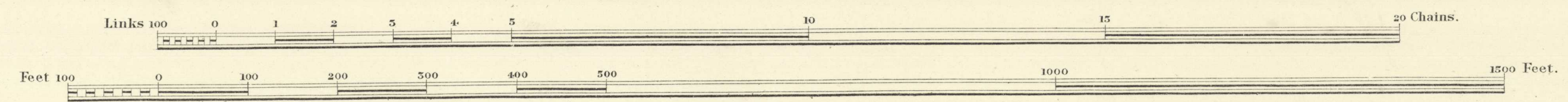

COUNTY OF STAFFORD

PARISH OF ALDRIDGE

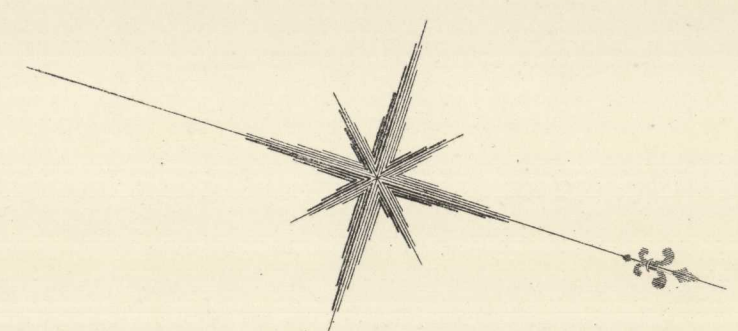

PARISH OF WALSALL WOOD
FORMERLY
PARISH OF WALSALL

Leigh's Wood Colliery

Aldridge Colliery

ALDRIDGE COLLIERY C^o L^{td} (12763) AGT. RE CLAY BETWEEN A & B.

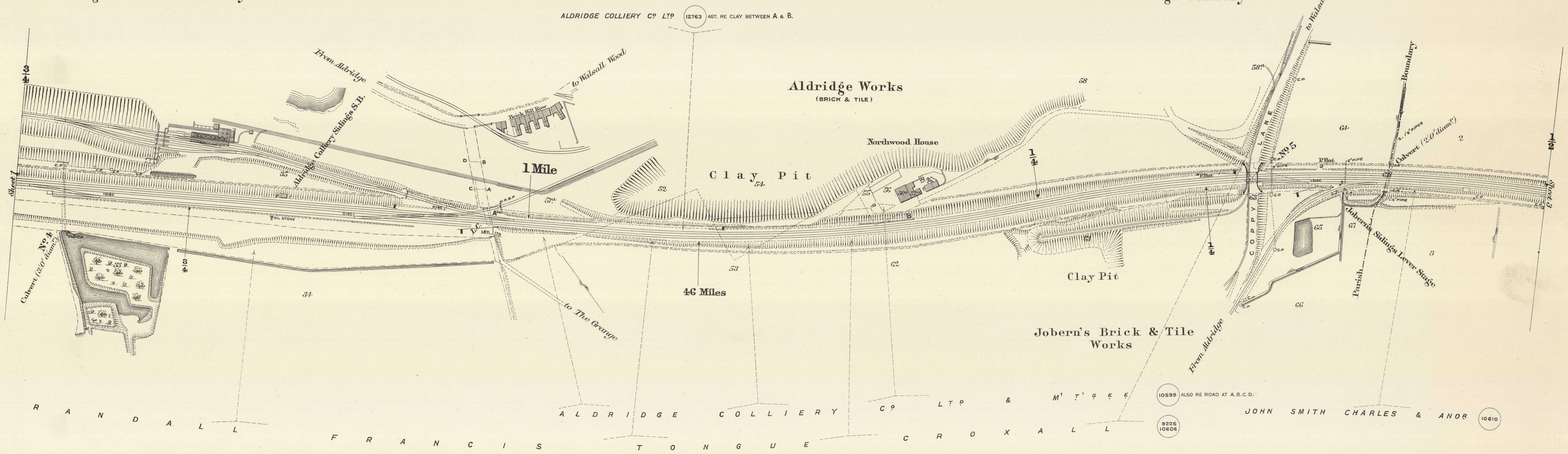

R A N D A L L F R A N C I S A L D R I D G E C O L L I E R Y C^o L^{td} & M^r T^r G E E
JOHN SMITH CHARLES & ANOR

Scale, 2 Chains to an Inch.

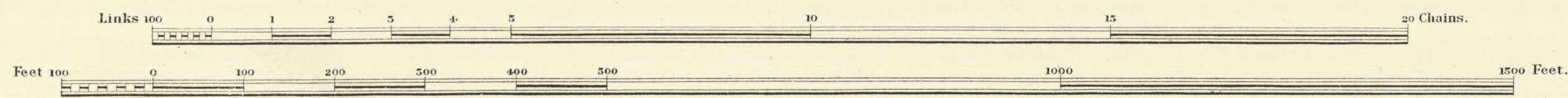

Estate Agents Office,
Midland Railway,
Derby.

COUNTY OF STAFFORD

P A R I S H O F W A L S A L L W O O D

(F O R M E R L Y P A R I S H O F W A L S A L L)

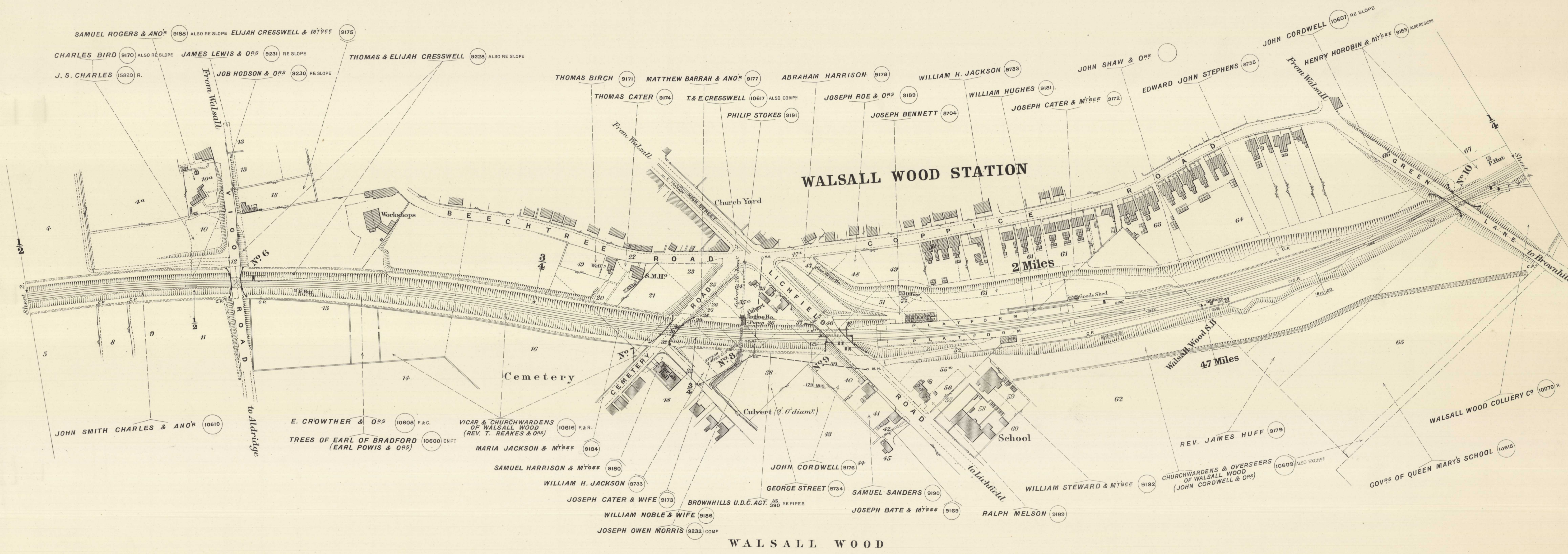
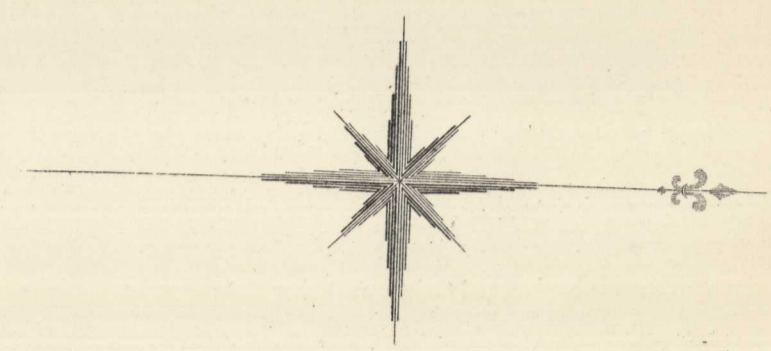

Scale, 2 Chains to an Inch.

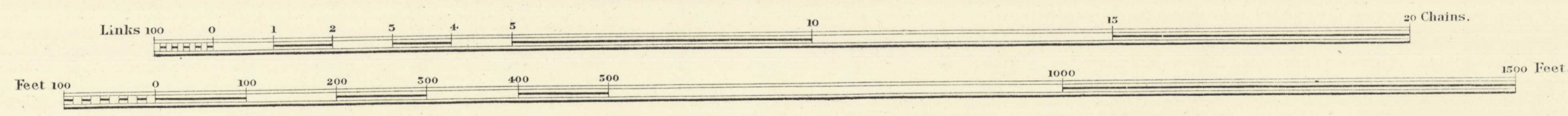

Estate Agents Office,
Midland Railway,
Derby.

COUNTY OF STAFFORD

1971-384/576.5
SHEET 4

PARISH OF WALSALL WOOD

(FORMERLY PARISH OF WALSALL)

PARISH OF NORTON UNDER CANNOCK

(FORMERLY PARISH OF NORTON CANES)

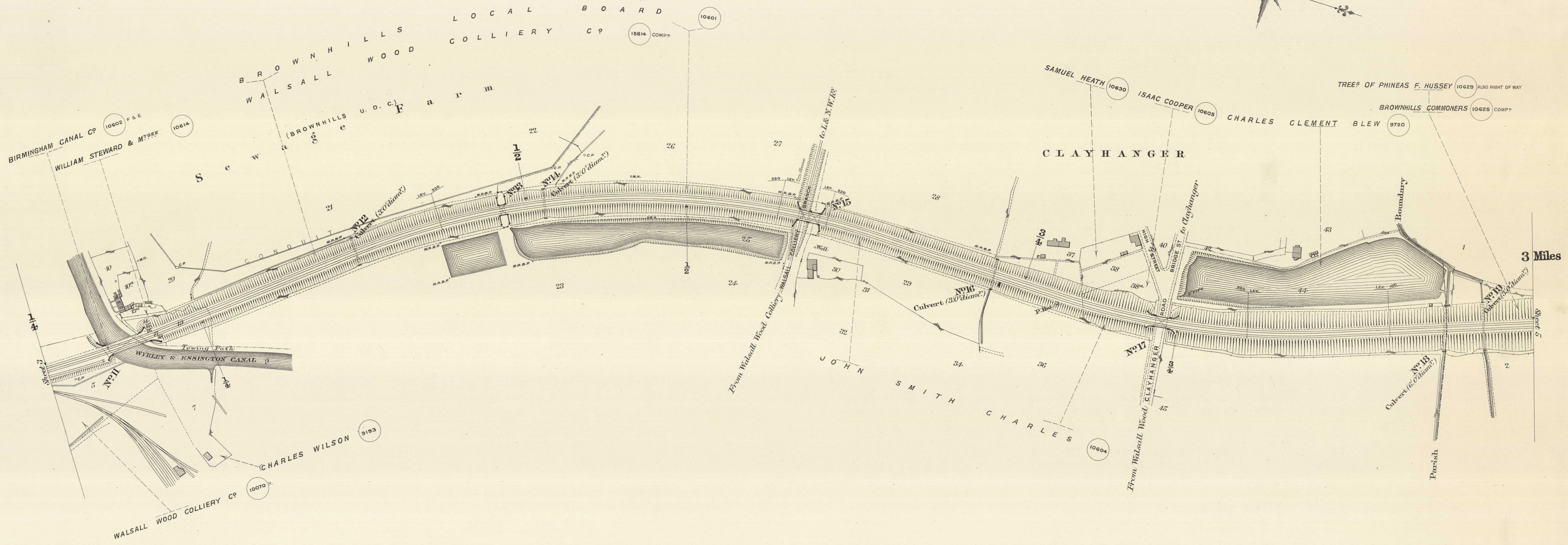
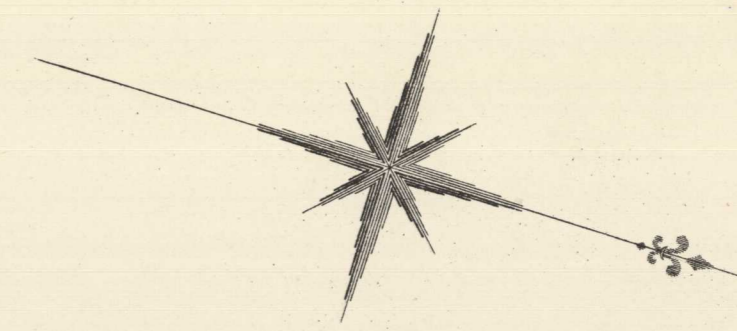

3 Miles

Scale, 2 Chains to an Inch.

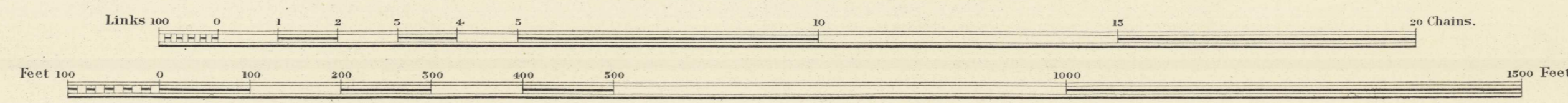

Estate Agents Office,
Midland Railway,
Derby.

COUNTY OF STAFFORD

1971-384/576.6
SHEET 5

PARISH OF NORTON UNDER CANNOCK

(FORMERLY PARISH OF NORTON CANES)

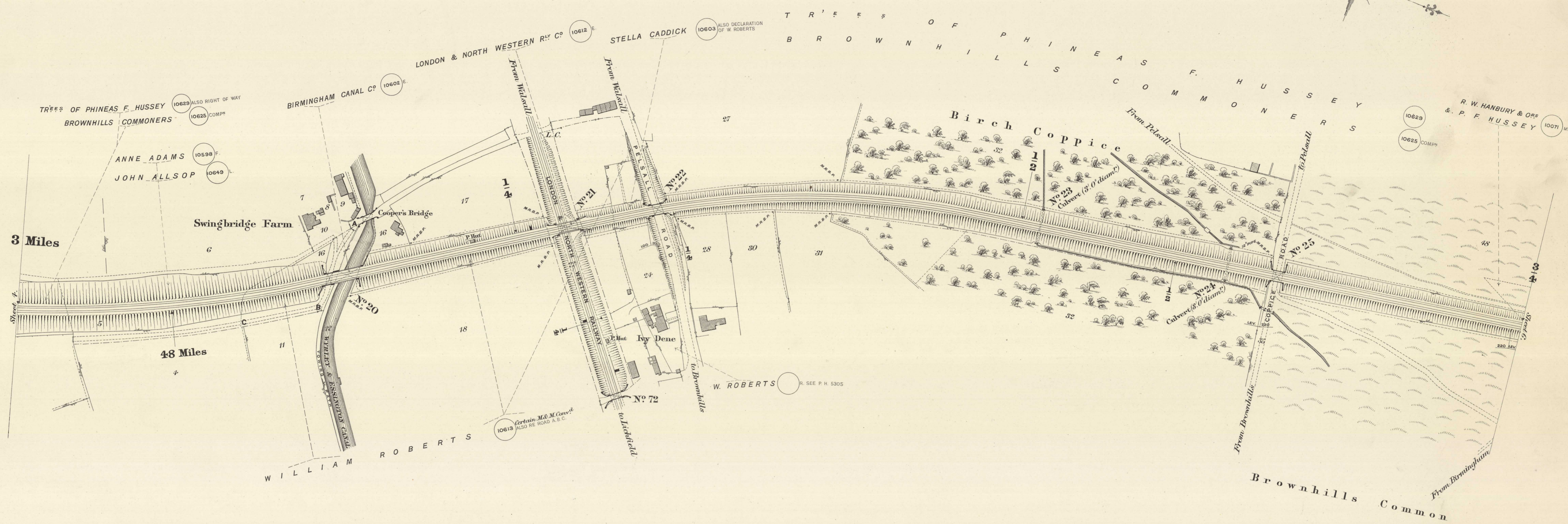
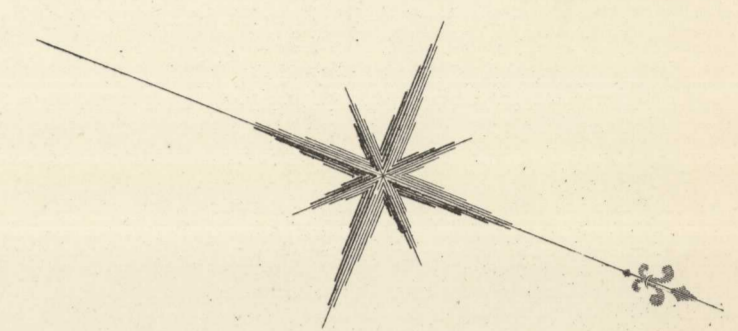

3 Miles

48 Miles

Scale, 2 Chains to an Inch.

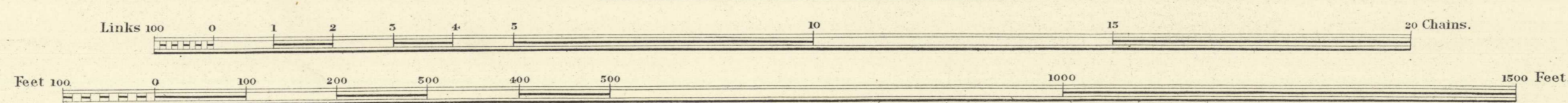

Estate Agents Office,
Midland Railway,
Derby.

COUNTY OF STAFFORD

1971-384/576.7

SHEET 6

PARISH OF NORTON UNDER CANNOCK

(FORMERLY PARISH OF NORTON CANES)

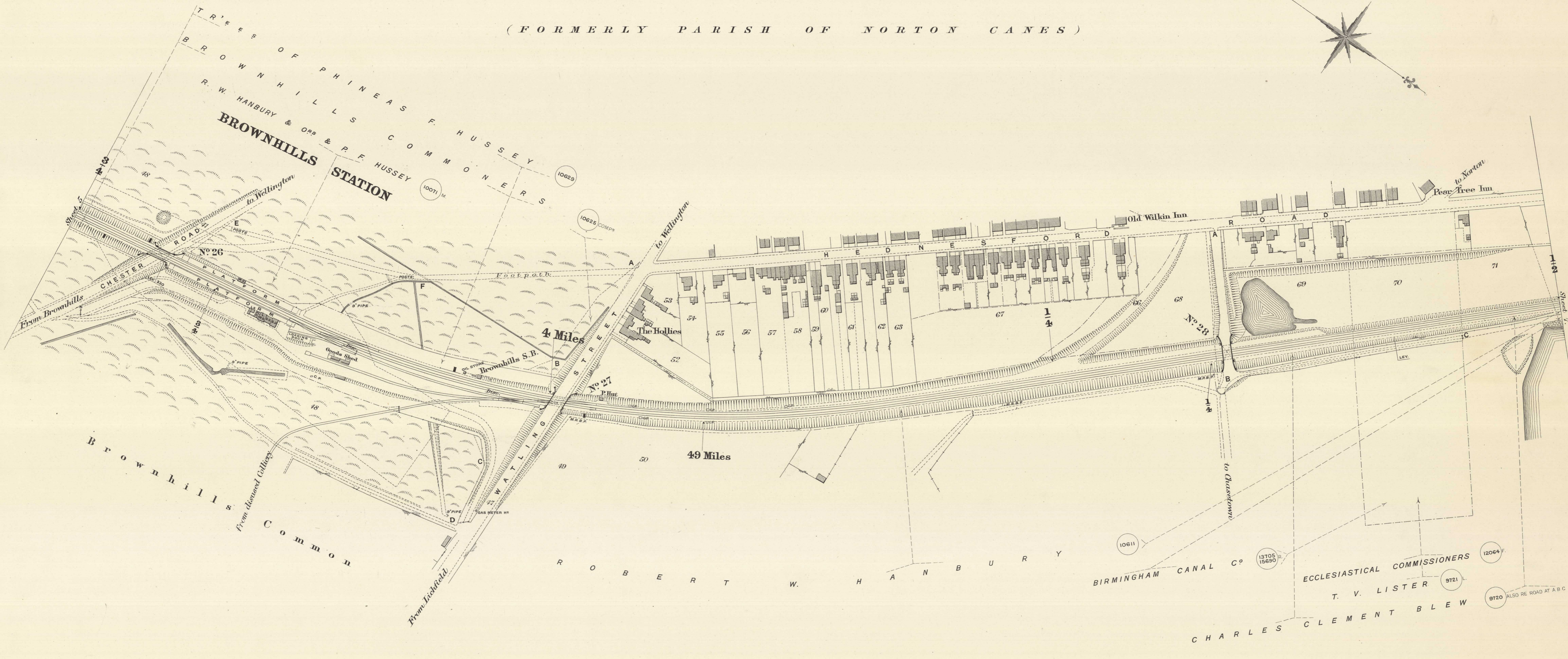
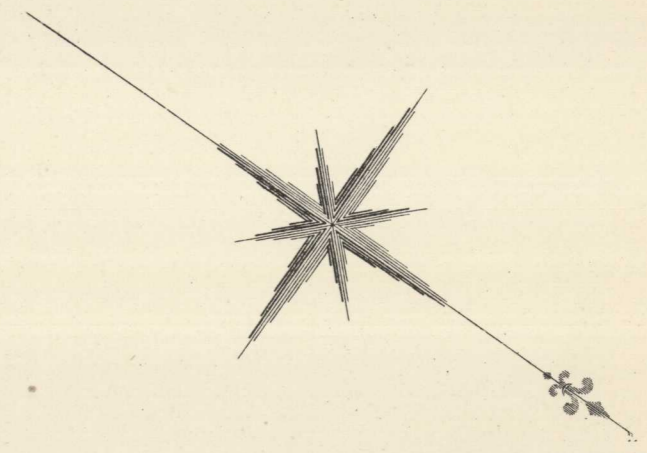

Scale, 2 Chains to an Inch.

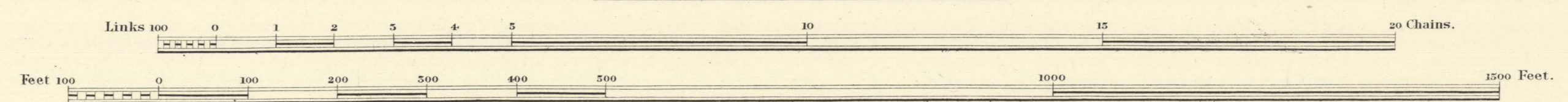

Estate Agents Office,
Midland Railway,
Derby.

COUNTY OF STAFFORD

PARISH OF NORTON UNDER CANNOCK

(FORMERLY PARISH OF NORTON CANES)



Scale, 2 Chains to an Inch.

